

200+ Patent Certificates
\$1,000,000+ Annual Energy Saving
20,000+ Projects Successfully Installed



IL03 LED Street Light

Power: 20W - 230W



Innovative & Tailored
Lighting Solutions for **Success**
www.aokledlight.com

Features of **IL03** Series



For others & details
please request



The IL03 series offers an economically efficient and adaptable street light/area light solution with exceptional cost-effectiveness.

- Power output spans from 20W to 230W.
- Features a sleek fixture body design adhering to industrial-grade standards.
- Utilizes micro-lens systems to generate IESNA Type II, Type III, Type IV, and Type V distributions.
- Ensures 0% total lumens above 90° (BUG Rating, U=0), ensuring uniform light output and reduced glare.
- Optical systems maintain an IP66 rating for durability.
- Includes a designated spot atop the fixture for potential future sensor installation.
- Installation is hassle-free, with simple maintenance requirements.



WARRANTY

5 Year Limited Warranty,
10 Year Preferred Warranty.
Please consult with our sales for detailed agreement.

Benefits for choosing IL03



• Convenient Upgrade

Reserve sensor installation port for easy upgrading.



• Efficient Heat Dissipation

Rear fin-shaped heat sink design, fast convection, excellent heat dissipation, low temperature.



• Solar Power Optional

Support solar power optional configuration, please consult for details.



• Exceptional Impact Resistance

Passed 3G Shock Resistance Test.



• Professional Optic Design

Multiple light distribution options available, professional simulation design.



• Multiple Accessories and Options

Supports accessories and options such as Photocell (Nema), 3pin/7pin bases, ZigBee, LoRa, Zhaga bases, Dali, Casambi, NB-IoT control, and more.

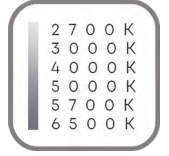

· Dual-layer structure design, enhanced water resistance.



· High quality silicone gasket, improved sealing performance.

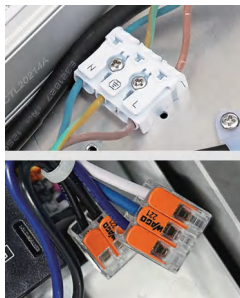

· High-quality terminal wiring ensures reliability and safety. (Optional)



· High-quality AC power interface, safe and reliable. (Optional)

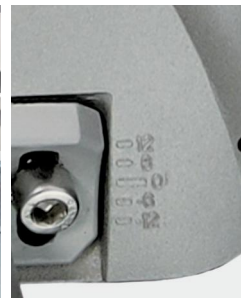

· Adjustable bracket ±12 degrees.



· Reinforced bracket design, increased safety.

wally@aokledlight.com
+1 626-986-4050 (US)
+86 755 2357 9148 (CN)

©2025 AOK Industrial Company Limited. All Right Reserved.



Photometric Design

For the sake of adaptability

- Customizable Light Engines:

Our modules feature premium optical-grade Mitsubishi polycarbonate lenses and an efficient design, enabling highly customizable light engines that precisely direct light distribution for specific applications.

- Versatile Optical Systems:

These systems provide tight cutoffs and flexible control, making them adaptable to a wide range of applications.

- Innovative Lighting Solutions:

We offer innovative, customizable lighting solutions that enhance project flexibility, delivering uniform illumination with minimal glare for superior user comfort and reduced light trespass.



Distribution Type

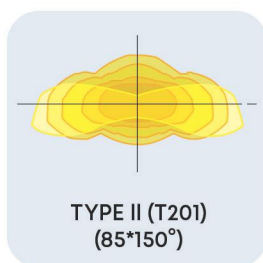

Asymmetric, Type II can be used in long and narrow aisles/lanes/side walks.

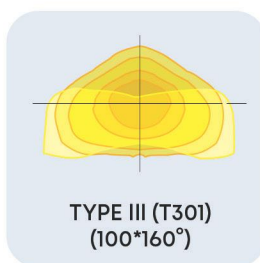

Asymmetric, Type III can be used in wide road parking areas, or at corner areas.

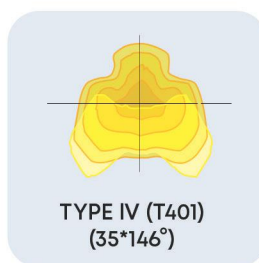

Asymmetric, Type IV can be used in wide road parking areas, or at corner areas.

* Due to working temperature and CCT/CRI adjustments, actual photometric values may vary slightly. Please consult the measured IES file for accurate data. The above information is for reference purposes only.



No photo-biological risk (no risk associated with infrared, blue light, or UV radiation), in compliance with **EN 62471:2008**.

Application Reference

- Road & highway lighting
- Urban road & street lighting
- Residential area lighting
- Parks & perimeter lighting
- Parking lot lighting
- Riverside & jogging track



Smart Control Ready For Efficient Management

IL03 is **connected-ready** and operates with various sensors and control systems.

Typical IoT **Demonstration**

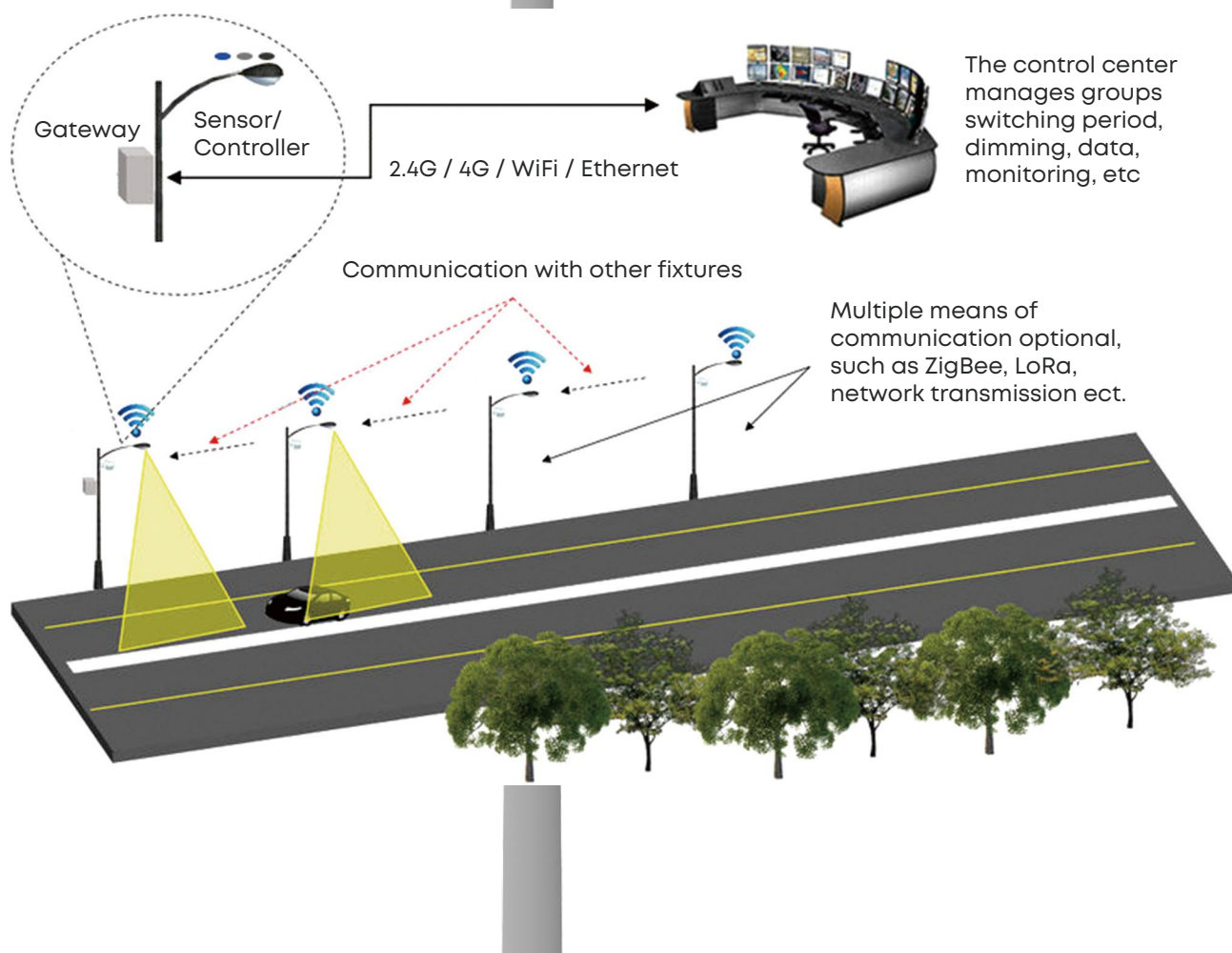

Custom Dimming Profile

Smart luminaire drivers enable the programming of complex dimming profiles without extra wiring. Customized time intervals and light levels contribute to maximum energy savings, maintaining required lighting levels and uniformity throughout the night.

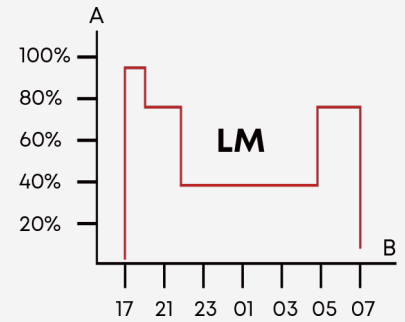

Daylight Sensor / Photocell

Photocell or daylight sensors switch the luminaire on as soon natural light falls to a certain level. It can be programmed to switch on during a storm, on a cloudy day (in critical areas) or only at night-fall so as to provide safety and comfort in public spaces.

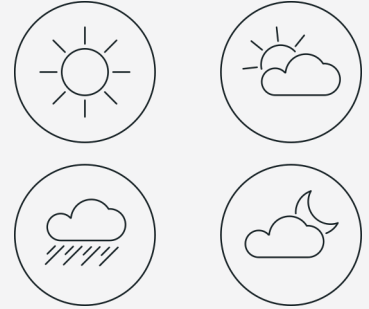

Smart standards. Smarter lighting.

LoRaWAN® Luminaire Controller Zhaga is a wireless device for remote LED luminaire control with a Zhaga-compliant connector and DALI interface. It's compatible with LoRaWAN®, NB-IoT, and LTE-M networks, featuring a modern, compact design suitable for various street lighting modules.

LoRaWAN® Luminaire Controller NEMA is designed for LED luminaires with an ANSI C136.41 NEMA receptacle. It controls the luminaire through DALI or 0-10V analog interfaces and provides a secure power connection with three robust twist lock contacts.

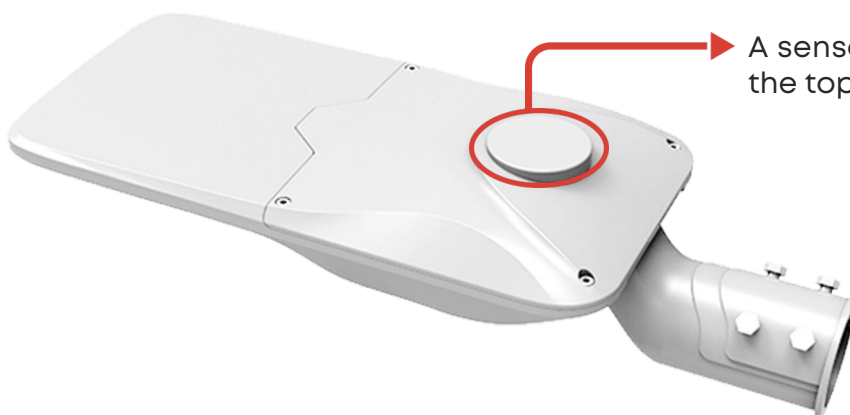

A sensor mounting hole is reserved on the top to facilitate future installation.

Parameter Table

Electrical Data							
Model		AOK-20WiL03	AOK-30WiL03	AOK-50WiL03	AOK-60WiL03	AOK-70WiL03	AOK-80WiL03
Power(W)		20 W	30 W	50 W	60 W	70 W	80 W
Input Voltage	100-277VAC						
THD	<20%						
PF		≥0.95	≥0.95	≥0.95	≥0.98	≥0.98	≥0.98
Driver	Meanwell / Sosen / Philips. Class 1/ Class 2, EU						
Operating Temperature	-40°C to 50°C (-40 °F to 122 °F)						
Storage Temperature	-40°C to 80°C (-40 °F to 176 °F)						
Control Option	Surge Protective Device、Daylight Sensor Control、1-10V Dimming						
Surge Protection	10kV / 20kV optional						
Photometric Data							
Efficacy(lm/W)	T20l(85°150°)	145lm/W	145lm/W	140lm/W	135lm/W	140lm/W	135lm/W
(CRI 70Ra, 5000K)	T30l(100°160°)	145lm/W	145lm/W	140lm/W	135lm/W	140lm/W	135lm/W
(Std Dev ±5%)	T40l(35°146°)	145lm/W	145lm/W	140lm/W	135lm/W	140lm/W	135lm/W
Luminous Flux (lm)	T20l(85°150°)	2900lm	4350lm	7000lm	8100lm	9800lm	10800lm
(CRI 70Ra, 5000K)	T30l(100°160°)	2900lm	4350lm	7000lm	8100lm	9800lm	10800lm
(Std Dev ±5%)	T40l(35°146°)	2900lm	4350lm	7000lm	8100lm	9800lm	10800lm
ULR	= 0%, @ Luminaire inclination 0°						
CCT	2700K, 3000K, 4000K, 5000K, 5700K, 6500K						
CRI	70Ra, 80Ra, 90Ra optional						
Beam Angle	T20l(85°150°)/T30l(100°160°)/T40l(35°146°)						
LED Manufacturer	LUMILEDS						
LED Model	Lumileds 3030						
Working Current of Single LED (mA)	T20l(85°150°)	40mA	60mA	100mA	120mA	90mA	110mA
	T30l(100°160°)	40mA	60mA	100mA	120mA	90mA	110mA
	T40l(35°146°)	40mA	60mA	100mA	120mA	90mA	110mA
Lens	Polycarbonate						
Mechanical Data							
IP/IK	IP66/IK09, according to standard EN 60529 and EN 62262						
Vibration Resistance	3G, conform to standard IEC 68-2-6.						
EPA(SCx)	Front: 1.32ft² (0.122632m²); Side: 0.34ft² (0.031587m²);						
Materials	Heavy-duty die-cast aluminum (EN AC-46100)						
Painting	Black, Silver,Customized color						
Surface Treatment	Anti-UV thermosetting polyester / 80 micron epoxy primer + Anti-UV thermosetting polyester (for extremely corrosive environments).						
Cable	Pre-wired with a 30 cm cable (Other lengths on request)						
Mounting	Side entry						
Others							
Lifespan	L90B10 > 100000hrs, @Ta 25°C						
Warranty	5 years in standard, 10 years optional						
Certification	CE,CB,RoHS, For other certificates please request						
Product Size	551*214*136mm / 21.7*8.43*5.35 inches						
Carton Size	24.21*10.43*8.27" / 615*265*210mm						
Net Weight	3.1kg / 6.83 lbs	3.1kg / 6.83 lbs	3.1kg / 6.83 lbs	3.1kg / 6.83 lbs	3.1kg / 6.83 lbs	3.8kg / 8.38 lbs	
Gross Weight	4.3kg / 9.48 lbs	4.3kg / 9.48 lbs	4.3kg / 9.48 lbs	4.3kg / 9.48 lbs	4.3kg / 9.48 lbs	5kg / 11.02 lbs	
Recommend Installation Height	General 4-12m, based on actual project requirements						
Application Field	Urban and rural street						
Important Note!	The provided information is solely for reference; the official measurement report holds higher authority.						

Electrical Data												
Model	AOK-100WiL03		AOK-120WiL03		AOK-150WiL03		AOK-180WiL03		AOK-200WiL03		AOK-230WiL03	
Power(W)	100 W		120 W		150 W		180 W		200 W		230 W	
Input Voltage	100-277VAC											
THD	<20%											
PF	≥0.98		≥0.98		≥0.98		≥0.98		≥0.98		≥0.98	
Driver	Meanwell / Sosen / Philips. Class 1/ Class 2, EU											
Operating Temperature	-40°C to 50°C (-40 °F to 122 °F)											
Storage Temperature	-40°C to 80°C (-40 °F to 176 °F)											
Control Option	Surge Protective Device、Daylight Sensor Control、1-10V Dimming											
Surge Protection	10kV / 20kV optional											
Photometric Data												
Efficacy(lm/W)	T20l(85°150°)	135lm/W	135lm/W	135lm/W	135lm/W	140lm/W	135lm/W	135lm/W				
(CRI 70Ra, 5000K)	T30l(100°160°)	135lm/W	135lm/W	135lm/W	135lm/W	140lm/W	135lm/W	135lm/W				
(Std Dev ±5%)	T40l(35°146°)	135lm/W	135lm/W	135lm/W	135lm/W	140lm/W	135lm/W	135lm/W				
Luminous Flux (lm)	T20l(85°150°)	13500lm	16200lm	20250lm	20250lm	25200lm	27000lm	31050lm				
(CRI 70Ra, 5000K)	T30l(100°160°)	13500lm	16200lm	20250lm	20250lm	25200lm	27000lm	31050lm				
(Std Dev ±5%)	T40l(35°146°)	13500lm	16200lm	20250lm	20250lm	25200lm	27000lm	31050lm				
ULR	= 0%, @ Luminaire inclination 0°											
CCT	2700K, 3000K, 4000K, 5000K, 5700K, 6500K											
CRI	70Ra, 80Ra, 90Ra optional											
Beam Angle	T20l(85°150°)/T30l(100°160°)/T40l(35°146°)											
LED Manufacturer	LUMILEDS											
LED Model	Lumileds 3030											
Working Current of Single LED (mA)	T20l(85°150°)	135mA	115mA	145mA	120mA	135mA	135mA	150mA				
	T30l(100°160°)	135mA	115mA	145mA	120mA	135mA	135mA	150mA				
	T40l(35°146°)	135mA	115mA	145mA	120mA	135mA	135mA	150mA				
Lens	Polycarbonate											
Mechanical Data												
IP/IK	IP66/IK09, according to standard EN 60529 and EN 62262											
Vibration Resistance	3G, conform to standard IEC 68-2-6.											
EPA(SCx)	Front: 1.32ft² (0.122632m²); Side: 0.34ft² (0.031587m²);											
	Front: 1.77ft² (0.164438m²); Side: 0.37ft² (0.034374m²);											
	Front: 2.15ft² (0.2m²); Side: 0.44ft² (0.0413m²);											
Materials	Heavy-duty die-cast aluminum (EN AC-46100)											
Painting	Black, Silver,Customized color											
Surface Treatment	Anti-UV thermosetting polyester / 80 micron epoxy primer + Anti-UV thermosetting polyester (for extremely corrosive environments).											
Cable	Pre-wired with a 30 cm cable (Other lengths on request)											
Mounting	Side entry											
Others												
Lifespan	L90B10 > 100000hrs, @Ta 25°C											
Warranty	5 years in standard, 10 years optional											
Certification	CE,CB,RoHS, For other certificates please request											
Product Size	551*214*136mm / 21.7*8.43*5.35 inches		621*254*136mm / 24.45*10*5.35 inches			756*308*138mm / 29.76*12.13*5.43 inches						
Carton Size	615*265*210mm / 24.2*10.43*8.27 inches		685*305*210mm / 26.97*12*8.27 inches			825*360*205mm / 32.48*14.17*8.07 inches						
Net Weight	3.8kg / 8.38 lbs		4kg / 8.82 lbs		4kg / 8.82 lbs		5.6kg / 12.35 lbs		5.6kg / 12.35 lbs		5.6kg / 12.35 lbs	
Gross Weight	5kg / 11.02 lbs		5.5kg / 12.13 lbs		5.5kg / 12.13 lbs		6.9kg / 15.21 lbs		6.9kg / 15.21 lbs		6.9kg / 15.21 lbs	
Recommend Installation Height	General 4-12m, based on actual project requirements											
Application Field	Urban and rural street											
Important Note!	The provided information is solely for reference; the official measurement report holds higher authority.											

Ordering Information

AOK								
WATTS	VOLTAGE	LED CHIPS	TYPE OF SENSOR	CCT&CRI	DISTRIBUTION	MOUNT	HOUSING	OPTIONS
20WiLO3	NV=100-277V	L3=LUMILEDS 3030	00=Without Sensor	2770=2700K 70CRI	T201 (85°150°)	A=Side Entry	SG=Silver Gray	10KV SPD
30WiLO3			PH=Photocell	3070=3000K 70CRI	T301 (100°160°)		BK=Black	20KV SPD
50WiLO3			DV=Dimmable	4070=4000K 70CRI	T401 (35°146°)			
60WiLO3				5070=5000K 70CRI				
70WiLO3				5770=5700K 70CRI				
80WiLO3				6570=6500K 70CRI				
100WiLO3				2780=2700K 80CRI				
120WiLO3				3080=3000K 80CRI				
150WiLO3				4080=4000K 80CRI				
180WiLO3				5080=5000K 80CRI				
200WiLO3				5780=5700K 80CRI				
230WiLO3				6580=6500K 80CRI				

Illuminance Diagram

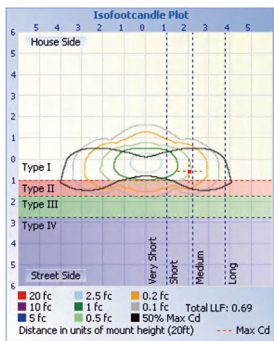

T201 (85°150°)

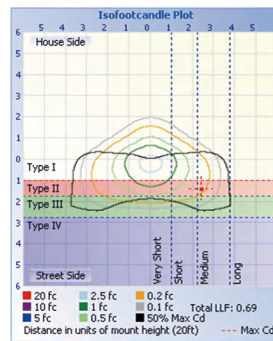
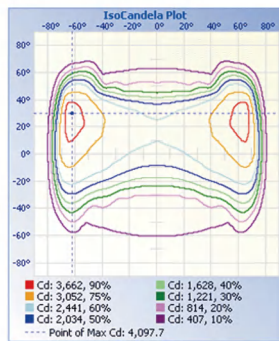

T301 (100°160°)

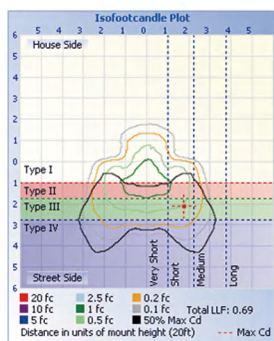
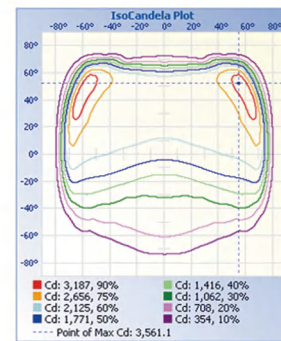

T401 (35°146°)

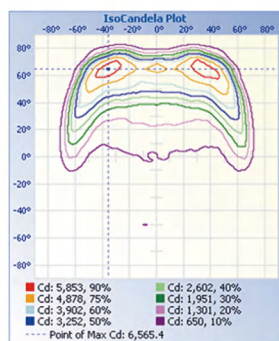

Accessories



Photocell



Shorting Cap



3 Pin/7 Pin Receptacle



*As the products are upgraded, the accessories may differ from those described in the pictures. Please consult with our sales team for updated details and order separately.

Construction Features

Electrical

- Driver Efficiency: >86%~>93%; Maximum Current: AC0.22 A (max)~AC2.5 A (max)
- 1-10V/ PWM/ Timer dimming, 3 Timer Modes, Dim-to-Off with standby power $\leq 0.5W$.
- Constant current Class I driver, 100-277Vac, 50-60Hz, Class II optional.
- High efficiency driver: PF>0.95, driver efficiency >92%.
- Input Surge Protection: 6kV line-line, 10kV line-earth, 20KV SPD available.
- Operating temperature rating: $-40^{\circ}F$ to $122^{\circ}F$ ($-40^{\circ}C$ to $50^{\circ}C$).
- Compatible with DALI, Zhaga / Nema standards, Presence detection sensor.

Construction

- Robust die-cast aluminum housing.
- UV stabilized polyester powder paint finish for durability and corrosion resistance.
- Side entry installation.
- Uniform luminous flux and low glare design.
- IP66 & IK09.
- 3G vibration rating.

Dimension



20W-100W

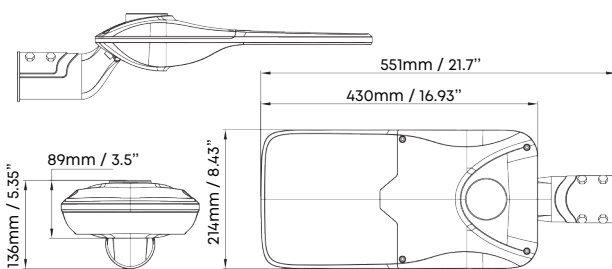

120W-150W

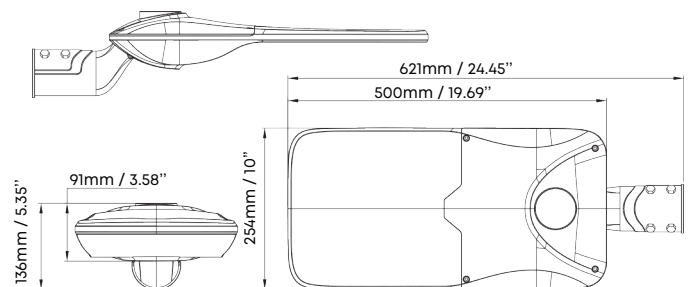

180W-230W

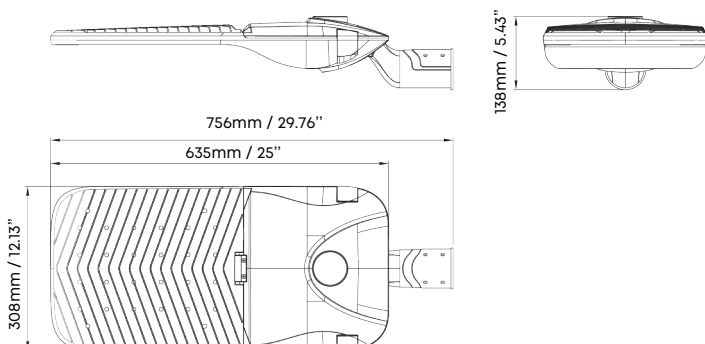



Innovative & Tailored Lighting Solutions for **Success**



5 Year Limited Warranty,
10 Year Preferred Warranty.
Please consult with our sales for detailed agreement.

wally@aokledlight.com
www.aokledlight.com
+1 626-986-4050 (US)
+86 755 2357 9148 (CN)

Manufacturing:

Shenzhen:

Building 1 & 4, St. George's Science and Technology Industrial Park, Shajing Street, Shenzhen, China, 518124.

Huizhou:

Building 2, Yinghui Electronic Science and Tech Park, No. 6 Dongsheng North Rd, Chenjiang Street, Zhongkai High-tech Zone, Huizhou, China. 516006.

Philippines:

128 North Science Avenue SEZ Laguna Technopark, Binan City, Laguna, Philippines.

Fuzhou Office:

Room 301, Yujing Business Center Zone 1, No. 12 Baihuazhou road, Cangshan district, Fuzhou, China, 350007

Copyright ©2025 AOK Industrial Company Limited. All Right Reserved.