

# EDJ1C Motorized Projector Lift EDJ1C

Check the inventory

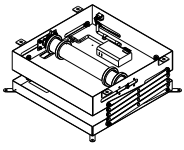

Main body

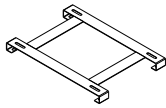

Top plate

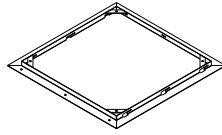

Ceiling panel

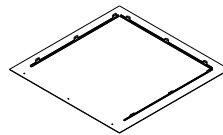

600\*600 bottom panel

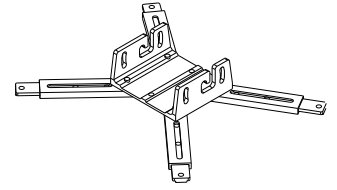

U-type projector claw module

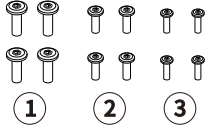

- ① 4-6\*25 internal hexagonal flat round head screw
- ② 4-5\*20 internal hexagonal flat round head screw
- ③ 4-4\*20 internal hexagonal flat round head screw

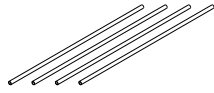

4-M8 screw



1-motor stroke adjusting stick

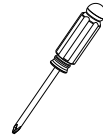

Cross screwdriver

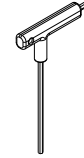

Internal hexagonal screwdriver



Compressed spring



4-M10\*20 cross flat-head screw

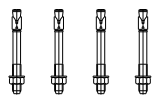

4-8\*80 expansion bolt



Hexagonal nut



Flat gasket



3-M3\*10 cross flat-head screw

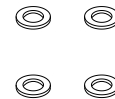

4-PA gasket

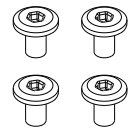

M6\*10 internal hexagonal flat round head screw

## Installation

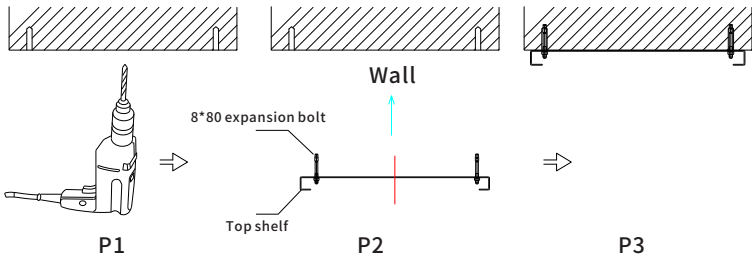

P1

P2

P3

Drill holes at preset places with 10mm drill bit, and install top plate on the wall with 8\*80 expansion bolts.

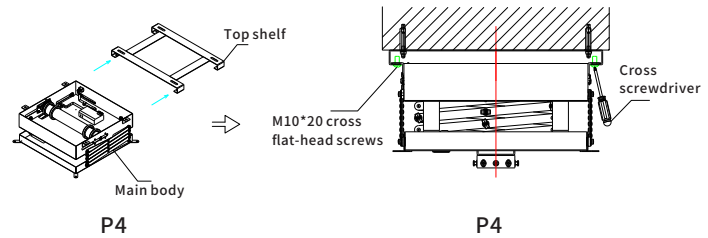

P4

P4

Install the main body on the top plate and fix it with M10\*20 cross flat-head screws.

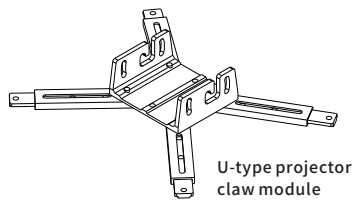

P6

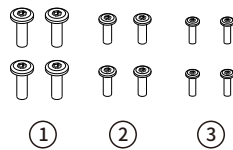

- ① 4-6\*25 internal hexagonal flat round head screw
- ② 4-5\*20 internal hexagonal flat round head screw
- ③ 4-4\*20 internal hexagonal flat round head screw

P7

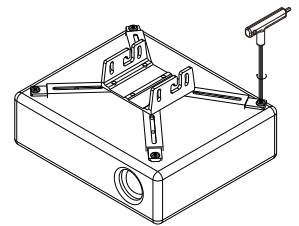

P8

According to actual situations to use different screws to connect the U-type projector claw module with the projector.

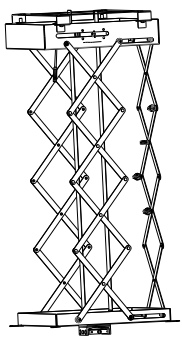

P9

Press the button "DOWN", the projector lift descends.

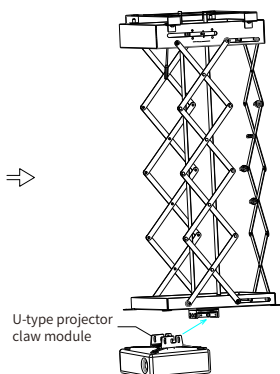

P10

Install the projector

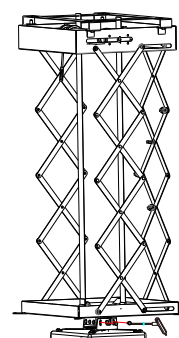

P11

Tighten the screws

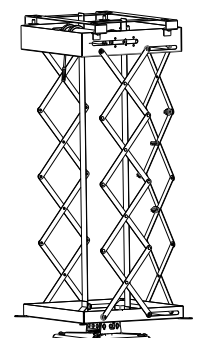

P12

Projector installation completed

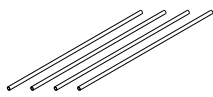

P13

4-M8 screw



P14

Compressed spring



P15

Hexagonal nut



P16

Flat gasket

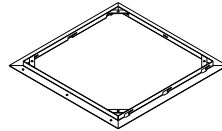

P17

Ceiling panel

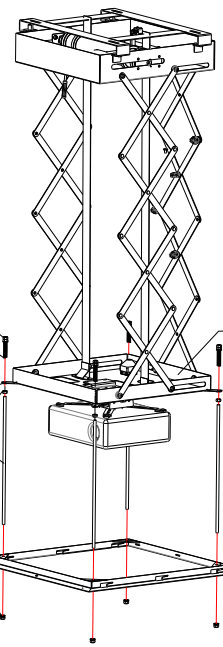

P18

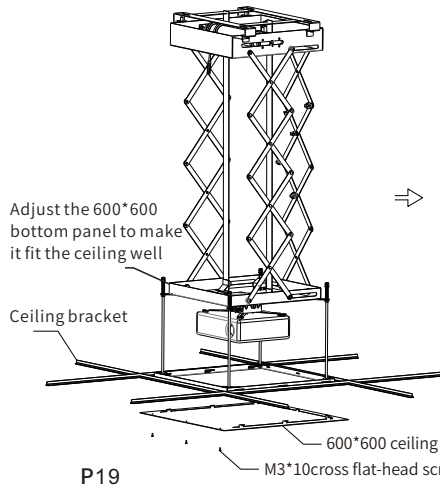

P19

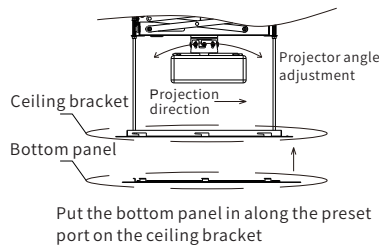

P20

Put the bottom panel in along the preset port on the ceiling bracket

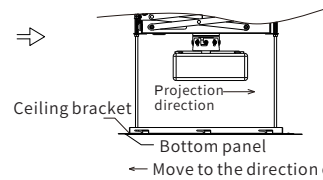

P21

Slide the bottom panel in along the preset slot on the ceiling bracket

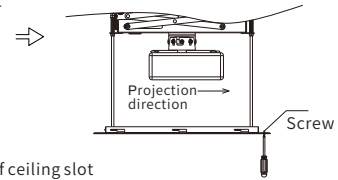

P22

Tighten screws

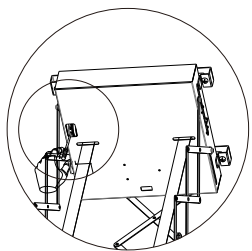

P23

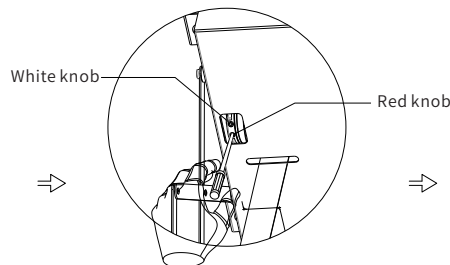

P24

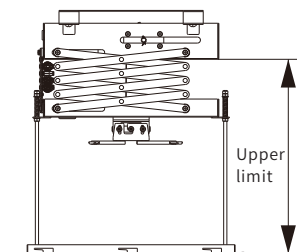

P25

Lower limit

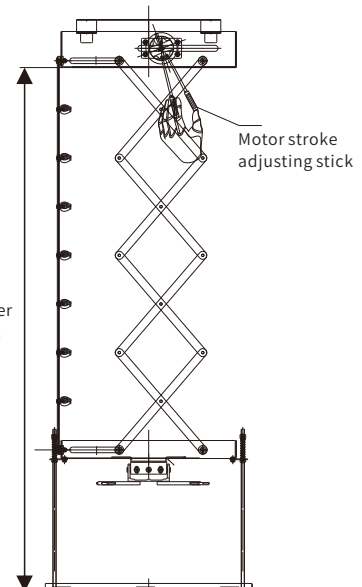

P26

Adjust the upper limit and lower limit with the motor stroke adjusting stick.

- 1.The red knob is the adjustment hole of the upper limit: rotate counterclockwise to reduce the upper limit stroke, rotate clockwise to increase the upper limit stroke.
- 2.The white knob is the adjustment hole of the lower limit: rotate counterclockwise to increase the lower limit stroke, rotate clockwise to reduce the lower limit stroke.