

INSTALLATION AND OPERATION MANUAL OF ELECTRIC PROJECTION SCREEN

Suitable for iron shell



Content

| | |
|--|----|
| General situation | 4 |
| Installation | 06 |
| Safety description | 06 |
| Check the list of items | 07 |
| Wall mounting mode | 08 |
| Top mounting mode | 09 |
| Hanging mounting mode | 10 |
| Use | 11 |
| Electric screen using method | 11 |
| Remote control | 12 |
| Remote control description | 12 |
| Coding step | 14 |
| Failures and warranty | 15 |
| Identification and elimination of faults | 15 |

General situation

Business/Teaching/Engineering/Field



Gorgeous

The designer has added the concepts of dynamics, elegance and smoothness, to create gorgeous design style. The end cap on the front and side adopts card slot connection. No exposed screw. It is well designed.

High-performance power

Firstly adopted positive shock absorption stable system, it is equipped with high-speed and high-performance mute tubular motor, which reflects top power technology;

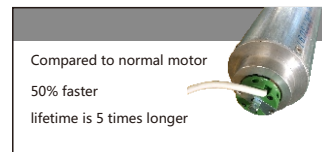

Compared to normal motor
50% faster
lifetime is 5 times longer



Remote Transmitter

General situation

- 1, Large roller, large bearing, large tubular motor and large housing are safe and keep the screen surface flat.
- 2, Quick replacement of motor without taking screen fabrics/roller apart longer life.
- 3, equipped with IR remote control and manual switch.
- 4, Innovative limit structure.
- 5, Adjusting the height of screen fabrics at any position.

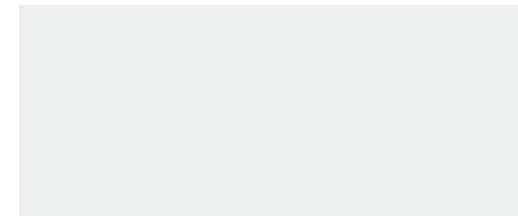

Screen parameter

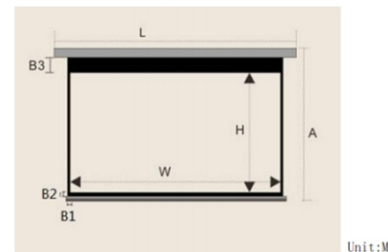

Unit:MM

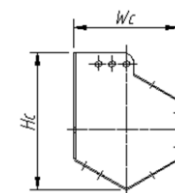

180-300inch

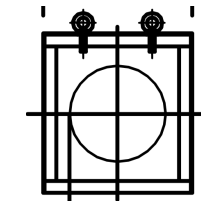

300 inch-30meter

Installation

! Important safety instruction

Warning Please strictly comply with the following safety rules, wrong installation or using methods will bring damage to machinery or personnel injury.

Considerations for installing / using this product

- 1.Please handle with care.
- 2.Don't expose it in the rain and keep away from water.
- 3.Keep away from fire/heat.
- 4.Please don't fold or scratch the screen.
- 5.Check that the voltage is consistent with the requirement to use voltage, it can only connect the power plug and socket with grounding wire.
- 6.Dont't scatching the screen fabric.
- 7.Please recover the screen after used.
- 8.Don't rise and fall the screen in short time.
- 9.Ensure the screen to be installed in a horizontal position.



Please follow the manual to operate.
Please contact professional service staff for installation and maintenance.



Please pay attention to insulation of product Shell and accessories.
Do not remove the end cap, to avoid risk of electric shock.

- For any fault of installation or operation, we do not assume compensation liability for any mechanical damage or casualties.

**Forbidden arbitrarily debug the screen.
It must be debugged under the guidance of professionals**

Cleanning

Please use dry and soft cloth with non - corrosive components and neutral soap water to clean the screen and the shell carefully. Do not use chemicals or corrosive materials, or it will damage the product.

Installation

Check the list of items

Our company reserves the right to the accessories contained in the manual, and we are subject to change without notice.

installation instructions(1 copy)
warranty card(1 copy)
reminder sticker(1 copy)

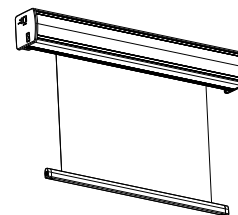

Screen(1)



Remote Transmitter(1)
(optional)



External IR Receiver Cable(1)

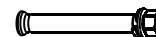

Sleeve screw(4)



Ring safe lock(2)



12v Trigger control cable(1)

► Wall mounting installation

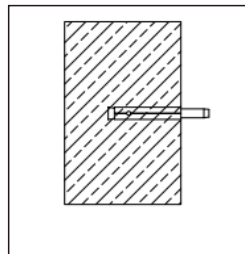

1

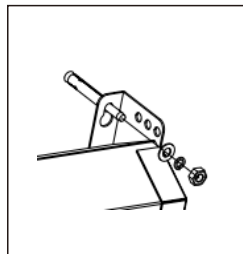

2

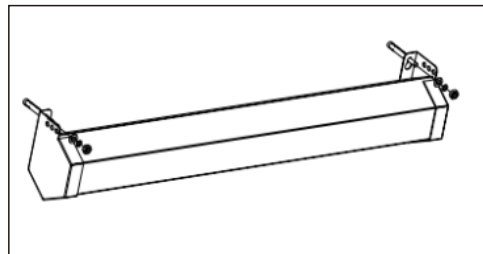

3

► Ceiling top mounting installation

1, Make a steel frame as the following picture(A or B), and fixed the screw in the frame .

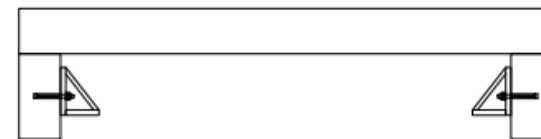

(A)

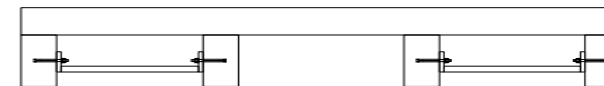

(B)

2, Install a chain hoist in the steel frame. (As you have selected one types of the frame A or B)

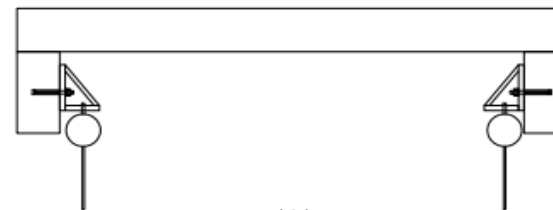

(A)

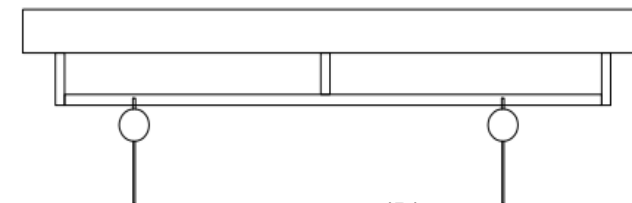

(B)

► Ceiling hanging installation

3, Install the screen in the bracket (see the figure)

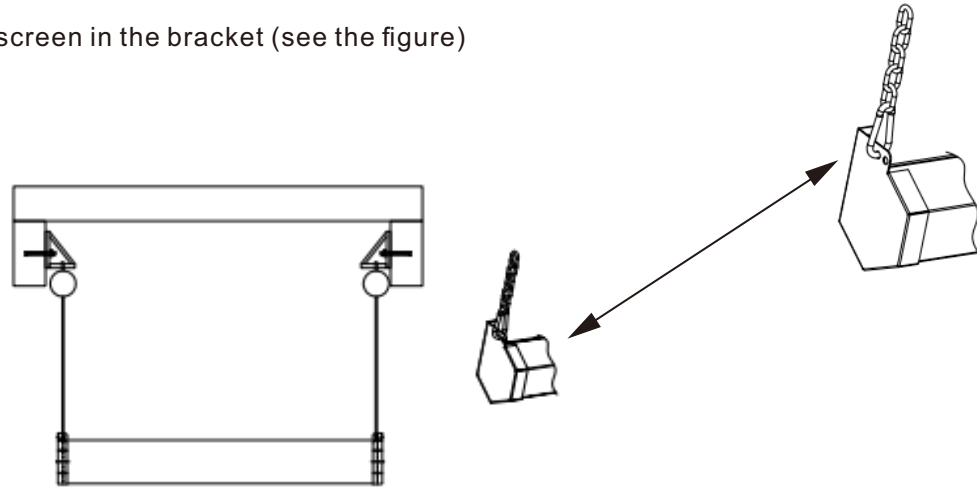

4, Operate the chain hoist to control the suitable height of screen.

Electric screen using method

There are two electric screen control modes, manual control mode and remote control mode.

First: Manual control instruction:

Use the switch to control the screen up and down. When you choose "down", the screen will expand; when you choose "up", the screen will recover.

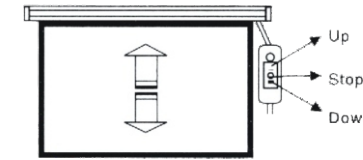

Second: Build-in wireless control/external wireless control/ IR remote control is optional for electric screen users.

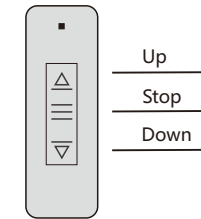

1.extend :

The screen will fall to the setting position when you push this button.

2.recover :

The screen will recover when you push this button.

3.Stop

The screen will stop when you push this button.

Remote control

Control Mode

1 Remote control

Remote-controlled distance reaches 25m in any direction



2 IR control

Remote-controlled distance reaches 8m, in the direction within plus or minus 60 degree.



3 End cap control

Remote-controlled distance reaches 8m, in the direction within plus or minus 60 degree.

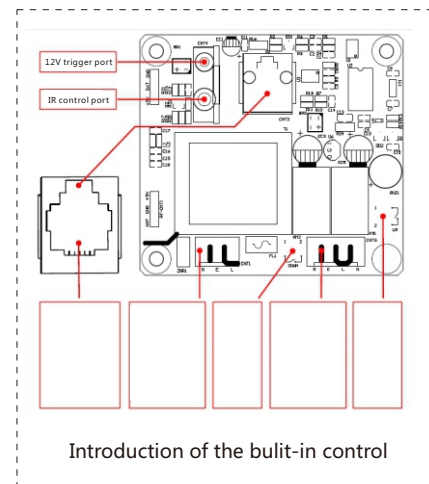
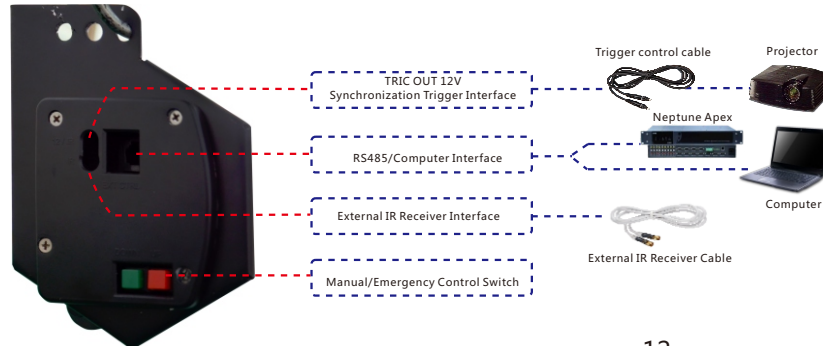

Remote control

Rs485 control

A. RS485 port setting

- 1) Baud rate: 2400
- 2) Parameter length: 8
- 3) Odd-even check: N
- 4) Start position: 1
- 5) Stop position: 1

B. Control code

- 1) Up code: 0xFF 0xAA 0xEE 0xEE 0xDD
- 2) Stop code: 0xFF 0xAA 0xEE 0xEE 0xCC
- 3) Down code: 0xFF 0xAA 0xEE 0xEE 0xEE

C. Function control

- 1) Up code: motor up
- 2) Stop code: motor stop
- 3) Down code: motor down

Identification and elimination of faults

| Fault phenomenon | Fault analysis | Solution |
|---|--|---|
| The indicator light of the transmitter flashes but the receiver has no response. | 1. The wire connection of receiver is correct or not. 2. Check the transmitter is coded or not. | A. According to the manual to connect the wire. B. The transmitter and the receiver are coded correctly. |
| The transmitter and the receiver operate smoothly but the motor does not operate. | 1. Whether the motor wired is correct. | A. According to the manual to connect the wire. |
| Remote control is insensitive and has no response. | 1. Whether the battery of the remote controller is run out of. | A. Replace a new battery. |

Built-in control coding steps

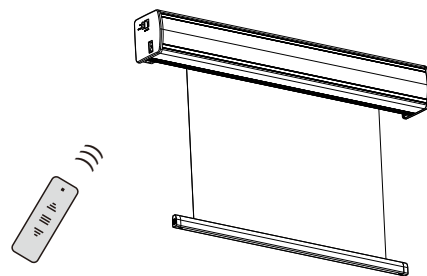

External DC/AC 12V power control

- A、DC/AC 12V When power on, the motor is automatically down ,
- B、DC/AC 12V When power off, the motor is automatically up ,
- C、Input voltage range: DC/AC 5V — DC/AC 20V

Identification and elimination of faults

| Symptom | Symptom analysis | Solution |
|--|-----------------------------------|--|
| There is no response when controlling the screen up and down | Battery is run out of. | Replace new battery |
| | Power line hasn't been connected. | Ensure that appropriate power is connected |
| The screen is lower than the setting position or not folded or unfolded completely | Stoke have been changed | Refer to this manual to adjust the up stoke and down stoke |

Screen stoke regulation

Forbidden to arbitrarily debug the screen stoke, which should be debugged under the guidance of professionals

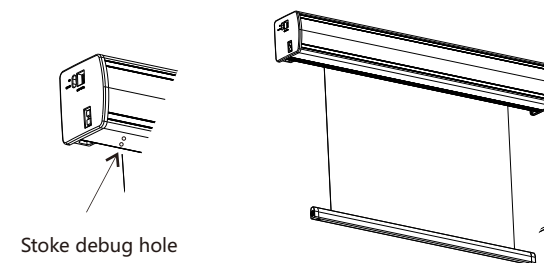

A:Debug the up position(black bottom):

- 1) Stoke debug hole is "red button"
- 2) To increase the position, please rotate in the direction of (+), 2.15cm per circle;
- 3) To decrease the position, please rotate in the direction of (-), 2.15cm per circle

B:Debug the down position(black top):

- 1) Stoke debug hole is "white button"
- 2) To decrease the position, please rotate in the direction of (-), 2.15cm per circle;
- 3) To increase the position, please rotate in the direction of (+) 2.15cm per circle.