

HYBRID INVERTER

5.6KW/8KW/10KW/11KW/12KW



Product Features

- ◆ It has the function of sectional charge and discharge.
- ◆ It can be used without battery. Solar and utility grid can power loads at the same time.
- ◆ With dual activation function of lithium battery, it can be triggered by any power supply of the mains/photovoltaic.
- ◆ Two output modes: mains bypass and inverter output; uninterrupted power supply.
- ◆ Complete protections, including over voltage and under voltage protection, overload protection, reverse protection, etc ,360° all-round protection with a number of protection functions.
- ◆ ON/OFF rocker switch for AC output control.
- ◆ Full digital voltage and current double closed loop control, advanced SPWM technology, output of pure sine wave.
- ◆ Intelligent variable speed fan to efficiently dissipate heat and extend system life.

Application Scenario

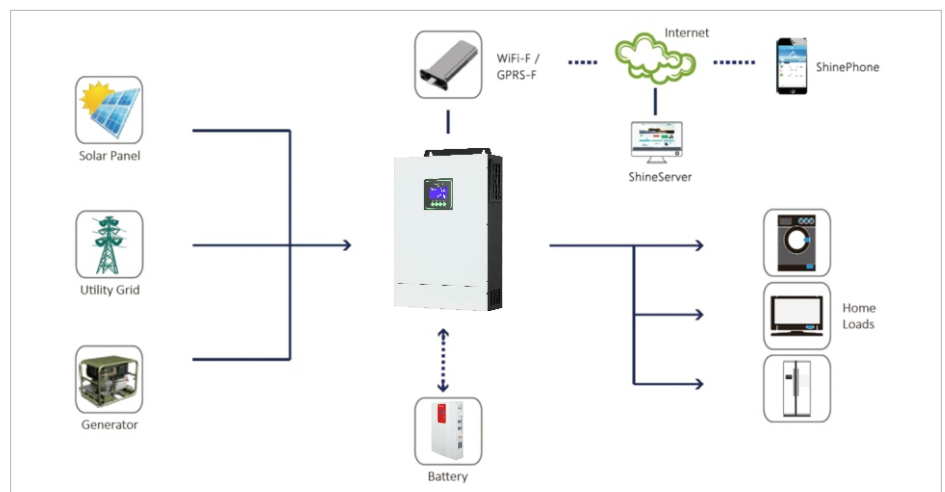

5.6KW HYBRID INVERTER

THON-5.6KW-01P

Product Features

- ◆ Advanced MPPT technology with an efficiency of 99.9%.
- ◆ Two output modes: mains bypass and inverter output; uninterrupted power supply.
- ◆ Power saving mode available to reduce no-load loss.



Model	THON-5.6KW-01P
Battery Voltage	51.2VDC
AC Output	
Rated Power	5600VA/5600W
Rated Voltage	230Vac
Rated Current	24.3A
Battery Input	
Voltage Range	40-60Vdc
Max. Battery Current	125A
AC Input	
Rated Voltage Range	170-280Vac
Rated Frequency	50 Hz/60 Hz
Max. AC Bypass Current	40A
Max. AC Charge Current	60A
PV Input	
Max. Input Power	5600W
Max. Open Voltage	500V
MPPT Input Voltage Range	120-450Vdc
Max. Input Current	22A
Max. Charge Current	100A
Battery Charge Current	
Max. Charge Current	100A
Max. Number Of Parallel	6 sets
Product Size	470*318.7*117.5mm
IP Grade	Ip20
Operating Temperature	-10-55°C
Safety Class	I
Warranty	3 Years

8KW HYBRID INVERTER

THON-8KW-01P

Product Features

- ◆ Advanced MPPT technology with an efficiency of 99.9%.
- ◆ Two output modes: mains bypass and inverter output; uninterrupted power supply.
- ◆ Power saving mode available to reduce no-load loss.



Model	THON-8KW-01P
Battery Voltage	51.2VDC
AC Output	
Rated Power	10000VA/8000W
Rated Voltage	230Vac
Rated Current	48A
Battery Input	
Voltage Range	40-60Vdc
Max. Battery Current	250A
AC Input	
Rated Voltage Range	170-280Vac
Rated Frequency	50Hz
Max. AC Bypass Current	60A
Max. AC Charge Current	120A
PV Input	
Max. Input Power	5500W+5500W
Max. Open Voltage	500Vdc
MPPT Input Voltage Range	90-450Vdc
Max. Input Current	22A+22A
Max. Charge Current	150A
Battery Charge Current	
Max. Charge Current	150A
Max. Number Of Parallel	6 sets
Product Size	576*368.6*133mm
IP Grade	IP20
Operating Temperature	-10-55°C
Safety Class	I
Warranty	3 Years

11KW HYBRID INVERTER

THON-11KW-01P

Product Features

- ◆ Anti-countercurrent grid-connected function (photovoltaic hybrid power supply), grid-connected mode can be set.
- ◆ Advanced MPPT technology with an efficiency of 99.9%.
- ◆ Two output modes: mains bypass and inverter output; uninterrupted power supply.
- ◆ Power saving mode available to reduce no-load loss.



Model	THON-11KW-01P
Battery Voltage	51.2VDC
AC Output	
Rated Power	11000VA/11000W
Rated Voltage	230Vac
Rated Current	48A
Battery Input	
Voltage Range	40-60Vdc
Max. Battery Current	250A
AC Input	
Rated Voltage Range	170-280Vac
Rated Frequency	50Hz
Max. AC Bypass Current	60A
Max. AC Charge Current	120A
PV Input	
Max. Input Power	5500W+5500W
Max. Open Voltage	500Vdc
MPPT Input Voltage Range	90-450Vdc
Max. Input Current	22A+22A
Max. Charge Current	150A
Battery Charge Current	
Max. Charge Current	150A
Max. Number Of Parallel	6 sets
Product Size	576*368.6*133mm
IP Grade	IP20
Operating Temperature	-10-55°C
Safety Class	I
Warranty	3 Years

10KW/12KW HYBRID INVERTER

THON-10KW-01P THON-12KW-01P

Product Features

- ◆ Anti-countercurrent grid-connected function (photovoltaic hybrid power supply), grid-connected mode can be set.
- ◆ Advanced MPPT technology with an efficiency of 99.9%.
- ◆ Two output modes: mains bypass and inverter output; uninterrupted power supply.
- ◆ Power saving mode available to reduce no-load loss.



Model	THON-10KW-01P	THON-12KW-01P
Battery Voltage	51.2VDC	51.2VDC
AC Output		
Rated Power	10000VA/10000W	12000VA/12000W
Rated Voltage	230Vac	230Vac
Rated Current	50A	50A
Battery Input		
Voltage Range	40-60Vdc	40-60Vdc
Max. Battery Current	260A	260A
AC Input		
Rated Voltage Range	170-282Vac	170-282Vac
Rated Frequency	50/60Hz	50/60Hz
Max. AC Bypass Current	63A	63A
Max. AC Charge Current	160A	160A
PV Input		
Max. Input Power	6000W*2	6000W*2
Max. Open Voltage	500Vdc	500Vdc
MPPT Input Voltage Range	90-500Vdc	90-500Vdc
Max. Input Current	22A*2	22A*2
Max. Charge Current	220A	220A
Battery Charge Current		
Max. Charge Current	220A	220A
Max. Number Of Parallel	6 sets	6 sets
Product Size	651.9*468.6*137mm	651.9*468.6*137mm
IP Grade	Ip20	Ip20
Operating Temperature	-10-55°C	-10-55°C
Safety Class	I	I
Warranty	3 Years	3 Years