



HB28

Follow the light and the shadow
Born for beauty

Light effect
150 Lm/W

IP54

RA>80

PF>0.9

Finned heat dissipation

High purity aluminum fin radiator with a thermal conductivity of approximately $237\text{W} / \text{m} \cdot \text{k}$;

Surface blackening treatment, not easy to corrode and rust;

Using precision riveting process, the structure is stronger;

Optimize air duct, better air convection, and maximize heat dissipation area.

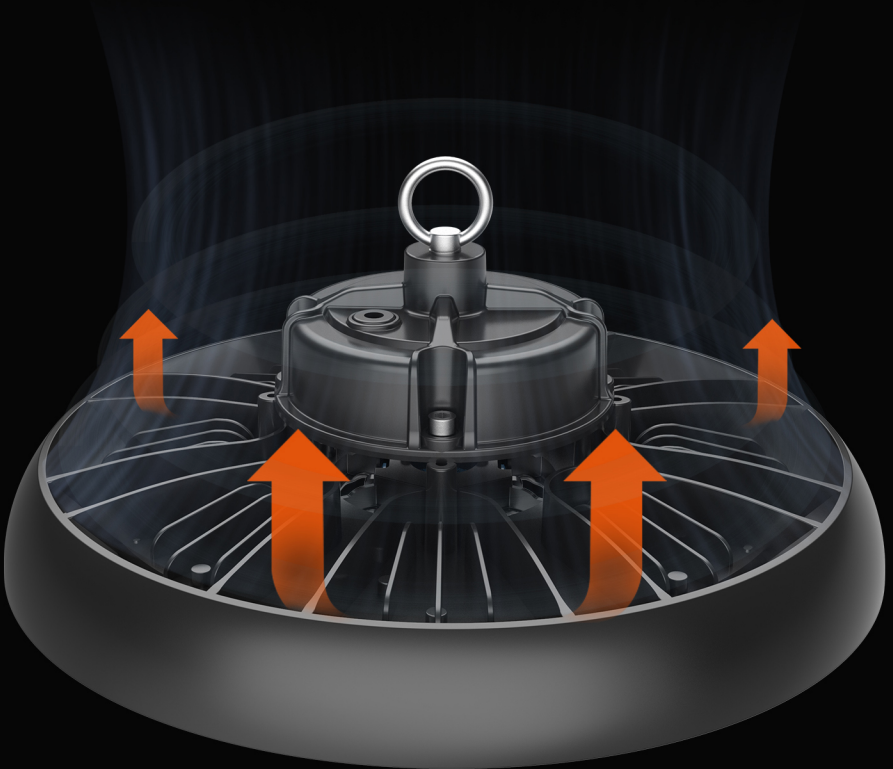

Radar microwave induction

Using plane technology to wirelessly transmit and receive microwave induction, the light will be automatically turned on when people arrive, the light will be on when people are walking, and the light will be dimmed when people leave, and it will be completely off later.

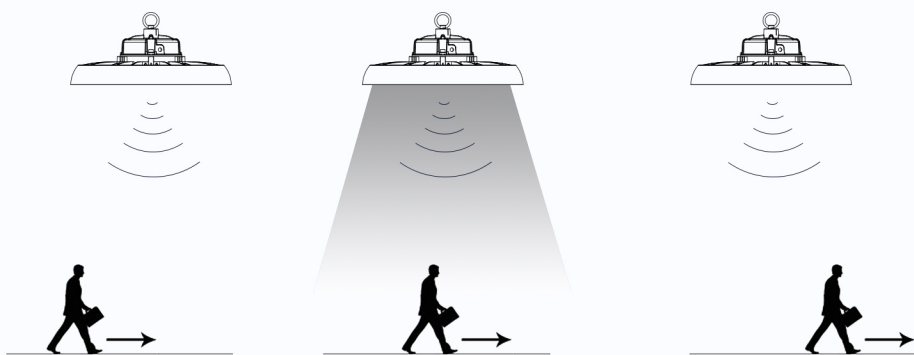

1. When the microwave sensor senses people walking, the working brightness of the lamp reaches 100%;
2. At this time, the lamps cannot sense people walking, and will wait for 50% brightness after 10 seconds;
3. After 20 seconds, the brightness will be 0% without induction

High brightness light source

Highlight LED lamp beads, color rendering index $Ra > 80$;

The luminous efficiency is up to $150\text{Lm} / \text{W}$, and the energy efficiency is more than 60%.

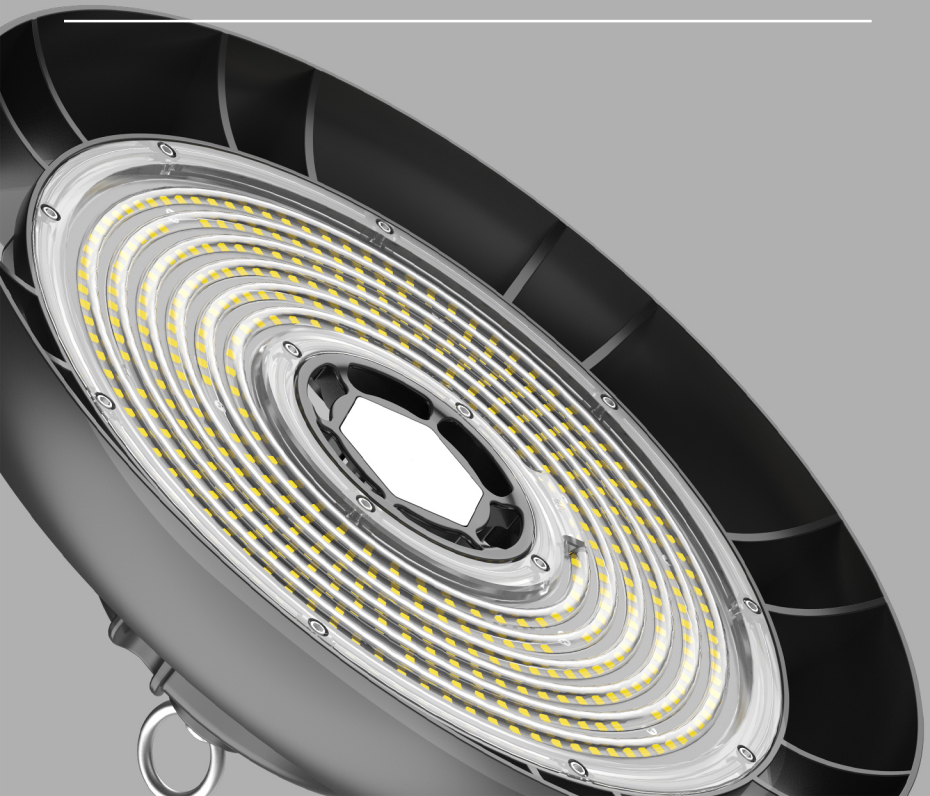

Choose from three color temperatures.

Three color temperatures of warm white, normal white and cool white are available to meet the lighting requirements of different scenes.



4000K
warm white

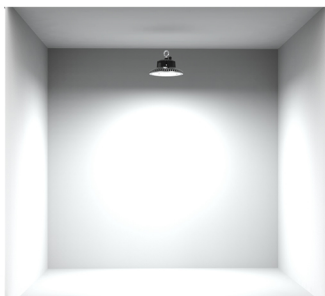

5700K
Positive white



6500K
Cold white

Precise light distribution of multi lens angle

Use optical grade PC lenses, 60 ° \ 90 ° \ 120 °

The choice of light angle is suitable for professional light distribution needs.

110°

90°

60°



Application

Widely used for lighting in high bay workshops, workshops, warehouses, exhibition halls, gymnasiums, waiting rooms, stations, airports, shopping malls, hypermarkets, outdoor buildings and other places.





Lamp size chart (take 150W as an example):

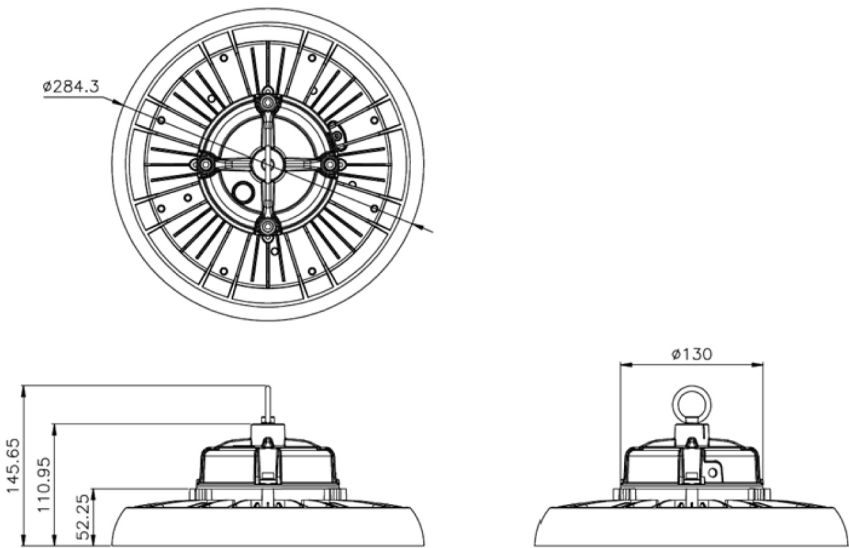

Packaging diagram:

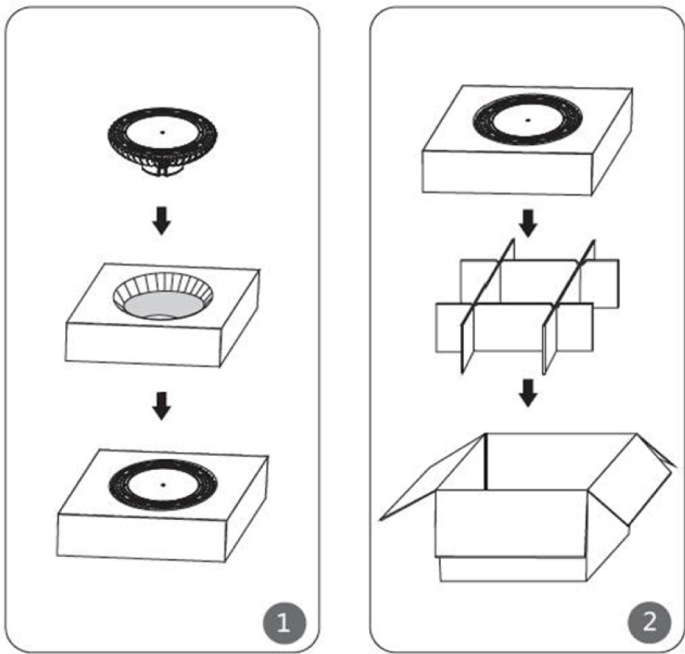

Packaging data:

Model	Product size mm(φ*H)	Package size mm (L*W*H)	QTY	N.W/G.W (KG)
CHZ-HB28-100W	φ259xH106	270x270x140	1	1.5/2.0
CHZ-HB28-150W	φ285xH111	300x300x190	1	2.0/2.5
CHZ-HB28-200W	φ341xH120	350x350x210	1	2.5/3.0
CHZ-HB28-250W	φ373xH137	350x350x210	1	3.0/3.5

**Parameter:**

Model	HB28-100W	HB28-150W	HB28-200W	HB28-250W
Rated Power	100W	150W	200W	250W
Chip type	SMD2835	SMD2835	SMD2835	SMD2835
Chips Qty	210PCS	275PCS	300PCS	430PCS
Chips S/P	14S15P	11S25P	15S20P	10S43P
Light source voltag	126V	99V	135V	90V
Drive type	ZHIHE/PHILIPS/SOSEN/MW, optional		ZHIHE/PHILIPS/SOSEN/MW, optional	
Input Volt.	100-277V	100-277V	100-277V	100-277V
Drive type	Conventional/1-10V/DALI, optional			
Power factor	>0.95	>0.95	>0.95	>0.95
Light effect	>150	>150	>150	>150
Color Temp.	3000K~6500K	3000K~6500K	3000K~6500K	3000K~6500K
Color Rend.	>80	>80	>80	>80
Beam Angle	60°/90°/110°	60°/90°/110°	60°/90°/110°	60°/90°/110°
Lamp size	φ246x112 mm	φ270x126 mm	φ320x150 mm	φ320x150 mm
Lamp size	Die-cast aluminum lamp body + PC lens			
Protection class	IP54/4KV	IP54/4KV	IP54/4KV	IP54/4KV
Operating tempera	-40℃~+50℃	-40℃~+50℃	-40℃~+50℃	-40℃~+50℃
Working humidity	10%~90%	10%~90%	10%~90%	10%~90%
Life/Warranty	50,000hrs / 5 Yrs	50,000hrs / 5 Yrs	50,000hrs / 5 Yrs	50,000hrs / 5 Yrs