

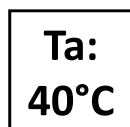

Series CHZ-GD32 Installation Manual

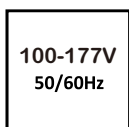
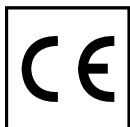
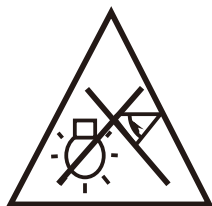
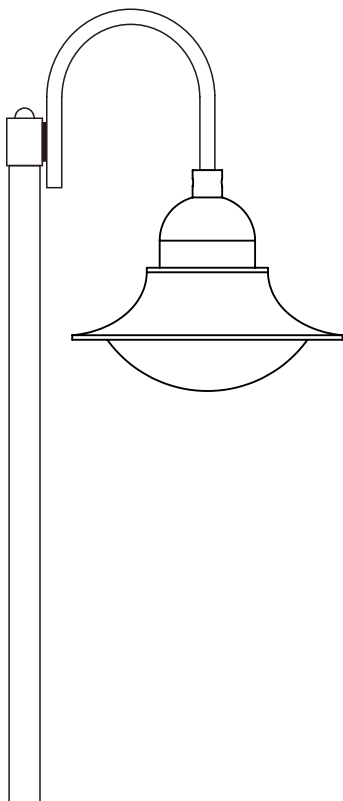

Warning !

- During installation make sure that the power supply is switched off.
- The luminaires must be installed by a qualified electrician, following the manufacturer's instructions, complying with all the rules and regulations regarding electrical installations, both national and local.
- Devices sensitive to electrostatic discharge * ESD *. Handle with the necessary precautions to avoid them.
- Incorrect assembly can cause damage.
- CHZ is not responsible for any misuse of the product.
- If the cable or flexible cable of this luminaire is damaged, it must be replaced by a flexible cable or a special cable provided exclusively by the manufacturer or its technical service.
- If the luminaires are provided with connection conductors (outputs) that require a separate connection block for connection to the fixed wiring of the installation, the space required for this connection block must be provided, either inside the luminaire or in the a box supplied with the luminaire or defined by its manufacturer. You must define a fixed installation box for the luminaire.
These dimensions of the connection block can be equal to 10mm x 20mm x 25mm.

Warning!

- During the installation process, ensure that the electrical current is switched off.
- Lamps must be installed by a qualified electrician, in accordance with the Manufacturer's Declaration that complies with all standards and regulations. These are national and local electrical installations.
- Equipment sensitive to electrostatic discharge * ESD *. Necessary. Avoid your precautions. improper mounting can cause failure.
- The chz is not responsible for any misuse of the product.

(*) can only be operated to replace LED sheets or glass breaks. No Comments Replaceable.
Light source that can only be replaced by the manufacturer Services or other qualified persons.

SHANGHAI CHZ LIGHTING CO., LTD.

No. 518, Xiangjiang Road, Shanghai, CHINA

+ 86 159 2122 3752 (English)

+ 34 615 734 994 (Español)

www.chz-lighting.com

sales@chz-lighting.com

Optical parameters

Model	Rate Power	Input Voltage	LED Chips	Efficacy @6500K	CCT	Beam Angle	IP	IK	Size (mm)		
									φ1	φ2	H
GD32-30W	30W	AC100-277V	SMD3030	>130LM/W	3000K 4000K 5000K 5700K 6500K	145°x80° 150°x150°	IP66	IK09	48	441	357
GD32-60W	60W	AC100-277V	SMD3030	>130LM/W			IP66	IK09	48	441	357
GD32-90W	90W	AC100-277V	SMD3030	>130LM/W			IP66	IK09	48	441	357
GD32-100W	100W	AC100-277V	SMD3030	>130LM/W			IP66	IK09	48	441	357
GD32-120W	120W	AC100-277V	SMD3030	>130LM/W			IP66	IK09	48	441	357
GD32-150W	150W	AC100-277V	SMD3030	>130LM/W			IP66	IK09	48	441	357

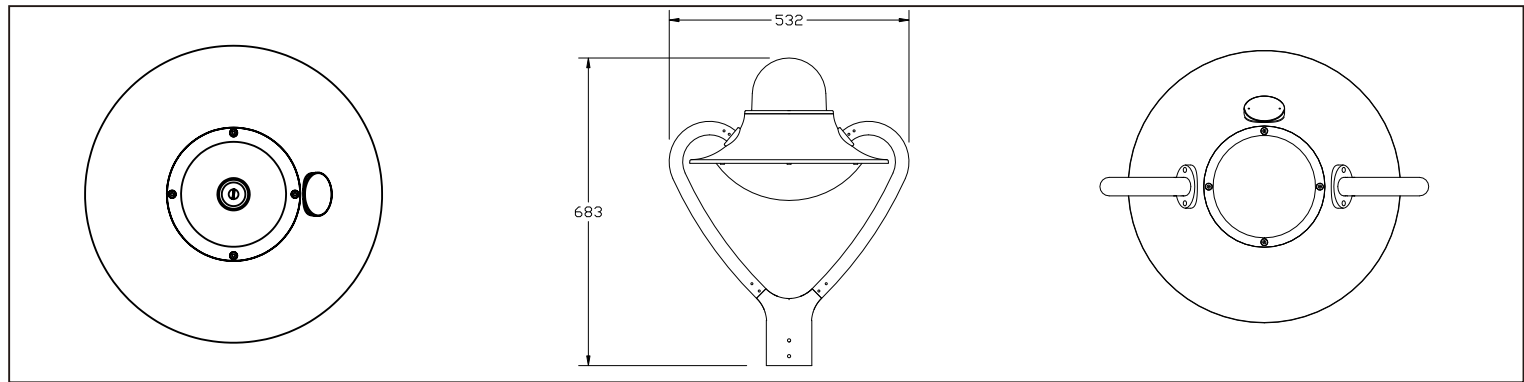
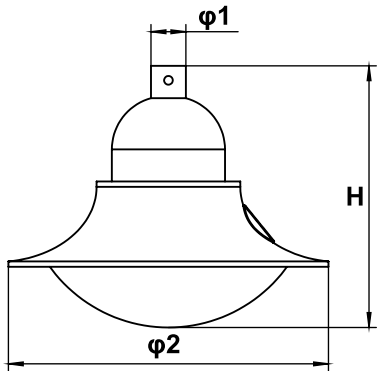

ELECTRICAL CONNECTIONS - 100-240V/277V AC, 50/60Hz

Class I BASED

STEP 1:

Make the following Electrical Connections:

- Connect **INPUT GROUND** conductor to “G” position of the terminal block.
- Connect **INPUT VOLTAGE** conductor to “L” position of the terminal block.
- Connect **INPUT NEUTRAL** conductor to “N” position of the terminal block.

STEP 2:

Make sure all excess input wires are pushed into pole, screws are tightened.

STEP 3:

Close cover by firmly pushing cover towards fixture, making sure that no wires are pinched and Sealing gasket are fully engaged.

STEP 4:

If the fixture without a surge protector, please insulate all electrical connections with wire nuts suitable for at least 90°C.

Input cable should be at least H05RN-F 3x1.0mm²(SJTW 18AWG) or outdoor grade cable with rubber sheathed(not supplied). The cable must have a minimum cross sectional area of 1.0mm²(18AWG).

FIXTURE WIRING

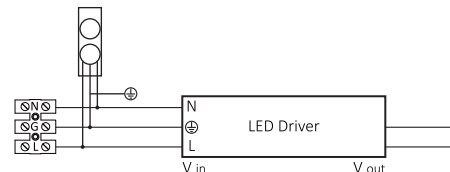

*If the fixture with built-in dimming function, please connect INPUT POSITIVE(+) signal conductor to DIM+ (PURPLE WIRE), INPUT NEGATIVE(-) signal conductor to DIM-(GREY WIRE) of LED driver.

ELECTRICAL CONNECTIONS - 100-240V/277V AC, 50/60Hz

Class II BASED

STEP 1:

Make the following Electrical Connections:

- Connect **INPUT VOLTAGE** conductor to “L” position of the terminal block.
- Connect **INPUT NEUTRAL** conductor to “N” position of the terminal block.

STEP 2:

Make sure all excess input wires are pushed into pole, screws are tightened.

STEP 3:

Close cover by firmly pushing cover towards fixture, making sure that no wires are pinched and Sealing gasket are fully engaged.

STEP 4:

If the fixture without a surge protector, please insulate all electrical connections with wire nuts suitable for at least 90°C

Input cable should be at least H05RN-F 3x1.0mm²(SJTW 18AWG) or outdoor grade cable with rubber sheathed(not supplied). The cable must have a minimum cross sectional area of 1.0mm²(18AWG).

FIXTURE WIRING

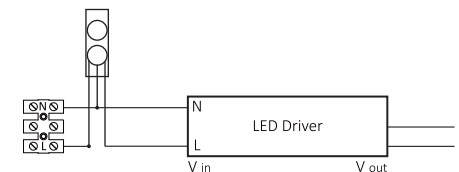

*If the fixture with built-in dimming function, please connect INPUT POSITIVE(+) signal conductor to DIM+ (PURPLE WIRE), INPUT NEGATIVE(-) signal conductor to DIM-(GREY WIRE) of LED driver.