

CE CB RoHS



ST45 series LED Street Light

20W~240W

- A. High pressure die-casting aluminum housing with quick heat ventilation.
- B. Excellent thermal management and outstanding self-cleaning capability.
- C. High efficient SMD5050 chips and high quality driver, assures long lifetime.
- D. Multiple beam angle optics for options according to various lighting applications.
- E. With movable handle, the installation angle is adjustable from 0-90 °; the lamp housing can be opened manually, and the power is automatically cut off, which is convenient for maintenance.



ST45-XS



ST45-S



ST45-M



ST45-L



ST45-XL

Product Number	ST45-XS	ST45-S	ST45-M	ST45-L	ST45-XL
Rated Power	20-40W	50-60W	80-100W	120-150W	200-240W
LED's (pcs)	24	36	54	96	144
Input Voltage	100~277V AC				
LED Brand	LUMILEDS, CREE or SOUL				
Chip Type	SMD5050				
Led Light Luminous	≥160LM/W				
Driver brand	MW, PHILIPS, INV or SOSEN				
Beam Angle	TYPE I, TYPE II, TYPE III or TYPE V				
Control method	Regular, 0-10V/PMW/DALI dimming, optional				
Sensor	Nema or ZHAGA, optional				
Power factor	>0.95				
Color rendering index	>70 or >80				
Frequency Range	50/60Hz				
Color Temp	3000~6500K				
Lamp body material	AL Body, PC lens and GLASS cover				
Installation diameter	Φ60mm(default)				
Working Temperature	-40~55°C				
Working Humidity	10~90%				
Life/Warranty	>50,000hrs				
Surge protection	10KV or 20KV				
IP Grade	IP66				
IK Grade	IK09				
Lamp Size	576x209x89mm	593x263x89mm	646x263x89mm	709x315x89mm	812x315x89mm
Authentication	CE,CB,ENEC/ENEC+,RoHS				

Performance Testing



IK Degree: IK09
All-round sealing, anti-drop, anti-collision, Adopt ADC12 material, sturdy and more durable.



IP Degree: IP66
Professional all-round waterproof technology, Rainproof, anti-corrosion, high temperature resistance and more durable.

Product Size

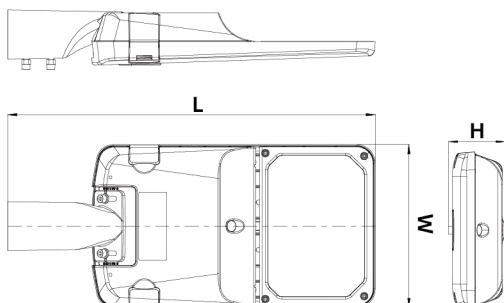

产品型号	L	W	H
ST45-XS	576	209	89
ST45-S	593	263	89
ST45-M	646	263	89
ST45-L	709	315	89
ST45-XL	812	315	89

Product Display

ST45 will use stunning fixtures visually. The result is a lighting solution that enhances the richness of the lighting installation environment.

Regardless of the configuration, each product in the ST45 series features the same graceful bending fixture, clean casing, and almost seamless installation components.

POLE MOUNTED

- The pole mounted luminaires are available with upswept side-arm and decorative pendant mounting configurations. Contemporary and sleek styling help the ST45 blend into any environment.



OPTICAL SYSTEM

- With its dense LED arrangement and precision optics, the ST45 delivers high-performance illumination and extraordinary visual comfort.

Respirator design

- Waterproof and breathable, it can balance pressure, reduce fog, frost, eliminate moisture, and also assist in heat dissipation, high and low temperature resistance, corrosion resistance, oil pollution prevention, UV resistance and other functions.

Smart Control and Dimmable Zhaga

Zhaga Sensor and Receptacle for
Led street light
Intelligent rotary lock light controllers
Anti-UV PP/PC material
IP65~IP67
Multiple sensor and wireless communication
solutions



Product Display

Lighting plays an increasingly important role. A good lighting environment helps residents and visitors feel safe and experience the city more pleasantly even at night.

Urban lighting plays an important role in making cities better and safer. Good lighting helps residents and visitors to feel better and enjoy the city at night also. Thanks to the LED efficient lighting system, energy consumption can be reduced, energy efficiency and sustainability can be achieved.



Power drive

Constant current output control mode, dimmable shutdown, lightning protection, overvoltage protection, short circuit protection and over temperature protection to ensure high product reliability

Lightning protection module

While waterproof and breathable, it can balance pressure, reduce fogging, frost, and eliminate moisture. It also has functions such as micro heat dissipation, high and low temperature resistance, corrosion resistance, oil pollution, and UV resistance.

03

04

Installation method

The luminaire adopts horizontal and vertical installation, and supports angle adjustment, which can be adjusted according to different lighting environment to meet different lighting needs.



Light Pole Application

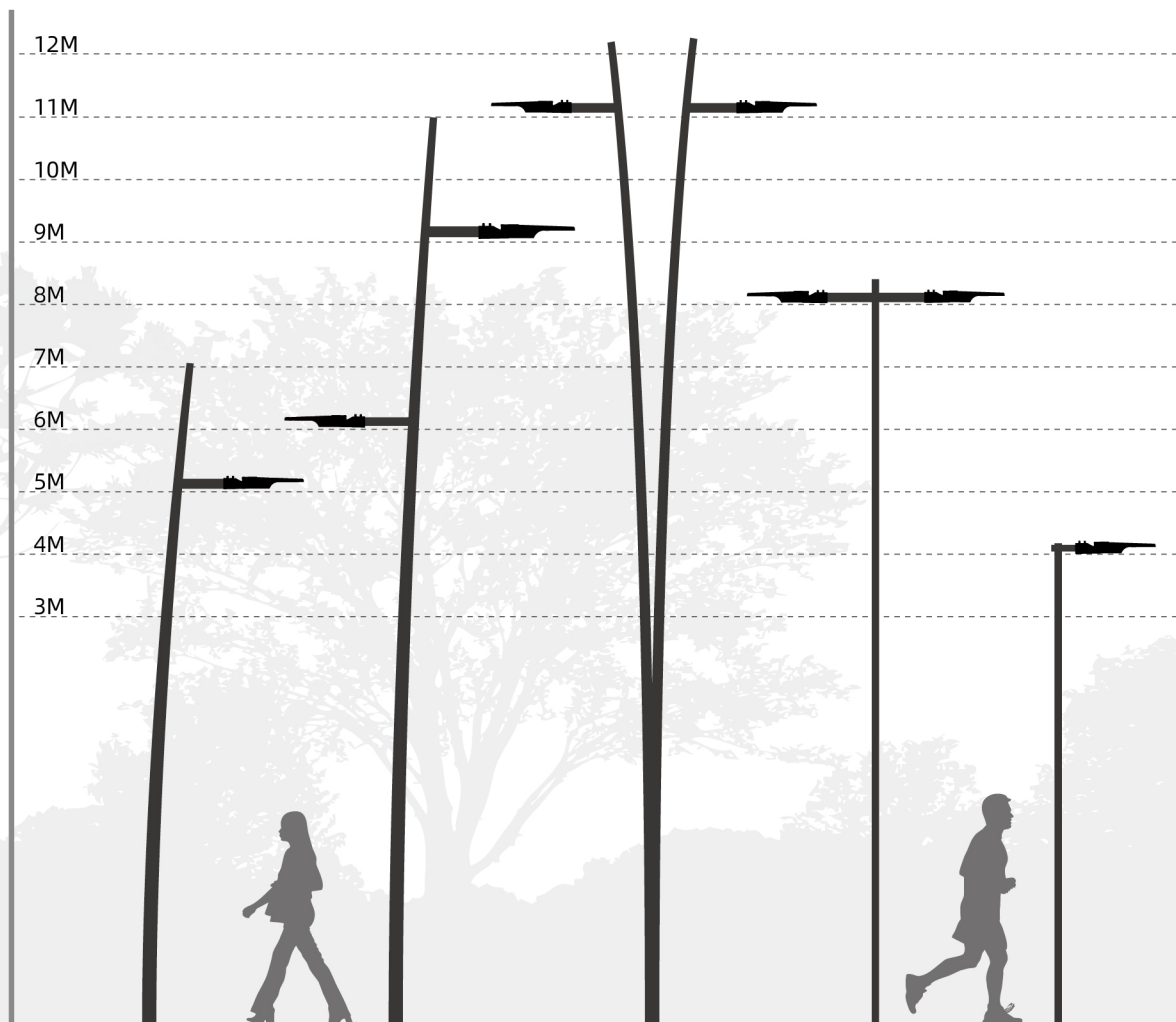

Intelligent Lighting

The lamps can be equipped with smart components and configured as smart street lamps, integrating transportation, environmental monitoring, energy management, city management and other hardware functions, which can be widely distributed to all corners of the city to help the construction of smart cities.



05



06

Installation instructions

Steps for Vertical Installation

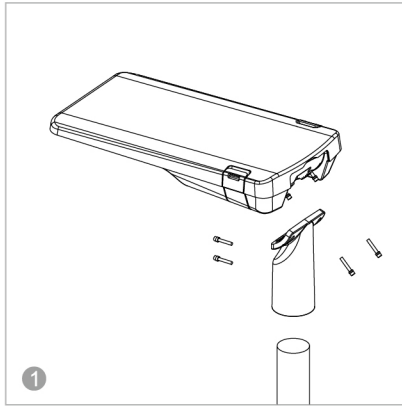

Align the sleeve fixing hole with the screw hole, and fix the sleeve with the hexagon bolt and flat washer with a hexagon wrench.

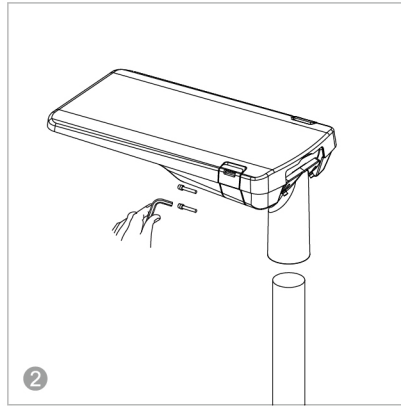

Align the lamp with the lamp pole and insert it, and fix it with hexagon wrench and hexagon socket bolt.



The effect of lamps after installation.

Steps for Horizontal Installation

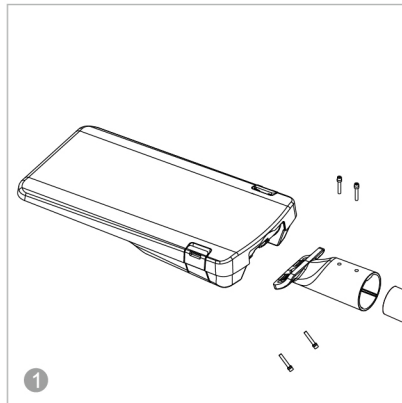

Align the sleeve fixing hole with the screw hole, and fix the sleeve with the hexagon bolt and flat washer with a hexagon wrench.

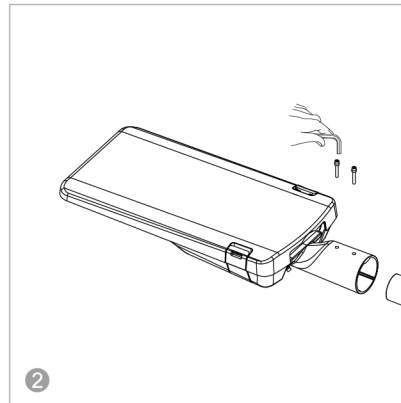

Align the lamp with the lamp pole and insert it, and fix it with hexagon wrench and hexagon socket bolt.

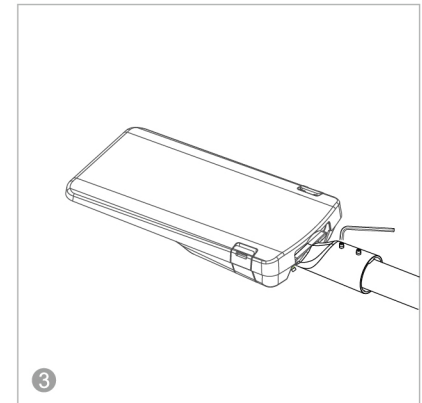

The effect of lamps after installation.

Precautions:

1. The working voltage of this model of lamp is based on the product specification and reference to the product label.
2. All wiring must comply with national installation standards, and all joints must be properly connected and waterproof treated.
3. Lamp maintenance or replacement requires qualified personnel to replace to avoid danger.
4. The controller modulation should be operated according to the instructions.

Light Distribution Display

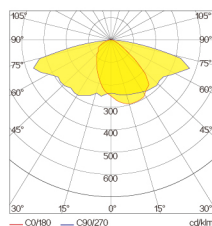

TYPE II

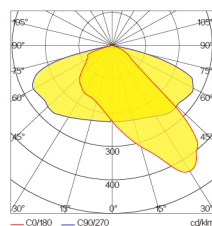

TYPE II-S

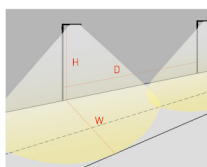

TYPE II : This type of light is mainly used for wide sidewalks, entrances to traffic lanes, bicycle lanes or other narrow and narrow lighting applications. The main body of the lamp holder is located on the side of the road, not in the center. The illumination width is roughly 1.75 times the lamp height.

H=The vertical height of the street light pole and the ground
W = the width of the irradiated area
D = the distance between the street lamp and the street lamp

07

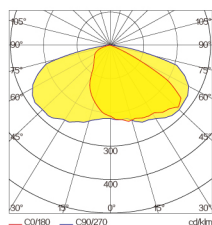

TYPE III

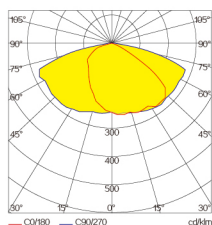

TYPE III

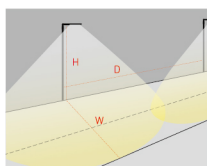

TYPE III : Mainly used for highways, driving lanes, parking lots and general square lighting. The main body of the lamp holder is located on the side of the road, and the lighting width is 2.75 times the height of the lamp.

H=The vertical height of the street light pole and the ground
W = the width of the irradiated area
D = the distance between the street lamp and the street lamp

08

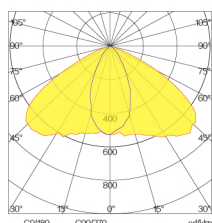

TYPE I

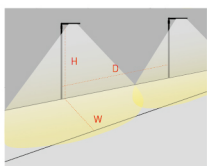

TYPE I : Mainly used for general parking lot lighting and large-scale square lighting. The lighting range is a circle, and the main body of the lamp holder is located in the center of the lighting area.

H=The vertical height of the street light pole and the ground
W = the width of the irradiated area
D = the distance between the street lamp and the street lamp



It is suitable for parking lots, parks, residential areas, industrial areas, schools, hospitals, communities and other outdoor lighting places



09

10



SHANGHAI CHZ LIGHTING CO.,LTD

21 6989-8169

86 133 9137 5176 | 86 159 2122 3752

www.chz-lighting.com

Sales@chz-lighting.com

No.518 Xiangjiang Road, Jiading, Shanghai, China.