



CHANGXING QIANGSHENG MACHINERY CO.,LTD.

TEL: 0086 572 6129011 / 0086 572 6662711

ADD: NO.2 SHANGZHUANG ROAD ECONOMIC DEVELOPMENT ZONE, CHANGXING, ZHEJIANG, P.R CHINA

EMAIL: INFO@QSLIFT.COM | WWW.QSLIFT.COM

INTELLIGENT SOLUTIONS FOR INTRALOGISTICS

FULL RANGE ELECTRIC WAREHOUSE EQUIPMENT

CHANGXING QIANGSHENG MACHINERY CO.,LTD.



COMPANY INTRODUCTION

QS LIFT, a brand under Qiangsheng Machinery, is a highly competitive provider of material handling solutions. We offer a full range of warehouse logistics handling equipment and customized services.

QS LIFT products are manufactured in Qiangsheng Machinery's modern intelligent factory located in Changxing, Zhejiang, China. Built to the standards of "Green, Flexible, Smart, and Automated", the factory covers a total area of 60,000 square meters and has an annual production capacity of 220,000 units of warehouse handling equipment.

The core technologies of QS LIFT products are originally designed by the Qiangsheng technical team. Starting in 2011, the company evolved from only processing components to covering the full range of warehouse equipment, a transition driven by the founder's forward-looking vision for the future of the material handling industry. QS LIFT products are favored by customers for electric forklifts and electric stackers due to their precise controllers, lower energy consumption, better compatibility, more stable performance, and highly competitive prices.

Our mission is to deliver optimum value to global customers by providing simple, reliable material handling equipment coupled with local professional services.

For more information about QS LIFT, please visit our website:
<http://www.qslift.com> / www.qs-lift.com



C H A N G X I N G Q I A N G S H E N G M A C H I N E R Y C O . , L T D .

CONTENTS

PALLET TRUCK /P1-64

AC25 / AC30



P01 2500/3000kg

BF25 / BF30



P05 2500/3000kg

BF20-S / BF30-S



P09 2000/3000kg

SHPT20A



P13 2000kg

SHPT20B / SHPT30B



P17 2000/3000kg

EPT15V / EPT20V



P21 1500/2000kg

EPT15 / EPT20



P25 1500/2000kg

EPT15Q



P29 1500kg

EPT20Q / EPT20Q-Li



P33 2000kg

EPT20E / EPT25E



P37 2000/2500kg

EPT20ES



P41 2000kg

EPT20ES-S



P45 2000kg

QET20



P49 2000kg

QET20P / QET25P / QET30P



P53 2000/2500/3000kg

ATLAS EPT30Q



P57 3000kg

QET20M



P61 2000kg

PALLET STACKER /P65-126

QMS1016/1516/2016
QMS1020/1025/1030/1520/1525/1530



P65 1000/1500/2000kg

SES10 / SES12 / SES15



P67 1000/1200/1500kg

QSS15



P71 1500kg

QSS15-SL



P75 1500kg

QES15D



P79 1500kg

QES10E / QES12E



P83 1000/1200kg

QES10E-SL / QES12E-SL



P87 1000/1200kg

QES15E



P91 1500kg

QES15E-SL



P95 1500kg

QES15E-PV



P99 1500kg

QES20E



P103 2000kg

QES15M



P107 1500kg

QES15MSL



P111 1500kg

QES15E-P



P115 1500kg

QES16-P / QES20-P



P119 1600/2000kg

QES10MCB



P123 1000kg



AC25 / AC30 HAND PALLET TRUCK

Capacity 2500 KGS / 3000 KGS

Professional and ideal storage aid for all variety of manual transport tasks over short distances in stores and warehouse as well as factory plants

Top class range of pallet truck with excellent designs, reliable, sturdy, torsion-resistant

Sealed oil cylinder

Excellent whole casting hydraulic pump, robust and durable, with fine control of lowering speed and overload valve, low routine maintenance.

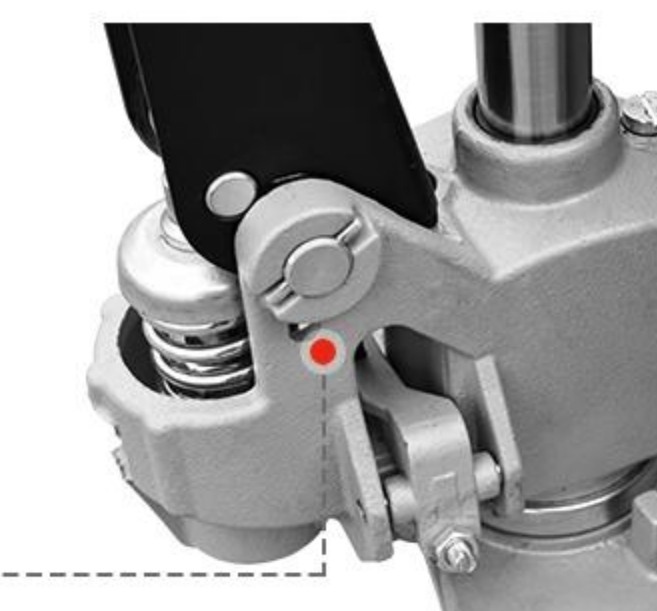

Entry roller

Tandem load roller with additional entry roller which guarantees for maximum stability and safety for transporting goods on slopes.

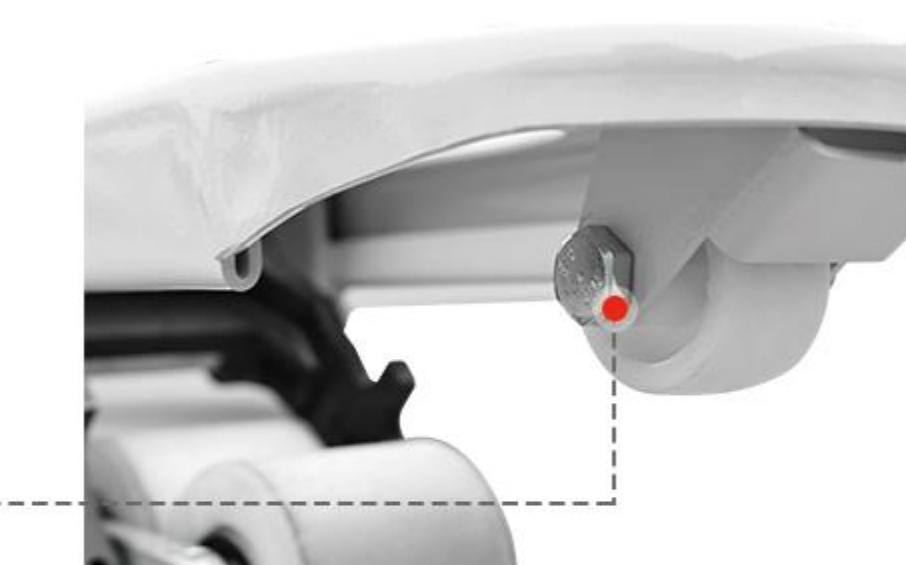

Polyurethane

Ideal for delicate floors with hard wearing and non-marking property, quiet and durable.



Nylon

Low drag efforts, high resistance to chemicals, preferred in food, fishing and chemical industries with smooth floors.

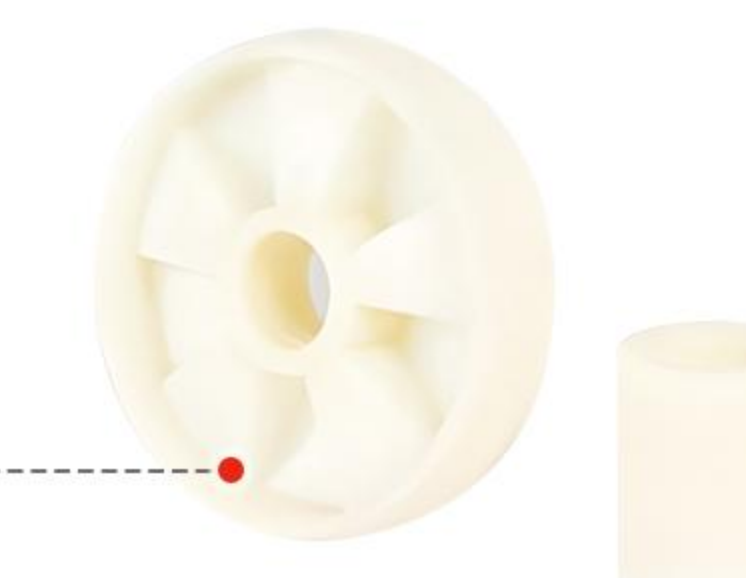

Rubber

Best choice for quiet and durable demands, ideal for smooth and rough floors.

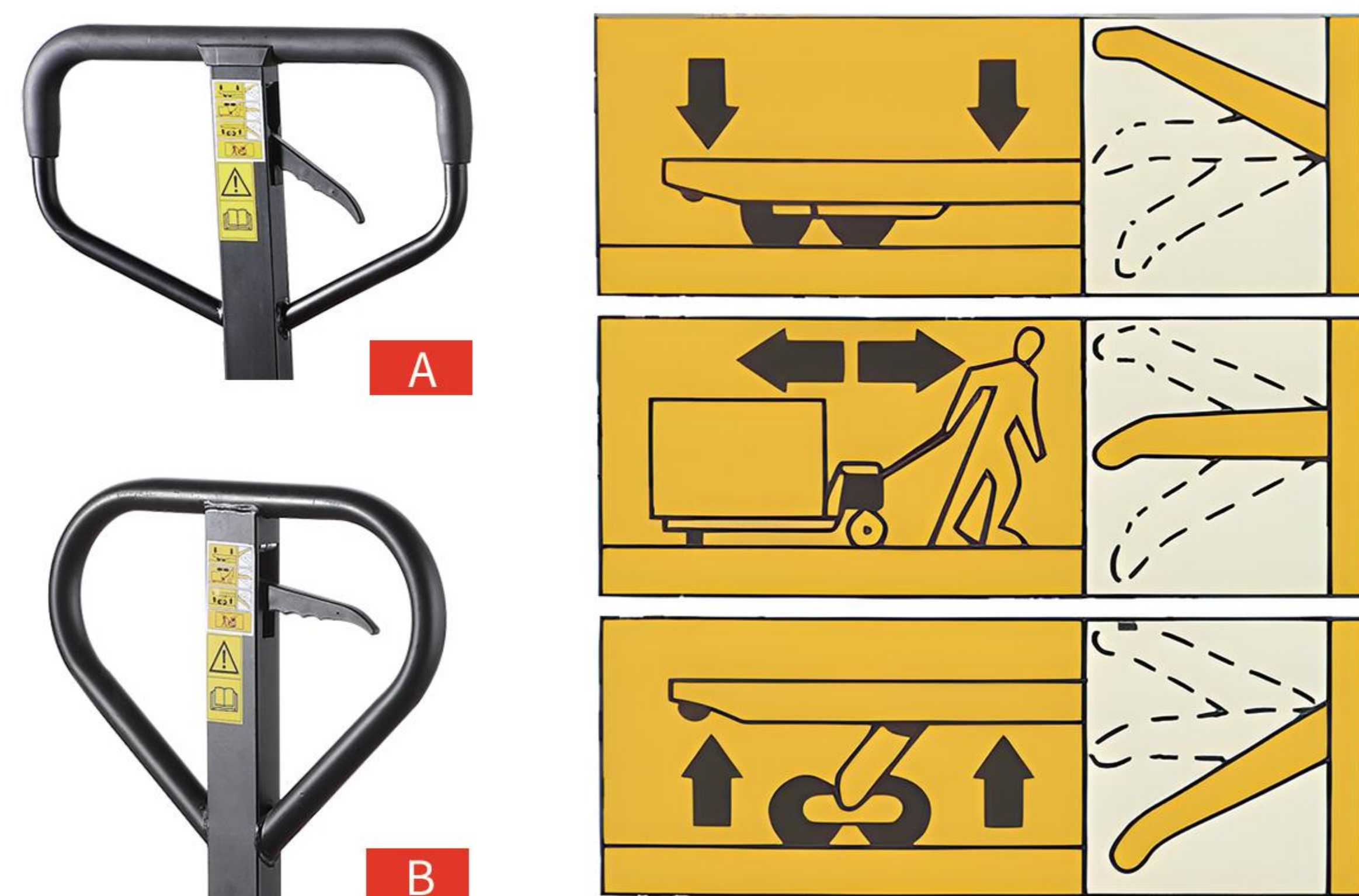

Three position operational handle lever for lifting, transportation and lowering purposes.

Ergonomically designed handle with comfortable rubber grip allows the optimized safety as well as comfortable.

● Handle Option

Main Feature



High strength chassis design

The high strength chassis and compact design ensure the long life and flexibility. Specifically supported by its perfect metal welding and bending technology, and metal toughness as well.



Security and stability

The hydraulic lifting system of this vehicle adopts the design without oil pipe, which greatly improves the reliability of the hydraulic system and reduces the risk of oil leakage of the joint or oil pipe.

PRODUCT

Product display



Suitable for long distance transportation inside the warehouse
 Suitable for logistics companies

AC25 / AC30

Technical Specification

Model		AC25		AC30	
Load capacity	kg	2500		3000	
Min. fork height h	mm	85	75	85	75
Max. fork height h1	mm	200	190	200	190
Steering wheel	mm	Φ180×50	Φ180×50	Φ180×50	Φ180×50
Load roller Single	mm	Φ80×93	Φ74×93	Φ80×93	Φ74×93
Load roller Tandem	mm	Φ80×70	Φ74×70	Φ80×70	Φ74×70
Size of fork e×s	mm	160×50			
Width overall forks B	mm	450/520/540/685			
Fork length L	mm	800/900/1000/1100/1150/1220			

