

BLE5.0 Synchronize Wireless controller

Dimensions:

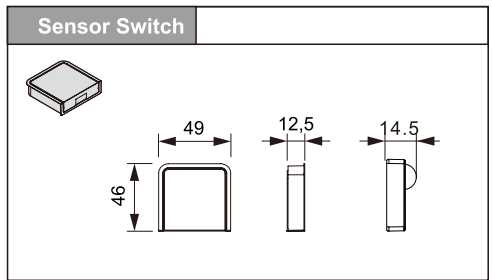

Connection:

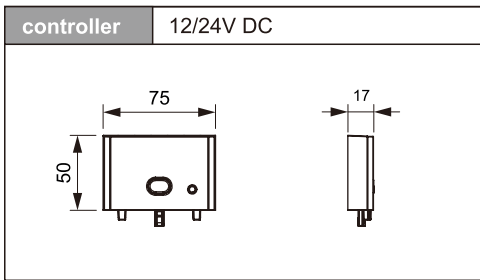
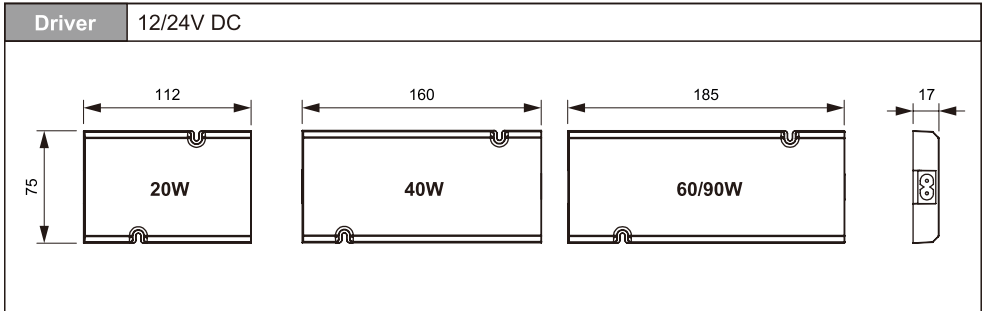
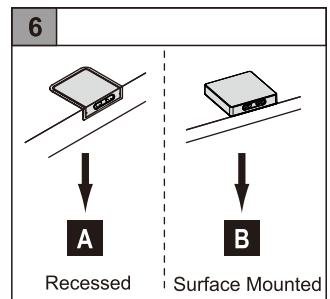
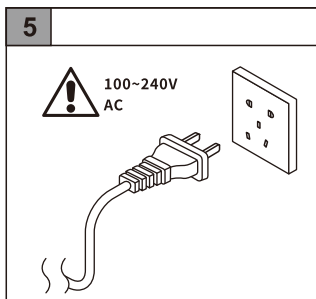
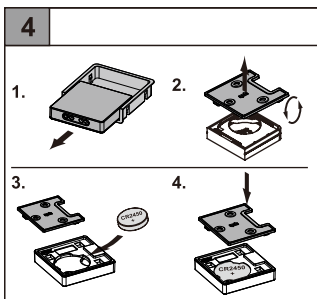
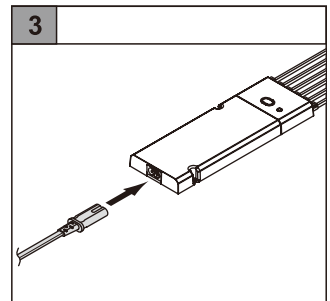
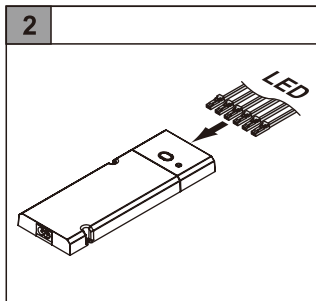
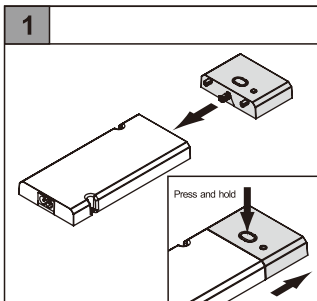

Wireless sensor installation:

A Recessed installation

1

2

3

4

Dimensions: $45 \pm 0,1$, $R = 6$, $11,5 \pm 0,1$, $47,4 \pm 0,1$

B Surface Mounted installation











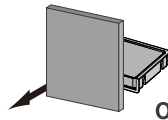
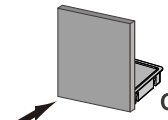
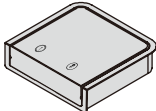

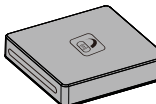
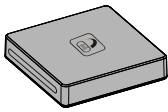
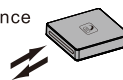
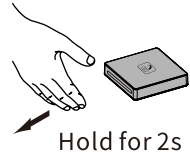

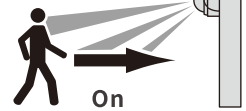
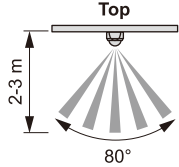
1

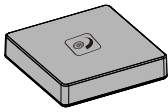
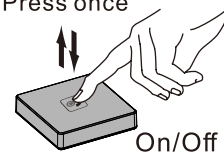
Screw installation

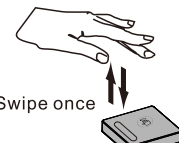
Double-sided tape installation

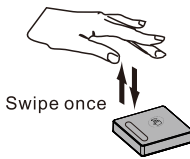
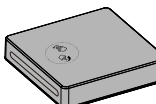
Dimensions: $15,00$, $25,00$, $23,5-26,5\text{mm}$, $9-12\text{mm}$, $5-8\text{mm}$

Wireless sensor function description :

Door sensor	Distance range:0-12cm   On  Off	
Dimming& CCT variable sensor	Press once  Control color temperature Long Press  Control brightness	
Side IR sensor	Distance range:3-12cm On/Off  Swipe once 	 Hold for 2s  Brightness control
PIR sensor	  On  	
Touch sensor	Press once  On/Off Press and hold   Brightness control!	
Front IR sensor	Distance range:3-12cm  Swipe once 	 Hover  Brightness control
Side IR-Touch sensor	Distance range:3-12cm On/Off  Swipe once 	Press once  On/Off  Long press brightness control

Controller match code:

1

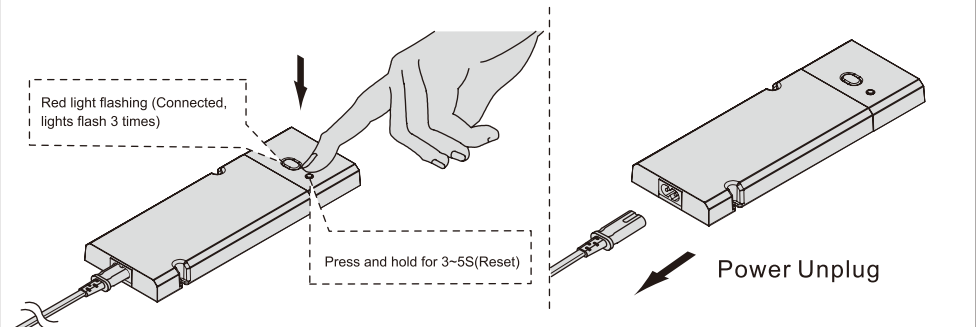

2

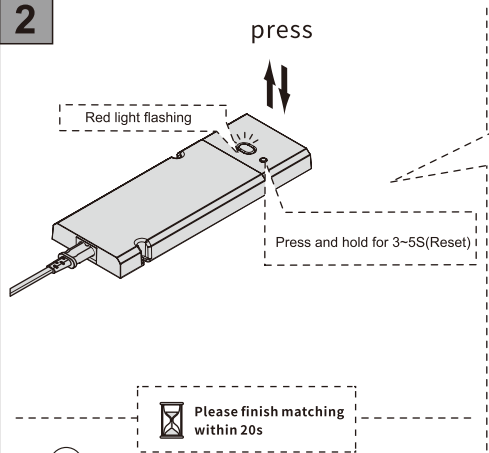

3

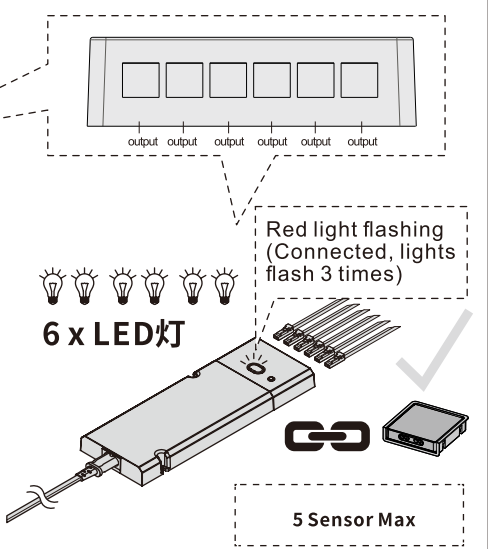

2

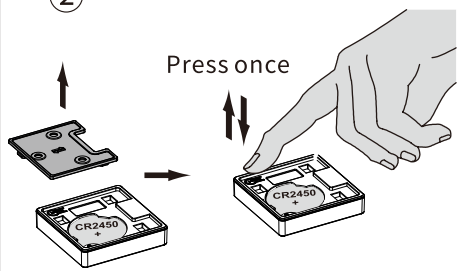

You can only match the same type of door sensor after matching one door sensor, Or it will cause unsuccessful matching. Use the same type of sensor and try again.



Scan the code to view the operation manual