

Atlas_UL AC Commercial Charger

User Manual



EN



Important Safety Instructions

Please read all instructions carefully before using this product.

This document describes the precautions to be paid attention to during the installation, operation, and maintenance of the product. Strictly follow the instructions in this document before installing and using the product.

-  **WARNING:** Before installing or cleaning Atlas Chargers, turn off the input power of Atlas Chargers.
-  **WARNING:** The Atlas Charger must be installed and used through a permanent wiring system or equipment lead.
-  **WARNING:** Do not spray water or other liquids directly into the Atlas Charger. Do not spray water on the charging handle or soak the charging handle in liquid. Do not spray water on the charging base. After charging, please put the charging handle into the protection seat to avoid unnecessary pollution or moisture.
-  **WARNING:** If the wall-mounted connector is defective, cracked, worn, cracked or otherwise damaged, or does not work properly, do not use Atlas Charger and disconnect the input power in time.
-  **WARNING:** If the soft power cord or EV cable is worn, broken or otherwise damaged, or cannot work normally, do not use Atlas Charger and disconnect the input power in time.
-  **WARNING:** Do not attempt to remove, repair, tamper with, or modify the wall-mounted connector. Wall-mounted connectors are not user-serviceable equipment. For any repairs or modifications, please contact the distributor.
-  **WARNING:** Do not insert fingers or foreign objects into any part of the wall-mounted connector.
-  **WARNING:** Before the equipment is powered on, make sure it is well grounded to avoid casualties caused by electric shock.
-  **WARNING:** Before powering on the device, ensure that the input voltage, frequency, and other conditions meet product requirements.
-  **WARNING:** Do not forcibly fold or press any part of the wall-mounted connector or damage it with a sharp object.
-  **WARNING:** Wall-mounted connectors must be installed by personnel trained and qualified to operate electrical systems.
-  **WARNING:** It is strictly forbidden to remove the gun head in the charging process to ensure the safety of life and vehicles in the charging process.
-  **WARNING:** During the charging process, the vehicle is prohibited from driving and can only be charged when stationary. Please turn off the hybrid electric car before charging it.
-  **WARNING:**Atlas_UL AC Commercial Charger can only be used for electric vehicles.
-  **WARNING:**Risk of explosion. This equipment has arcing or sparking parts that should not be exposed to flammable vapors. This equipment should be located at least 460 mm (18 inches) above the floor.

Product specification

| Model | A7-OP-UL-SH | A7-OP-UL-SP | A9-OP-UL-SH | A9-OP-UL-SP | A11-OP-UL-SH | A11-OP-UL-SP |
|---------------------------------------|--|-----------------|-----------------|-----------------|-----------------|-----------------|
| Voltage Range | 120/208/240 VAC | 120/208/240 VAC | 120/208/240 VAC | 120/208/240 VAC | 120/208/240 VAC | 120/208/240 VAC |
| Rated Current | 32A | 32A | 40A | 40A | 48A | 48A |
| Frequency | 50/60Hz | 50/60Hz | 50/60Hz | 50/60Hz | 50/60Hz | 50/60Hz |
| Rated Power | 7.7kw@240V | 7.7kw@240V | 9.6kw@240V | 9.6kw@240V | 11.5kw@240V | 11.5kw@240V |
| Wire | Single phase | Single phase | Single phase | Single phase | Single phase | Single phase |
| Incoming line mode | Hardwired | plug | Hardwired | plug | Hardwired | plug |
| Wire | L1 - L2/N - PE | | | | | |
| The distribution system | TT,TN,IT | | | | | |
| Connector | SAE J1772 (Type 1) | | | | | |
| Operating Temperature | -30℃ to 50℃ | | | | | |
| Humidity | 5 to 95% humidity | | | | | |
| Altitude | ≤2000m | | | | | |
| Residual Current Detection | 20mA CCID | | | | | |
| Enclosure Material | PC-XD2322(f1) | | | | | |
| Type of enclosure | Type 4 | | | | | |
| Weight | ≤10kg | | | | | |
| Product Dimensions | Height: 395 mm (15.6 in) Width: 235 mm (9.3 in) Depth: 110 mm(4.3 in) | | | | | |
| Charging Cable Length (cable version) | 7m (23ft) standard, 5m (16ft) optional | | | | | |
| Ventilation | Don't need | | | | | |
| communication interface | WiFi+Bluetooth+ETH (Standard) 4G (Option) | | | | | |
| Wi-Fi | 2412 to 2462MHz | | | | | |
| Bluetooth | 2402 to 2480MHz | | | | | |
| Northbound agreement | OCPP 1.6J | | | | | |
| Charging mode | RFID&APP | | | | | |
| Safety Protection | Overcurrent, overvoltage, undervoltage, over temperature, sticking relay, ground continuity monitoring, household power use protection, residual current protection, integrated surge protection | | | | | |

Components & Features

Product Enclosure



- 1 **Sweep card area:** The integrated RFID reader allow charging cards scanned. Atlas will read the information on your card to determine whether it is allowed to start or stop charging.
- 2 **Screen:** Display charging status and charging data.
- 3 **LED indicator:** Light in different colors and display mode to reflect the real-time status of the Charger. Read more about its color in chapter ‘LED Indicator Status’.
- 4 **Connector button:** press to unlock the connector.
- 5 **Charging connector:** The cable can directly connect between the Charger and the electric vehicle, insert the charging gun into the vehicle, after finished charging, please insert the charging gun back into the charging seat.
- 6 **Input line of Charger:** Alternating current is fed into the Charger.

Label Information

There is a label on the right side of each Charger with unique information of the product.

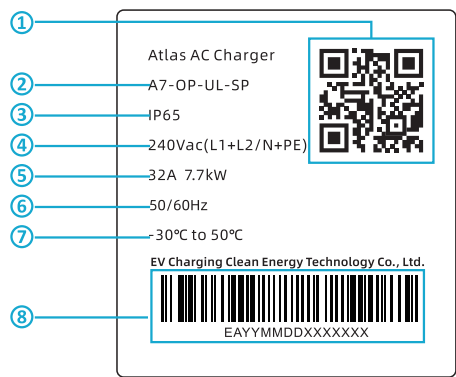

- QR code: Embedded with unique serial number of the Charger, supports scanning to binding and charging.
- Model name
- IP Rating
- Rated voltage
- Rated current
- Frequency
- Operating temperature range
- The serial number: Contain information about the available power rating and production date, can refer to the following instructions.

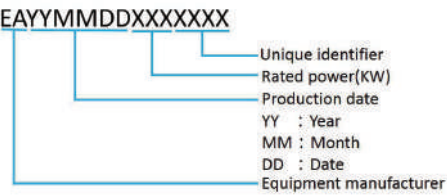

Safety features

Short-circuit protection of the charging cable

In case of short-circuit, the value of I_{2t} at the EV socket-outlet of the Mode 3 Charger shall not exceed 75 000 A2s. In case of short-circuit, the value of I_{2t} at the vehicle connector (Case C) of the Mode 3 Charger shall not exceed 80 000 A2s.

Installation steps

Choose the circuit breaker before installation

For safe use of Atlas Charger and maximum output power, please install circuit breaker as suggestion:

1. A single-phase 40A circuit breaker at the input line of 'A7-OP-UL-SH' or 'A7-OP-UL-SP'.
2. A single-phase 50A circuit breaker at the input line of 'A9-OP-UL-SH' or 'A9-OP-UL-SP'.
3. A single-phase 63A circuit breaker at the input line of 'A11-OP-UL-SH' or 'A11-OP-UL-SP'.

Atlas Commercial Charger is integrated with 20mA CCID leakage protection, you can choose to install a separate residual current device (RCD) type B leakage protection circuit breaker according to your need for a wall-mounted charger.

WARNING: Turn off the power before begin the wiring. Use extreme caution and follow instructions carefully.

Note: Do not open forcibly, it will cause damage to the product.

1 Wall-mounting/Pole-mounting

1. Drill 5 holes using ϕ 10 drill bit on the wall, with a depth of about 60mm. (recommended installation height: 50–150cm)
2. Insert 5 expansion tubes into the fixing hole completely.

For wall-mount, fix the backplate using 5 PA6*50mm tapping screws.

For pole-mount, fix the backplate using 5 M5*16mm combination screws.

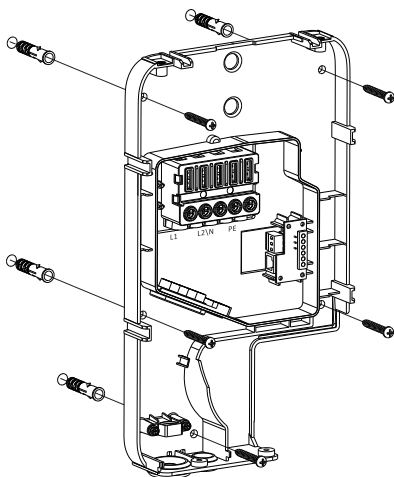
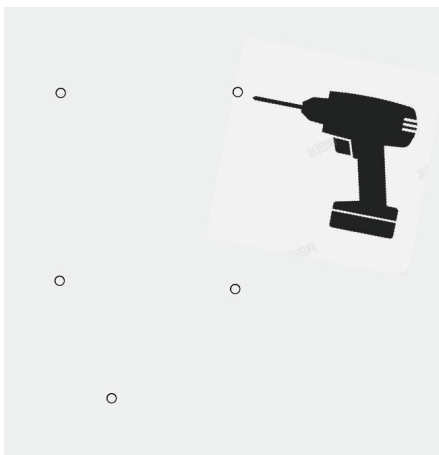

(The UP version skips this step)

2 Wiring

Input power cable

1. Release the two screws which used for fix input power line.

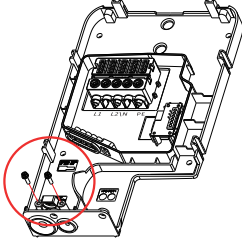

2. Strip the individual wires by about 7 to 10 mm (0.3 to 0.4in). Wrap the terminal blocks in the accessory kit to the core. Use pliers to crimp the terminals firmly.

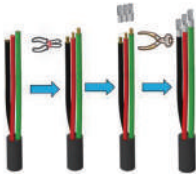

Note: Use Copper or Aluminum Conductors. Ensure that the insulation rubber of the AC input cable is flush with the indicator position on the bottom plate.

3. Pass the input plug through the dust plug and connect the L1-L2/N-PE cable to the corresponding port. The following connection is for the TN grid.

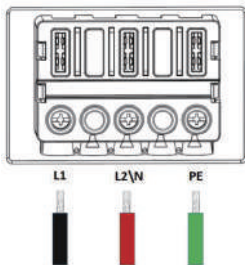

4. After finished wiring input power cable, please lock the 2 screws in step 1 back.



Note: For 7kw require at least 32A cables as input cables.
For 9kw require at least 40A cables as input cables.
For 11kw require at least 48A cables as input cables.

Ethernet line

5. It is recommended to use a network cable of Category 5e or above.

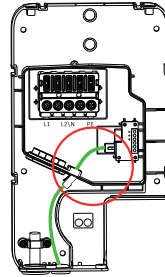

4G network connection

6. Remove 8 screws from back side, and take off the front panel.

Note: There are two wires connected, take care while operating.

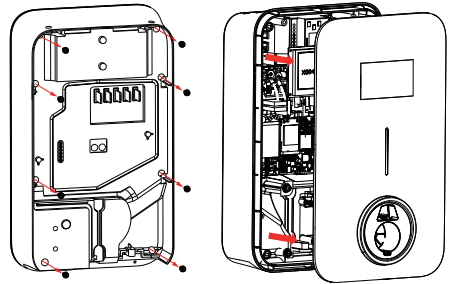

7. Find the card slot and insert the 4G card follow below steps.

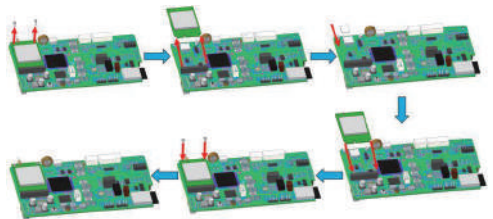

3 Attaching Back and Power on

1. Once all cable have been inserted, install the product body back to backplate and lock the 4 M4*10mm hexagon socket screws.

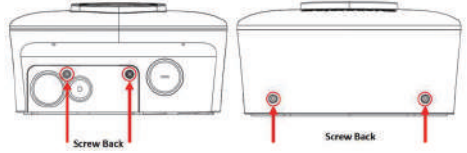
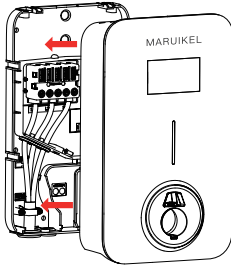

2. Turn on the power. The Atlas Charger now electrically live and will show purple breathing lamp (offline idle).



Networking Configuration

1. Install the configuration tool APP "ChargeDevops" Atlas_Commercial.
2. Open the APP and log in (please contact the distributor for account and password).
3. Open phone's bluetooth, click "START SCANNING" to search for charging stations.
4. Select the charger which serial number is same as label in the list and click 'CONNECT' (default authorization code is 123456).

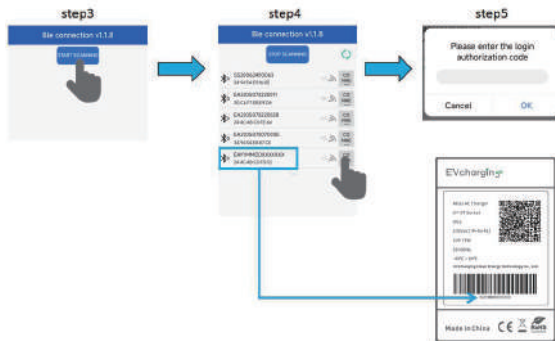

5. Enter 'Network settings' interface. Click 'Networking options' to select the network connection method.
6. If you select 'WIFI' networking, need get into 'WIFI setting' interface to set the WIFI name and WIFI password.

Note: Suggest connect the charger to WIFI in the 2.4GHz band.

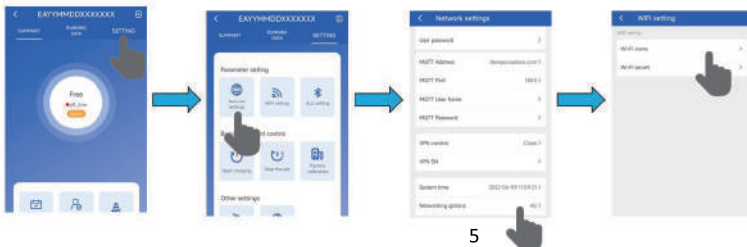

Device Maintenance

Maintenance of the charger must be performed only by qualified personnel per the applicable local regulations. Unauthorized installation and modifications make the manufacturer warranty void.

1 General maintenance

If the product is installed in public spaces and is accessible to everyone, suggest follow the procedures below.











- 1. Ensure that the charger does not have any signs of mechanical damage.
- 2. Visually inspect the Type 2 socket for wear and tear at regular intervals according to local regulations. If the pins are discoloured or damaged, please contact your authorised electrician.

2 Cleaning

The product does not require cleaning to operate properly. Nevertheless, if the product needs to be cleaned for cosmetic reasons, this is possible.

- 1. Use a damp cloth and an all-purpose household cleaner. Avoid using strong chemicals that contain oil or alcohol, as this will discolour the plastic.
- 2. Do not use running water or high pressure water jets.

Status Indicator Light

| | | | | |
|--|--|--|--|--|
| Green breathing lamp Online Idle | Green all bright Online prepare | Purple breathing lamp Offline Idle | Purple all bright Offline prepare | Yellow all breathing reserved |
|  |  |  |  |  |
| Yellow breathing lamp Charging suspension | Green flashing End of charging | Red flashing Error | Red all bright Disable | White water lamp Upgrading |
|  |  |  |  |  |
| Green water lamp In the Charging The higher the charging current, the faster the rhythm of the status indicator. | | Purple water lamp In the Charging If the temperature of the charging pile is too high, the derating charging will turn into a purple water lamp. | |  |

Please feel free to contact us if you have any problem with the charging station.
You can also get the detailed product manual through our official website.
We'd love to hear from you, please reach out to us at.

<http://www.maruiikel.com>





Warranty card

Please fill out the following form clearly

User name: _____

Telephone: _____

Contacts: _____

Postal address: _____

Fax: _____

Production serial number: _____

Equipment model: _____

Distributor: _____

Purchase date: _____

Dear users: in order to protect your legitimate rights and interests, please read the instructions in detail. The company will provide high-quality services for all products.

User unit (Seal)