

TECHNICAL SUPPORT

Having technical problems with this product?

Send an email to
service@meetion.com

For more information please visit:
www.meetion.com

MK009Pro

USER'S MANUAL

Mechanical Keyboard

CONGRATULATIONS ON THE PURCHASE OF MEETION PRODUCTS!

Please read this user's manual before using the unit and retain this user's manual in safe place for future reference.

COPYRIGHT

©2020. MEETION TECH CO., LTD. Version 1.0(V 1.0). This Manual and information contained in it are copyrighted. All rights reserved.

TRADEMARKS

All trademarks are the property of their legal holders

SPECIAL FEATURES

- Wired keyboard, supports key line separation
- RGB color backlight, adjustable brightness
- Hot-swappable mechanical shaft
- OEM height keycaps
- Quick triggering of linear axes
- Fully configured mechanical keyboard
- Adjustable volume knob, supports one-click mute
- Wire length 1.8m

WARRANTY CARD

| | | |
|---|----------------------|----------------------|
| Model No. 型号 | | |
| Date of Sale 购买日期 | | |
| Seller 销售商 | | |
| Serial Number 序列号 | | |
| Address of the Seller 销售商地址 | | |
| Phone of the Seller 销售商电话 | | |
| Seller Signature & Stamp 销售商签字盖章 | | |
|  | | |
| To be Filled in by Service Center 以下由服务中心填写 | | |
| Date of Receipt 收货日期 | Date of Receipt 收货日期 | Date of Receipt 收货日期 |
| Date of Return 返回日期 | Date of Return 返回日期 | Date of Return 返回日期 |
| Special Marks 特殊记录 | Special Marks 特殊记录 | Special Marks 特殊记录 |

TECHNICAL SPECIFICATIONS

| | |
|--------------------|--|
| Model | MK009 pro |
| Colour | Black |
| Number of keys | 104/105+1 |
| Connection method | wired |
| Compatible systems | Win XP/Vista/7/8/10/11 |
| Size | 428*125*40mm |
| Interface | Type-C |
| Driver address | www.meetion.com/driver/mk009pro.html |

MK009PRO KEYBOARD OVERVIEW

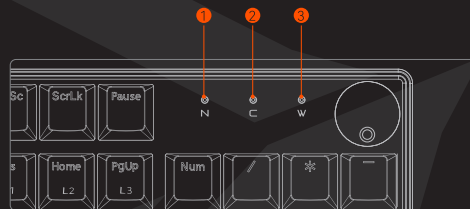

- 1 Number lock indicator: white light stays on when locked
- 2 Caps Lock indicator light: White light stays on when locked
- 3 Win lock indicator light: white light stays on when locked

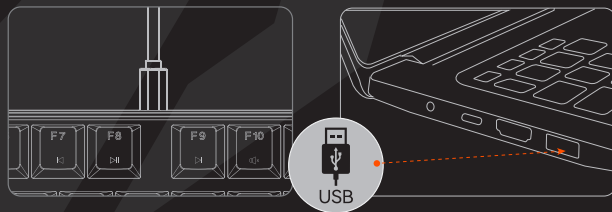
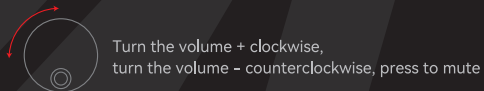

Wired Type-C interface, connect the other end to the PC,
and the keyboard will work normally when it lights up

MK009PRO MULTIMEDIA AND KEY COMBINATION FUNCTIONS

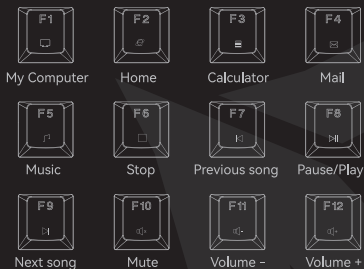

TIP: WINDOWS SYSTEM MULTIMEDIA FUNCTIONS REQUIRE FN COMBINATION!



Fn+W press and hold for three seconds, WASD and up, down, left, and right direction keys are interchanged.



Press and hold Fn+ESC for three seconds to restore factory settings and light effects to default.

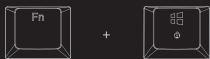

Fn+Win Win lock

MK009PRO RGB BACKLIGHT

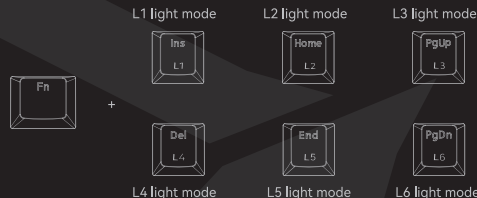

There are three backlight modes in each lighting mode, which can be switched by pressing continuously, for a total of 18 backlight modes.



Adjust keyboard backlight brightness, 5 levels in total



Adjust the keyboard backlight speed, a total of 5 levels



Turn off/on backlight



Switch keyboard backlight flow direction



Switch keyboard backlight color

MK009Pro说明书-骑马钉装订

材质：100g书纸

印刷：四色印刷

成品尺寸：90×120mm