

TECHNICAL SUPPORT

Having technical problems with this product?

Send an email to
service@meetion.com

For more information please visit:
www.meetion.com

Air GW33 USER'S MANUAL

Wireless Gaming Mouse

AIR GW33 BUTTONS DESCRIPTION

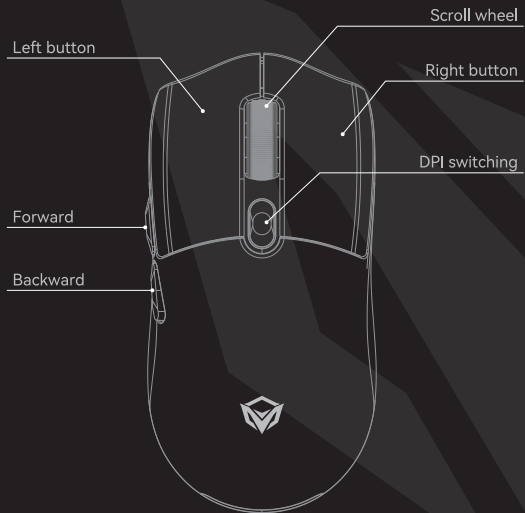

WARRANTY CARD

Model No. 型号		
Date of Sale 购买日期		
Seller 销售商		
Serial Number 序列号		
Address of the Seller 销售商地址		
Phone of the Seller 销售商电话		
Seller Signature & Stamp 销售商签字盖章		Stamp
To be Filled in by Service Center 以下由服务中心填写		
Date of Receipt 收货日期	Date of Receipt 收货日期	Date of Receipt 收货日期
Date of Return 返回日期	Date of Return 返回日期	Date of Return 返回日期
Special Marks 特殊记录	Special Marks 特殊记录	Special Marks 特殊记录

NOTE

- Technical specifications given in this table are supplemental information and cannot give occasion to claims.
- Technical specifications are subject to change without notice due to improvement of MEETION production.
- Technical support by Meetion Tech.



GENERAL

- The safe product, conforming to the US and EU requirements
- The product is made in accordance with RoHS standard. The product is made in accordance with FCC standard. The standard was issued in order to decrease the amount of the electronic and electrical waste emitted into the atmosphere.
- The WEEE symbol (the crossed-out wheeled bin) using indicates that this product is not home waste. You protect the environment when you recycle hazardous waste appropriately. In order to get detailed information about recycling this product, please contact your retailer or a local authority.

AIR GW33

2.4G MODE: SWITCH TO 2.4G MODE AND INSERT THE 2.4G RECEIVER.

Switch to 2.4G mode

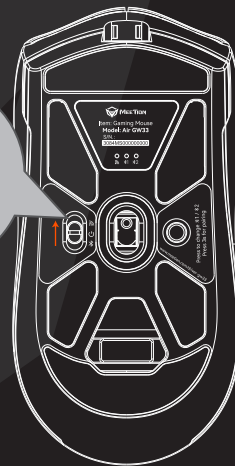
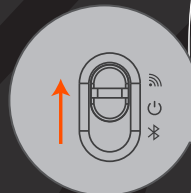

AIR GW33 BLUETOOTH MODE CONNECTION

Step 1

BLUETOOTH MODE: SWITCH TO BLUETOOTH MODE, LONG PRESS THE PAIRING BUTTON FOR 3 SECONDS, BLUETOOTH STARTS PAIRING, AND THE BLUE LIGHT FLASHES.

Switch to Bluetooth mode

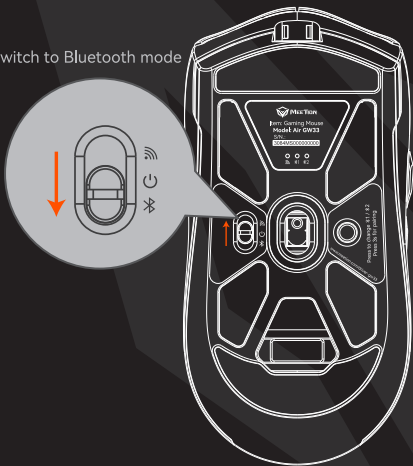

CONGRATULATIONS ON THE PURCHASE OF MEETION PRODUCTS!

Please read this user's manual before using the unit and retain this user's manual in a safe place for future reference.

COPYRIGHT

©2020. MEETION TECH CO., LTD. Version 1.0(V 1.0). This Manual and information contained in it are copyrighted. All rights reserved.

TRADEMARKS

All trademarks are the property of their legal holders

SPECIAL FEATURES

- Supports multiple connection methods: 2.4G+Bluetooth+wired
- Hollow bottom reduces weight
- Maximum 1000DPI adjustable
- Adjustable cool LED lights, 1600 colors
- 1ms ultra-low reaction delay
- Super large battery capacity, can be used continuously for 30 hours
- Local driver can set various mouse parameters

AIR GW33 TECHNICAL SPECIFICATION

Color:	Black/White
Connection method:	2.4G+Bluetooth+wired
Backlight:	RGB Colorful
Resolution:	200~1000DPI
Buttons:	6Keys
Game Type:	FPS/MMORPG/MOBA/RTS
Polling Rate:	125~1000Hz/1ms
Interface:	Type-C
Dimension:	123.4*62*39.5mm
Weight:	64g
Battery capacity:	650mAh
Charging time:	2-3 hours
Software:	www.meetion.com/driver/gw33

AIR GW33 BLUETOOTH MODE CONNECTION

Step 2

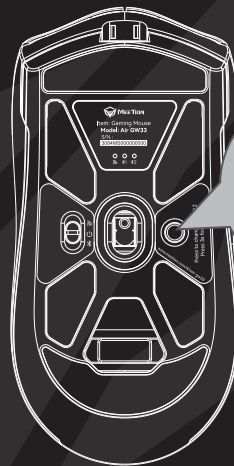

Short press to switch Bluetooth channel,
long press to pair Bluetooth

AIR GW33 BLUETOOTH MODE CONNECTION

Step 3

Add a device

Add a device

Make sure your device is turned on and discoverable. Select a device connect.

OnePlus 7TPro

MEETION MS_BT1

Turn on Bluetooth on the PC and find the Bluetooth name "MEETION MS-BT1" and click on pairing. The blue light stops flashing to indicate successful connection.

AIR GW33 CHARGE

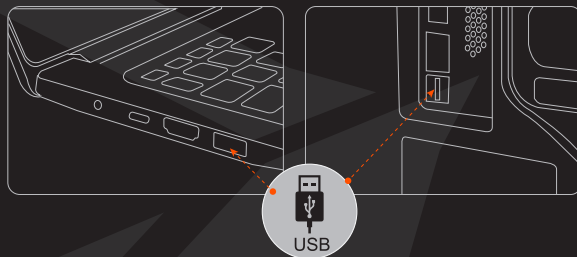

Insert one end of the included cable into the mouse and the other end into the PC. The indicator light flashes three times to indicate that charging has started.

This red light is blinking, the battery is low.

This red light is always on, the battery is charging.

This green light is always on, battery is fully charged.

Tips: The maximum charging voltage for this product is 5V!

Tip: Plug in the included cable to switch to wired mode, which can be used while charging.

Air GW33说明书-骑马钉装订

材质：100g书纸

印刷：四色印刷

成品尺寸：90×120mm