

ROCKBEN 岩本®

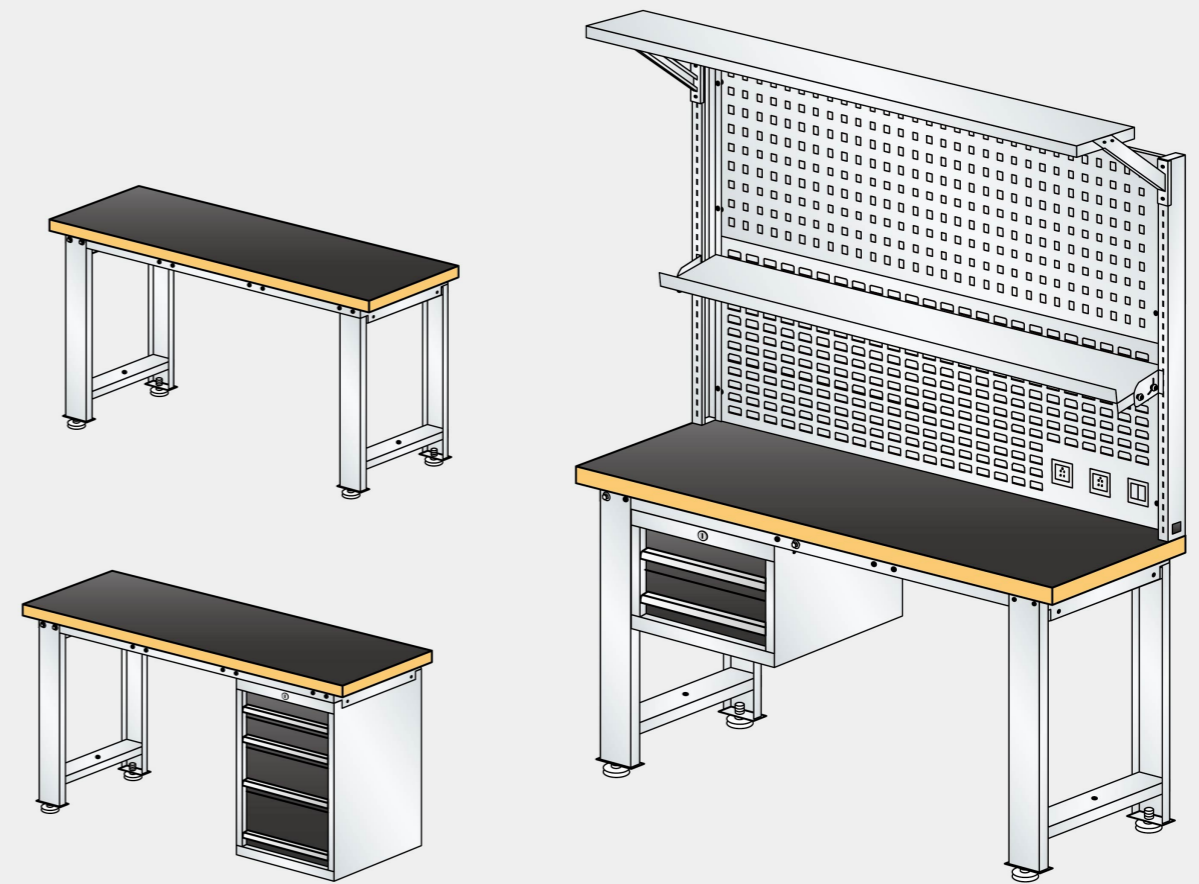

ROCKBEN 岩本®

Heavy-duty Workbench



Shanghai Rockben Industrial Equipment Manufacturing Co., Ltd.

Installation Manual

Shanghai Rockben Industrial Equipment Manufacturing Co., Ltd.



! Safety Notice:

- 1、 Please read this installation manual carefully before assembling.
- 2、 Our company reserves the right to modify the product specifications and structures without prior notice.
For any updates, please refer to the latest official documentation or consult our customer service.

Installation Preparation

01 STEP Worktop

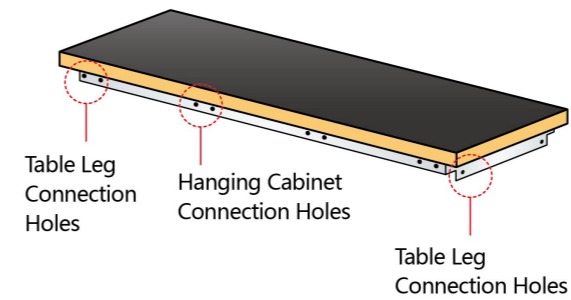

02 STEP Table Legs

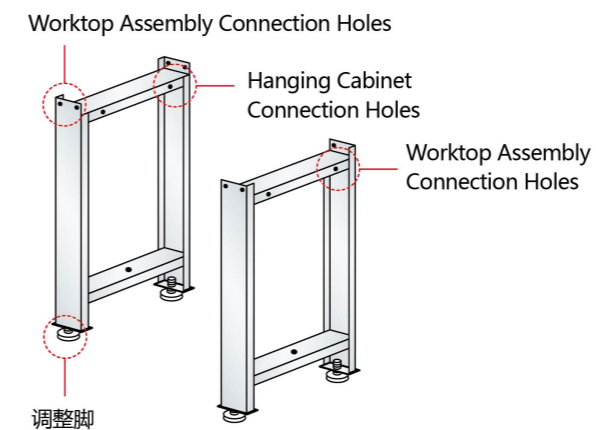

03 STEP Cabinet Reinforcement Panel

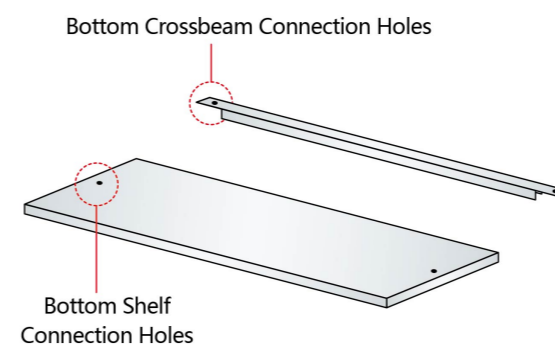

04 STEP Hanging Cabinet / Base Cabinet

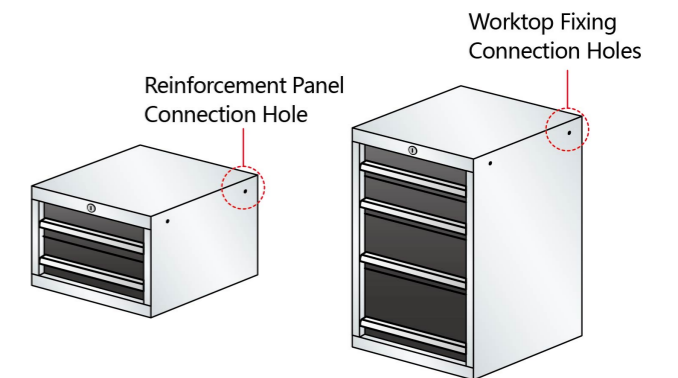

05 STEP Cabinet Reinforcement Panel

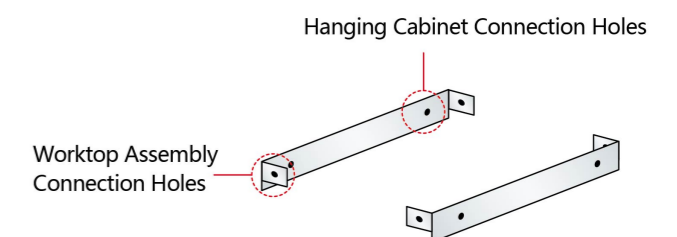

06 STEP Hanging board combination

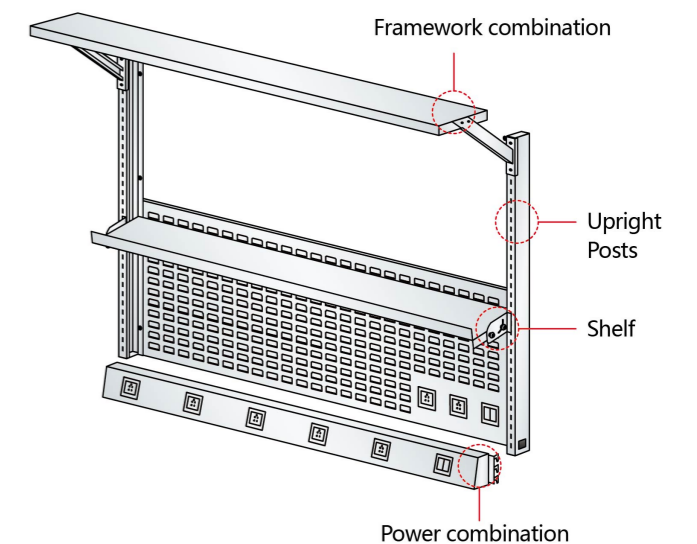

! Connection holes and connection pins come as standard factory configuration.

Standard Workbench Installation

ROCKBEN 岩本®

Hanging Cabinet Workbench Installation

ROCKBEN 岩本®

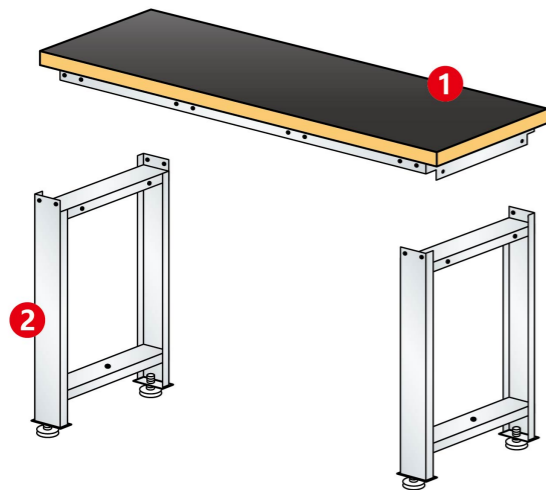

01
STEP

Installation Preparation

1. Worktop (work surface + support frame)
2. Table legs (x2).

02
STEP

Initial Installation

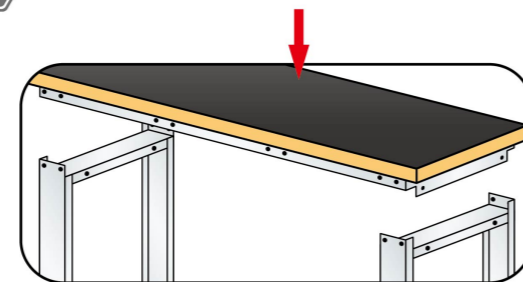

1. Place the worktop in the designated position.
2. Align the table legs with the worktop and position the holes accordingly.

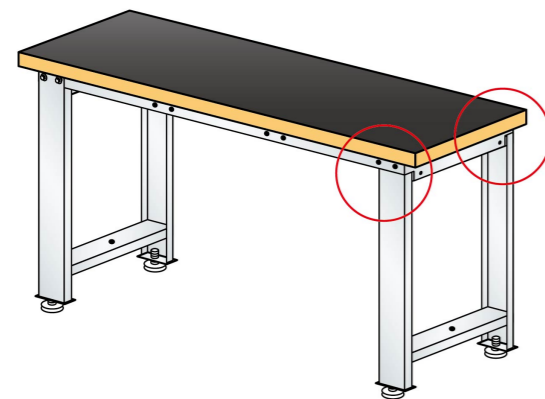

03
STEP

Securing the Table Legs

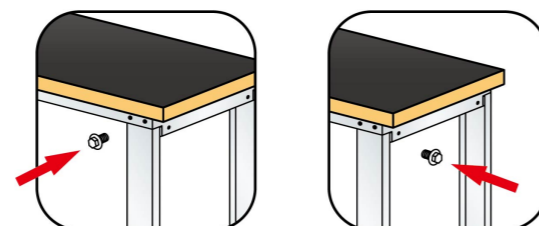

1. Align with the left and right fixing holes and tighten with screws.

Installation of optional accessories

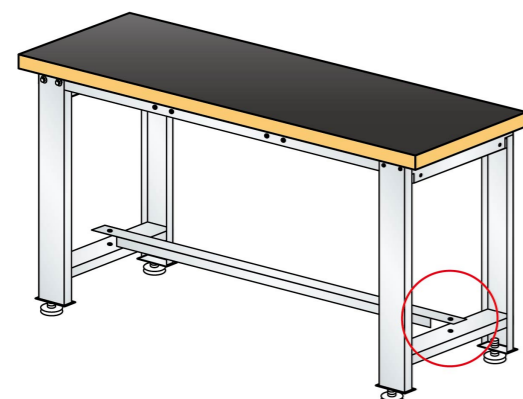

04
STEP

Table Leg Crossbeam / Bottom Shelf Installation

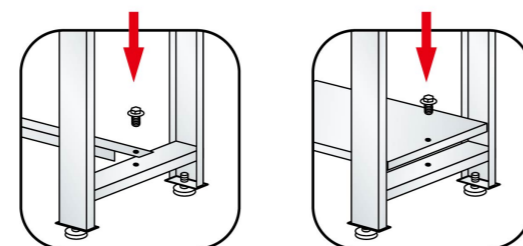

1. Attach the bottom beam / bottom panel onto the left and right crossbeams of the table legs.
2. Align with the left and right fixing holes and tighten with screws.

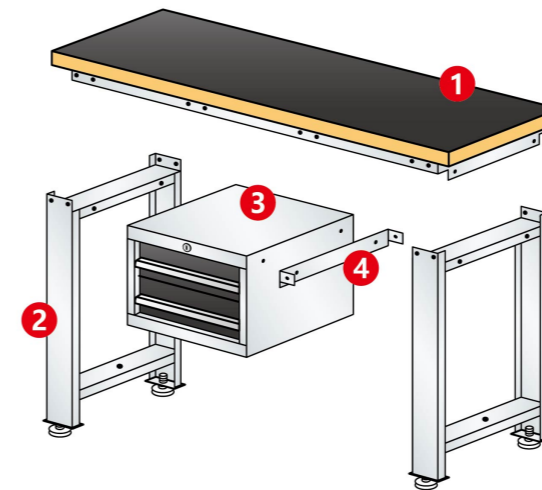

01
STEP

Installation Preparation

1. Worktop (work surface + support frame)
2. Table legs (x2)
3. Hanging cabinet
4. Cabinet reinforcement panel.

02
STEP

Hanging Cabinet Installation

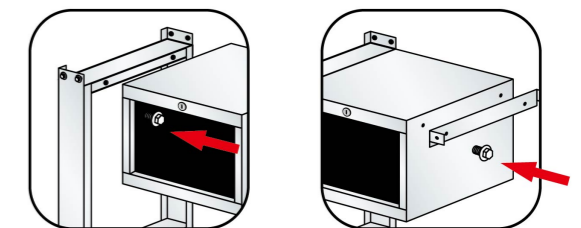

1. Remove the drawer, then secure the cabinet to the table legs using screws
2. Attach the cabinet reinforcement panel to the drawer using screws.

03
STEP

Securing the Table Legs

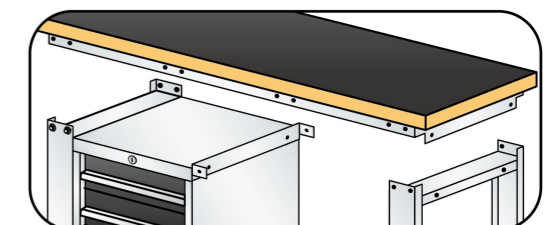

1. Position the table legs in place, then place the worktop assembly over them.
2. Align the corresponding holes and secure with screws.

Installation of optional accessories

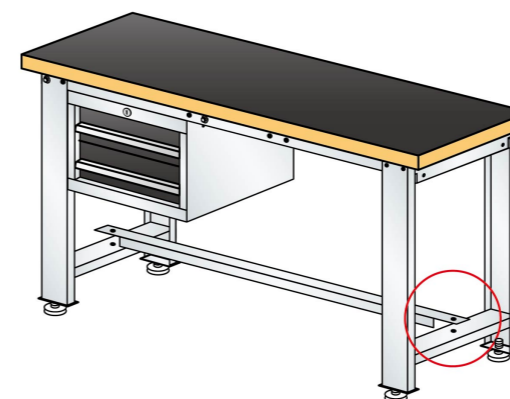

04
STEP

Table Leg Crossbeam / Bottom Shelf Installation

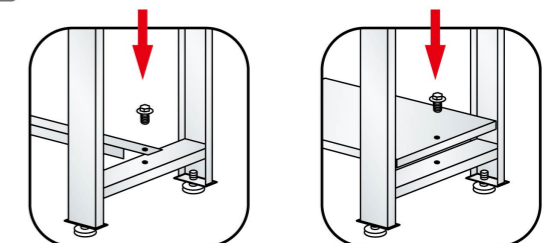

1. Secure the crossbeam / bottom shelf to the lower sections of the table legs.
2. Align with the left and right fixing holes and tighten with screws.

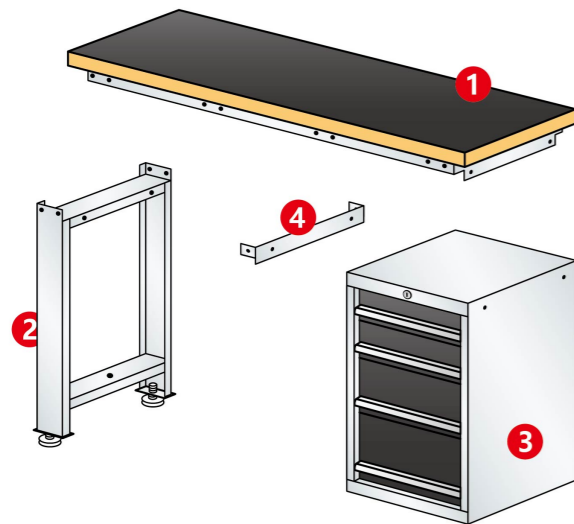

01 STEP Installation Preparation

1. Worktop (work surface + support frame)
2. Single Table leg
3. Single Base Cabinet
4. Cabinet reinforcement panel

02 STEP Table Leg Installation

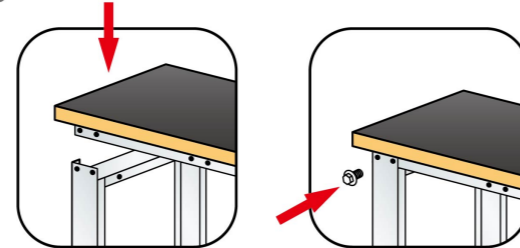

1. Insert the lower support frame of the worktop into the table leg slot.
2. Align the front and rear screw holes, then tighten the screws to secure.

03 STEP Base Cabinet Installation

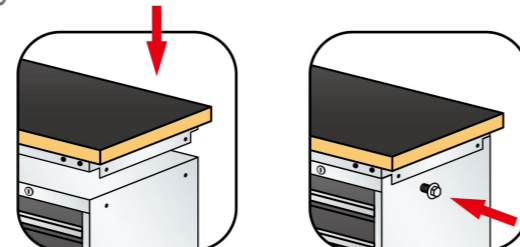

1. Insert the lower support frame of the worktop into the table leg slot.
2. Align the front and rear screw holes, then tighten the screws to secure.

04 STEP Cabinet Reinforcement Panel Installation

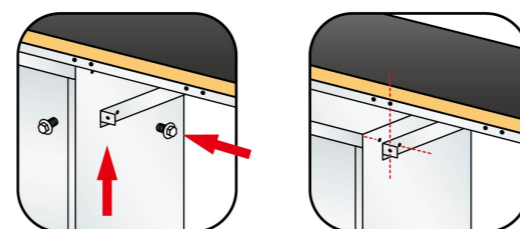

1. Align the cabinet reinforcement panel with the worktop support frame and the base cabinet.
2. Align the left and right screw holes, then tighten the screws to secure.

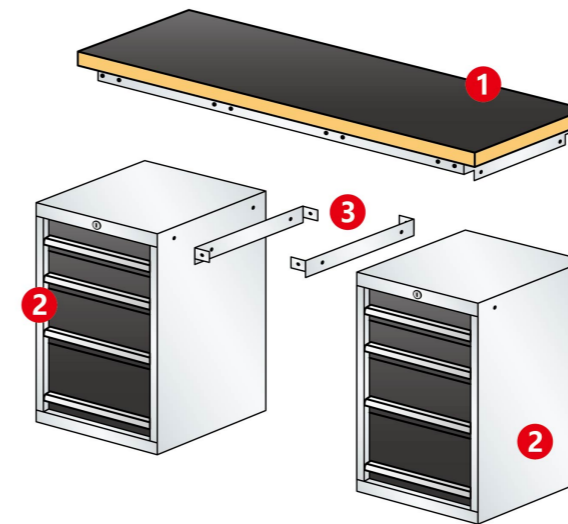

01 STEP Installation Preparation

1. Worktop (work surface + support frame)
2. Base Cabinets (x2)
3. Cabinet reinforcement panels (x2)

02 STEP Initial Installation

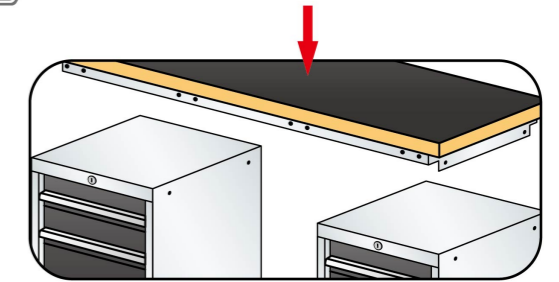

1. Position the base cabinets in the designated locations.
2. Place the worktop on top of the base cabinets, aligning the corresponding holes.

03 STEP Base Cabinet Installation

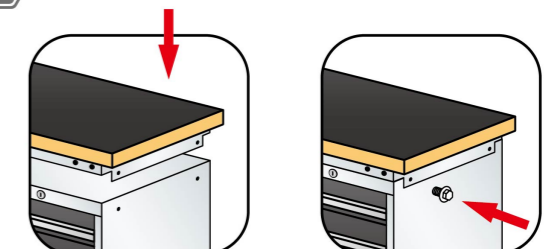

1. Align the left and right screw holes, then tighten the screws to secure.
2. Repeat for both cabinets on either side.

04 STEP Cabinet Reinforcement Panel Installation

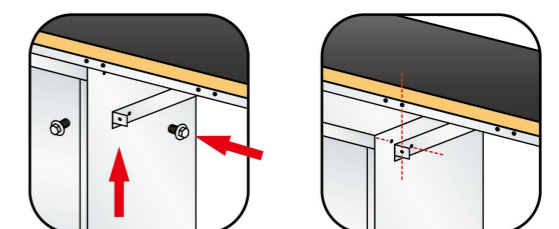

1. Align the cabinet reinforcement panels with the worktop support frame and base cabinet screw holes.
2. Align the left and right screw holes, then tighten the screws to secure.

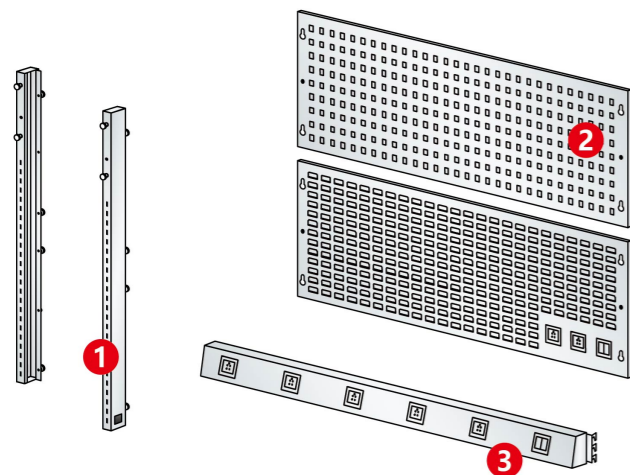

01 STEP Installation Preparation

1. Upright Posts ;
2. Pegboard;
3. Power Supply Box;
4. Lamp Holder;
5. Adjustable Shelf.

02 STEP Upright Post Installation

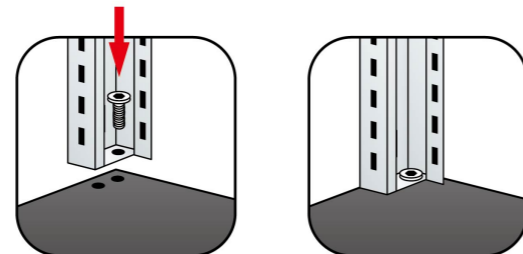

1. Align the bottom holes of the upright posts with the corresponding holes on the worktop.
2. Tighten the screws to secure both upright posts.

03 STEP Pegboard Installation

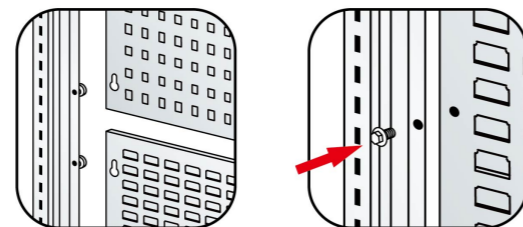

1. Insert the pegboard into the connection pins on the upright posts from the rear side, then press down to lock it in place.
2. Screws can be used in the middle section of the pegboard to further secure it.

04 STEP Power Supply Box Installation

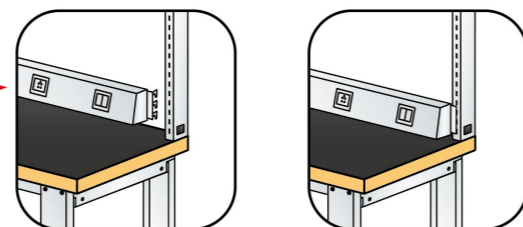

1. Insert the power supply box card slot into the slot on the upright post.

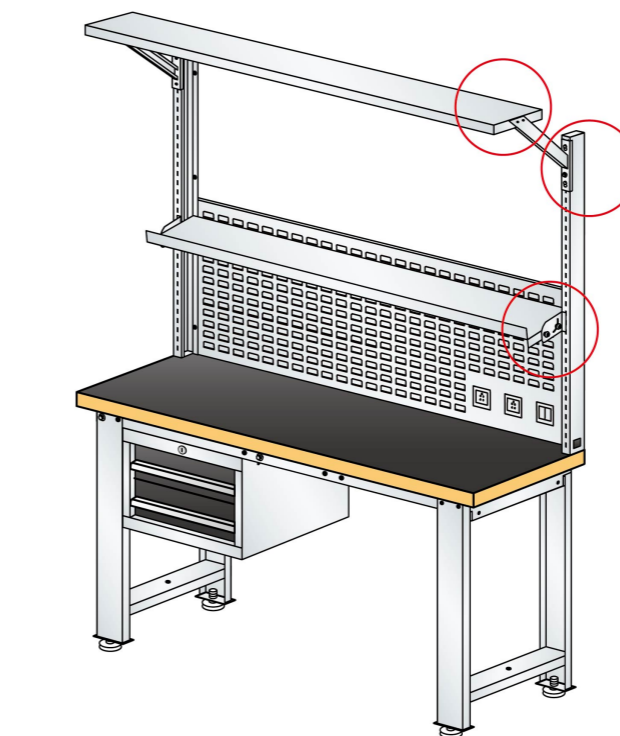
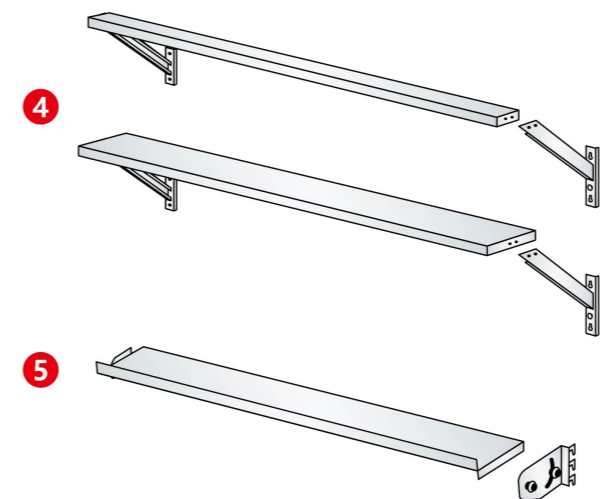

05 STEP Lamp Holder Support Bracket Installation

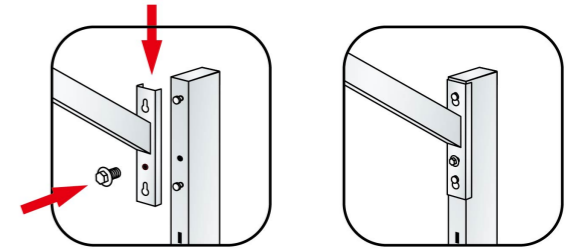

1. Insert the lamp holder support bracket into the upright post connection slots and press down to lock.
2. Secure the support bracket to the upright post using screws.

06 STEP Lamp Holder Installation

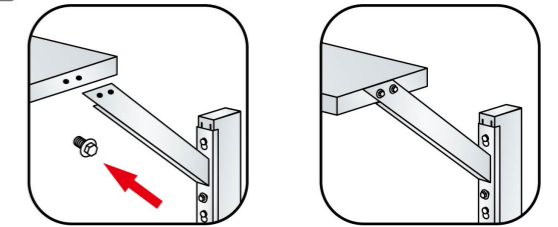

1. Place the lamp holder on top of the light bracket support.
2. Align the screw holes and secure with screws.

07 STEP Adjustable Shelf Installation

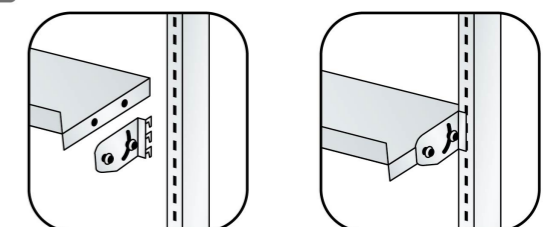

1. Insert the shelf tabs into the upright post slots.
2. Secure the baffle panel position and angle using screws and adjustable knobs.

