



L9

E-SCOOTER MANUAL

Shenzhen Rulind Electronic Technology Co., Ltd

Introduction

Thank you for choosing our L9 electric scooter. Electric scooter is a fashion sports equipment. It is easy to drive and it uses quality parts and accessories to achieve best performance. It will bring you a lot of joy and fun.

Directory

1.Product and parts	01
2.Functional diagram	02
3.How to assemble	03
4.How to Charge	04
5.Learn to drive	04
6.Safety instructions	06
7.Fold and Carry	08
8.Daily maintenance	09
9.Specification	11
10.Harmful Names and Contents in Products	12
11.Warranty policy	13

1 Product and parts

Vehicle

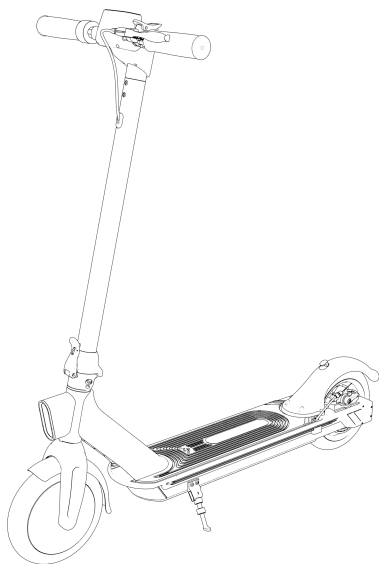

Parts

Extension nozzle

Screw*4

Hex wrench

Charger

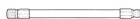

2 Functional diagram

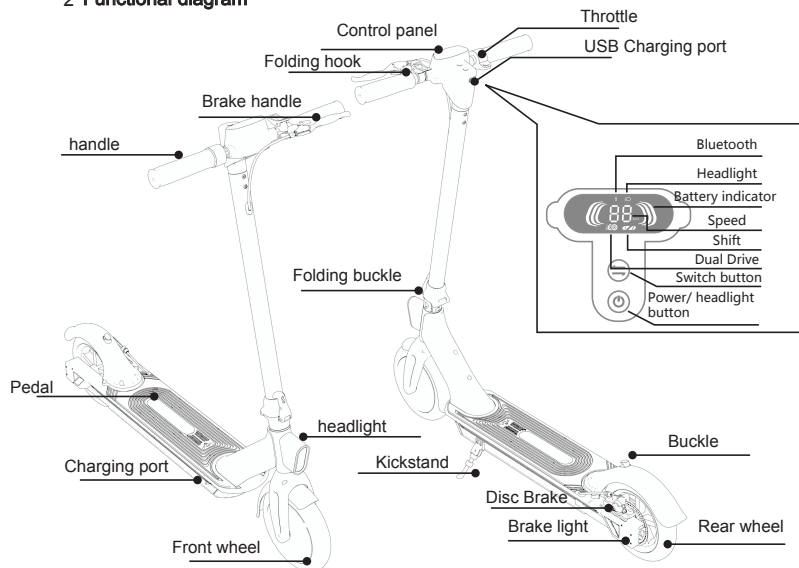

	: Bluetooth icon is lit to indicate successful connection
	: Headlight
	: Battery indicator The battery level is decreasing from outside to inside, when it shows orange color, means you should charge the scooter immediately before use.
	: Shows the driving speed
	: “” : Dual drive “” : Front wheel drive (FWD) “” : Rear wheel drive(RWD) ①
	: “” : Level 1 “” : Level 2
	: 1.Click on the button “” Switch between Level 1 and Level 2 2.Long press the button “” Switch drive mode FWD RWD
	: 1.Turn on “” Long press power button for 2 seconds, “” Press and hold for 2 seconds again to turn off. 2.Click on the button to turn on the headlight, click on the button again to turn off the headlight.

Note:① According to the model of the vehicle, the single drive version scooter cannot switch to dual drive.

3 How to assemble

1. Secure the long pipe of the scooter and put down the kickstand

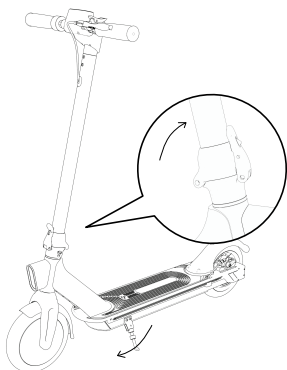

2. Install the handlebar

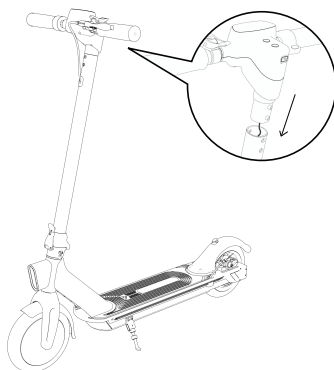

3. Use the hex wrench to lock the screws on both sides

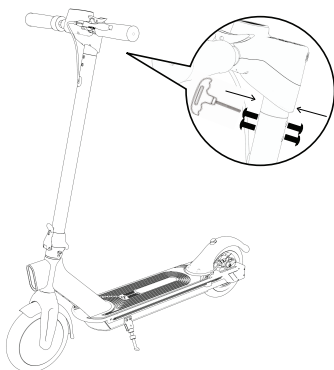

4. Make the on-off inspection after assembly

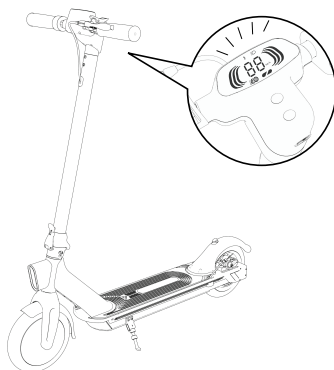

4.How to charge

- 1.open the rubber plug
- 2.Insert the charging plug
- 3.Tighten the rubber plug after charging finished.

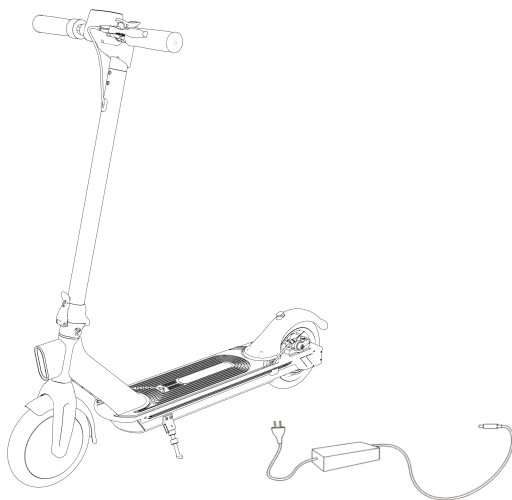

5 learning to drive

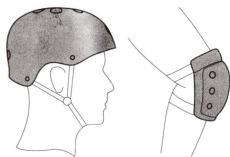

To avoid injury, please wear helmets and protective equipment when drive outside.

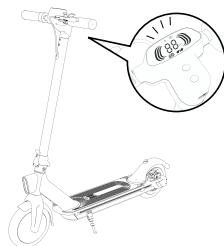

- 1.Check the battery indicator

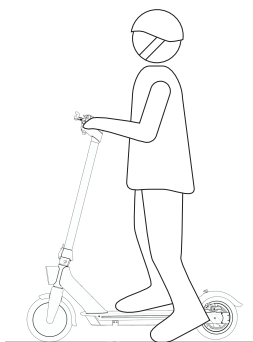

- 2 Stand on the pedal with one foot, and push the other foot backward

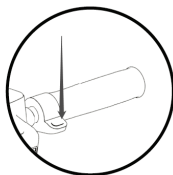

- 3 When the electric scooter slides, move your other foot on the pedal and stay steady. Then gently hit the throttle (need more than 3km / h speed)

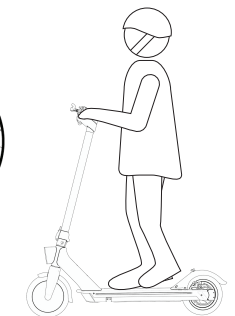
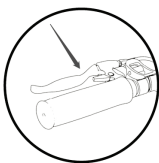

- 4 To slow down, you can release the accelerator/throttle. For emergency braking, the front brake handle of the left handlebar shall be firmly grasped.

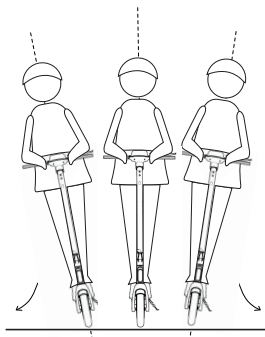

- 5 When turning, lean the body slightly towards that direction, and slowly turn the handle.

6 Safety instructions



Safety hazards to be avoided

- 1 Please avoid riding in the rain
- 2 in case of unconventional road surface such as deceleration belt / Elevator threshold / pothole Road, please do not pass through at high speed. Please keep the medium and low speed (5-10km / h) on the rough road. A little knee bending can make you better adapt to the above complex road surface
- 3 Avoid hitting the head against the door frame, elevator and other high obstacles
- 4 Do not press the accelerator when walking with the electric scooter.
- 5 Please avoid obstacles when riding.
- 6 do not hang backpacks and other heavy objects on the handlebars
- 7 do not put one foot on the pedal or the ground while riding



Do not attempt dangerous actions

1. It is forbidden to ride into the motorway and residential areas with mixed flow of vehicles and people.
2. Do not rotate the handlebar during high-speed driving.
3. do not drive in water more than 2cm
4. It is forbidden to ride on the scooter with 2 persons or hold a child.
5. It is forbidden to step on the end of fender.
6. do not touch the brake disc
7. Do not release the handlebar when driving.
8. it is forbidden to ride the electric scooter up or down steps or jump obstacles

Safety instructions

- Electric scooter is one kind of entertainment sport tools instead of a vehicle. It will become the public transportation when you ride it into the public area. So there are also have the same safety risks with all other vehicles. Driving according to instructions of the manual strictly will protect you and others, and also obey the national and provincial traffic rules will reduce the safety risks.

- At the same time, you need to understand that once you drive the electric scooter on public roads or other public areas, even if driving strictly with the safety guide, you may also face risks caused by illegal driving /wrong operation of others. Just like walking or cycling, you may be injured by others; like all vehicles, the faster you drive an electric scooter, the longer time it takes to brake, and emergency braking on the smooth ground may also cause the wheel to slip and lose balance or even fall. So, it is very important to keep vigilance, proper speed and a safety distance with other people and vehicles. When driving into unfamiliar area, please Be care and ride slowly.

- Please respect the pedestrians' rights when riding. Do not scare the pedestrians, especially children. When passing behind a pedestrian, press the bell to remind the pedestrian and slow down. Passing from the left side as many as possible, (for countries where the vehicle is driven to the right). Keep the right side right and slow down when meeting the people.

- Please do strictly follow the safety manual when driving in China and other countries without specific relevant rules and standards on electric scooter. The company will not assume any direct or joint responsibility for all financial, losses, accidents, legal disputes and other adverse events resulting in conflicts caused by violation of the manual

- Do not lend the electric scooter to people who do not operate it+, So as to avoid Injury. When borrowing your scooter to your friends, Be sure to be responsible for the safety of your friend, teach him or her and tell him or her to wear safety equipments.

Please do basic inspection before driving each time.

When the situations like Looseing parts, Low battery, leaking tire or tire wear, abnormal noise, broken brake, please stop using immediately

7 Fold and Carry

Fold

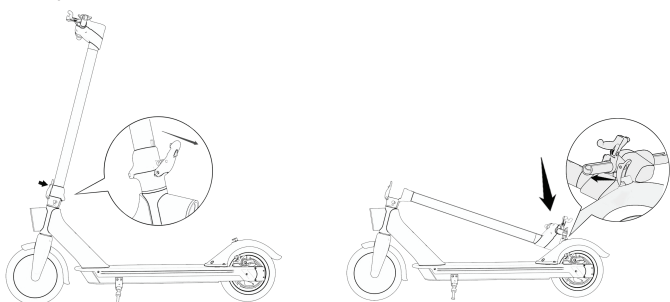

Open

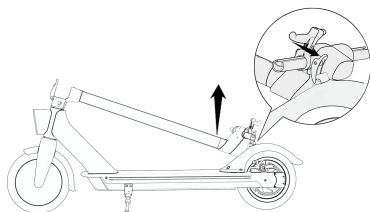

First, Make Sure the power is off. Second, Hold the tube when open the folding button, Then Find the position of folding hook, and Fix the folding hook to the rear fender.

When opening, First, Press the folding hook, Then hold the vertical pipe and lock the folding button.

Carry

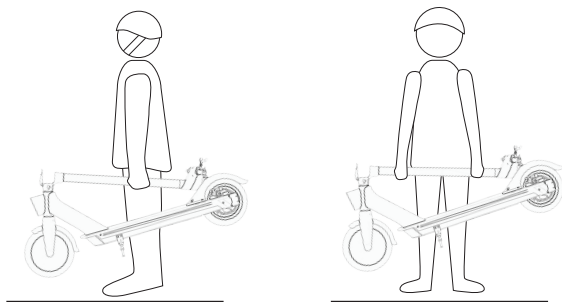

After folding, carry with one or both hands by holding the tube



Please don't carry by handling the rear mudguard

8 Daily maintenance

Cleaning and storage of electric scooter

If there is a stain on the surface of the electric scooter, use soft cloth with clean water to wipe it; if there is a stain that is difficult to clean, use toothpaste to smear it and brush it repeatedly, and then clean it with wet cloth.

If plastic parts of the scooter are scratched, they can be polished with sandpaper or other abrasive materials.

Note: do not use alcohol, gasoline, kerosene or other corrosive and volatile chemicals for cleaning, otherwise the appearance and structure of the scooter will be seriously damaged. It is forbidden to use the pressure water gun to spray and wash, and ensure that the electric scooter is off and the cable has been pulled out and the rubber cover of the charging buckle has been tightened, otherwise it may cause electric shock or serious fault due to water inflow. Try to store the electric scooter in a dry and cool place indoors when not using. Do not store it outdoors for a long time. The outdoor environment such as sun exposure / overheating / supercooling will accelerate the appearance of electric scooter, age the tire and reduce the battery life.

Battery maintenance of electric scooter

1. Do not use other module or brands's battery in order to avoid risks.
2. Do not touch the battery contacts, disassemble or puncture the shell of battery. Avoid short circuit caused by metal objects contacting battery. Failure to do may result in battery damage or personal injury.
3. Be sure to use original charger for charging, otherwise there is danger of damage or fire.
4. Improper disposal of wasted battery may seriously pollute the environment. In order to protect environment, Please follow local regulations when disposing the battery pack. Do not discard the battery pack randomly.
5. Please fully charge the battery and store it after finished driving, Which can extend the battery life. Do not store the battery in a high temperature environment higher than 50 °C or a low temperature environment of - 20 °C (for example, do not put the electric scooter or other battery packs in summer). Do not put the battery packs into the fire, otherwise the battery may fail, overheat, or even have a fire risk. If it is not used for more than 30 days, please fully charge it, store it in a cool and dry place and fully charge it every 60 days.

In order to avoid recharging when the power is completely exhausted, and try to use it after charging, which can greatly extend the life of the battery. In addition, the battery pack can play a higher range and performance when used in the normal temperature; and if used in the environment lower than 0 ℃, the battery life and performance will decline. Typically, at - 20 ℃, the range may be half or less than that in the normal temperature. After the temperature rises, the battery mileage will be restored. Exactly data, Please refer to the content in the app.

Tip: after fully charged, the electric scooter will run out of power after 120-180 days of standby. There is a smart chip inside the battery to record the charge and discharge of the battery. If the battery is not charged for a long time, it cannot be recharged. Excessive discharge of battery will cause the damage, Such damage can't be fixed and is out of free maintenance.

(Note: non-professional person should dismantle the battery pack, otherwise it may lead to electric shock or short circuit, leading to serious safety accident!)

Disc brake adjustment:

1. If the brake is too tight, use M5 hex wrench to loosen the screw of wire pressing plate on the disc brake base anti-lockwise, and return the brake line to the exposed tail. If the brake is too loose, loosen the screw and drag the brake line to expose the tail. Slightly longer, lock the screw of pressing wire board.

Handlebar shaking debugging

1 if the vertical tube of your electric scooter shakes during riding, please use M5 hex wrench to lock the two screws at the folding mechanism

Extended nozzle use

1 if the front and rear wheels of your electric scooter are short of air, please use the extended air nozzle attached with the car to connect the tire air nozzle of the car body.

First, screw off the front and rear tire inflation nozzle cap, then use the extended inflation nozzle and tire inflation nozzle to tighten, and then connect the air cylinder to inflate after tightening.

9 Specification

Parameters	project	electric scooter parameters
Parameters	L × W× H (mm)	1130*500*1150mm
	Folded size L × W× H (mm)	1130*500*480mm
Product weight	vehicle mass (kg)	about 14.0kg
Target Audience	Max. load	120kg
	Age range of application	16-50years old
	Applicable height	120-200cm
Main parameters	Maximum speed (km / h)	about 25
	Typical endurance (km / h)	about 30
	Maximum gradient (%)	about 15
	Suitable terrain	cement and asphalt pavement, flat dirt road
	Working temperature (℃)	-10-40
	Storage temperature (℃)	-20-45
	Protection level	IP54
Battery	Rated voltage (VDC)	36V
	Max.charging voltage (VDC)	42V
	Rated capacity (WH)	350
	Intelligent battery management system	temperature abnormal / short circuit / under voltage automatic sleep / overcurrent / double overcharge / double over discharge protection
Motor	Rated power (W)	350
	max .power (W)	550
	Rated power (W)	71
	Rated input voltage (VAC)	100-240V~
	Rated output voltage (VDC)	42

Charger	Rated current (A)	1.5
	Product certification	CCC,ROHS
	Charging time (h)	about 5 hours

10 Name and content of harmful substances in products

Part Name	Harmful Hazardous substances					
	lead (pb)	mercury (Hg)	cadmium (Cd)	Hexavalent chromium (Cr[VI])	Polybrominated biphenyls (PBB)	Polybrominated diphenyl ether (PBDE)
Charger	×	0	0	0	0	0
Battery	×	0	0	0	0	0
Air nozzle	×	0	0	0	0	0
Charging port	×	0	0	0	0	0
Main control board	×	0	0	0	0	0
Instrument circuit board	×	0	0	0	0	0
Hub motor	×	0	0	0	0	0
Frame	0	0	0	0	0	0
Tire and wheel	0	0	0	0	0	0

This form is prepared in accordance with SJ / t11364.

0: It means that the content of the harmful substance in all homogeneous materials of the part is below the limit requirements specified in GB / T 26572.

×: it means that the content of the hazardous substance in at least one homogeneous material of the part exceeds the limit requirements specified in GB / T 26572

11 warranty policy

Friendly tips:

As the packing box is required to ensure the safety transportation, we suggest you keep the packing box for at least 15 days since from you receive the goods.

Warranty content

Type	warranty content	t i m e
Main parts	Frame assembly, hub motor, controller, Handle bar, forehead body, middle cabin instrument panel, rear hub, brake disc, disc brake assembly, folding system, brake cable	1 year
Accessory	battery, charger, brake bar	6 months
Appearance wearing parts	Anti collision strip, headlight assembly, instrument cover, handle cover, tire, bell, fender, rear tail lamp, decorative cover, kickstand, battery holder plate, foot pad, charging port seat, rubber plug	3 months

Note: Hex wrench and extended air inlet nozzle are the random product consumables, no warranty period.

L9 APP

1. Connect the scooter

1.1

Open the app and select "log in"

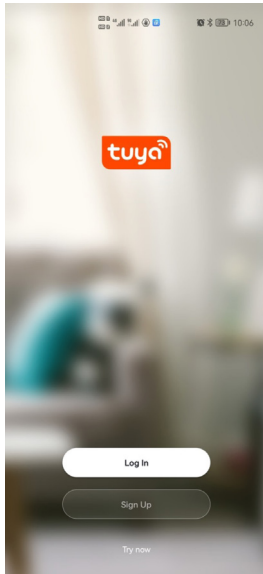

1.2

After login is successful, an update for the interface will be prompted. Close the interface once the update is completed.

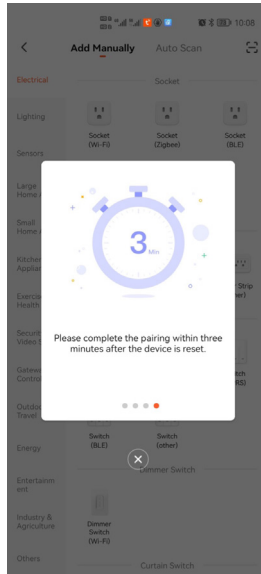

1.3

Click the button on the top right hand corner (+) to add device

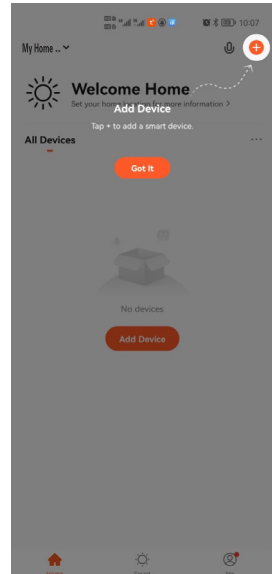

1.4

Click Add Manually at the top of the screen

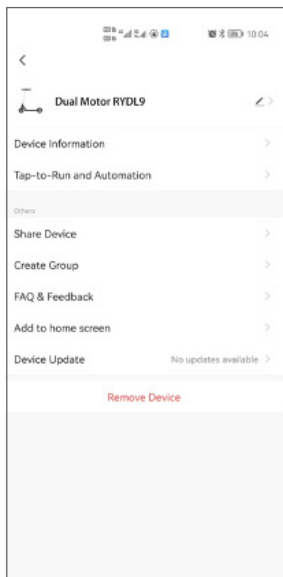

1.5

Select the "Access location" and "Enable Bluetooth", and then click "Start Scanning"

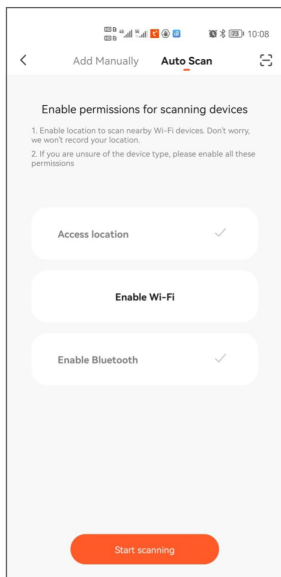

1.6

After searching, an available device that can be connected appears, click "Next"



1.7

As shown in the picture, the status is "connecting". Once the connection is established, it will automatically add the device to the home page. Subsequently, the next time you open the app, you can directly select the device.

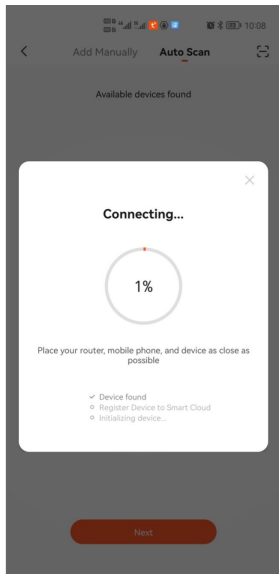

1.8

Lastly, click "done" to complete



2. Unpair the Scooter

2.1

Select the icon in the upper right corner of the app panel.

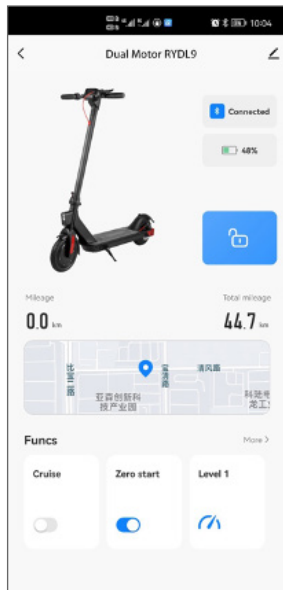

2.2

Select "Remove Device" button at the bottom.

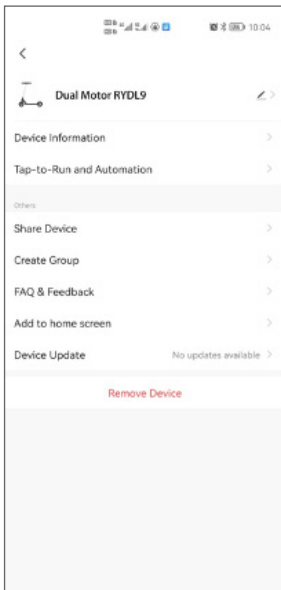

2.3

Lastly, "Disconnect and wipe data" to remove device from the app

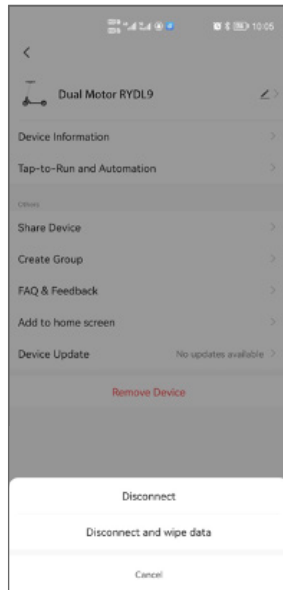

Apple version L9 APP

1.Connect the scooter

1.1

Go to the app store to find Tuya Smart

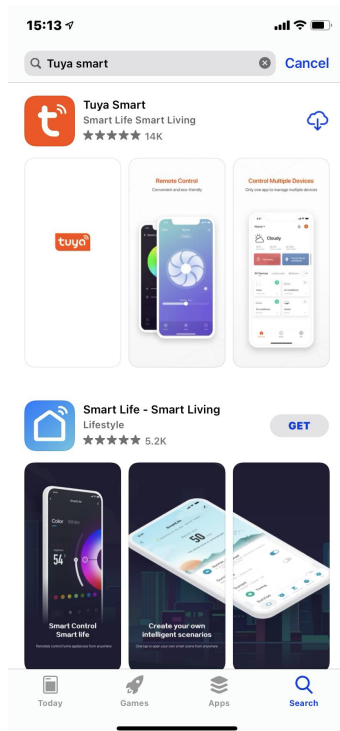

1.2

Open the app and select "Log In"

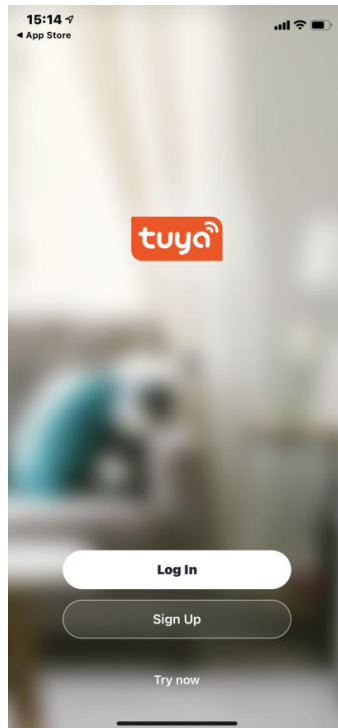

1.3

Then the page will appear "User Agreement and Privacy Policy", and then click agree

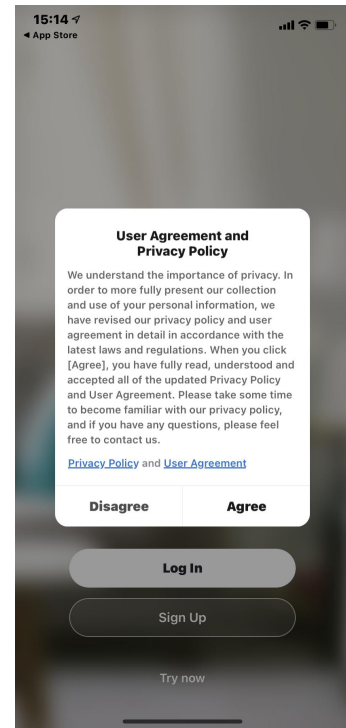

1.4

Click the button on the top right hand corner (+) to add device

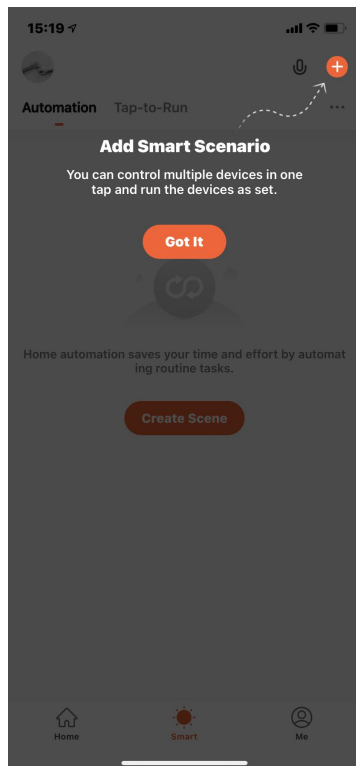

1.5

There are two connection methods, namely manual connection and automatic discovery. Manually as follows: Find the outdoor travel column and click on the scooter

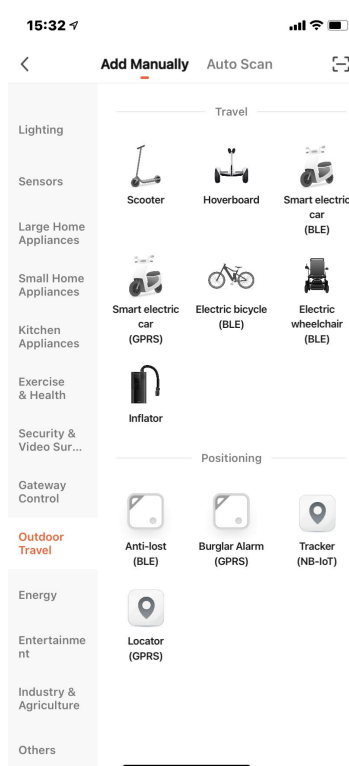

1.6

Click to confirm that the device is in the state of network configuration, waiting for connection

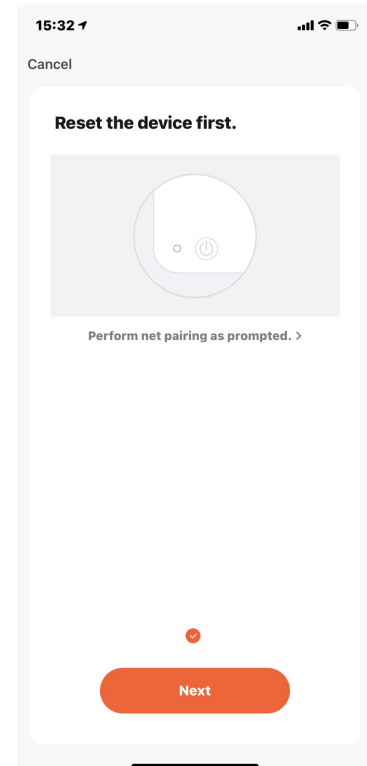

1.7

The automatic discovery is as follows: If Bluetooth is connected, click (+) to enter this page and the connection button will automatically pop up, just click "Go to add"

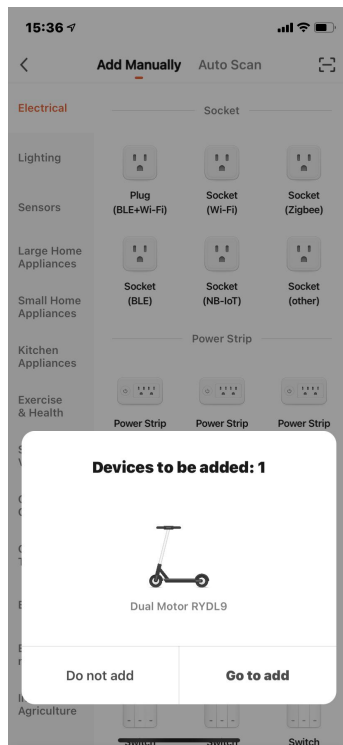

1.8

Lastly click the "Next" and "Done"

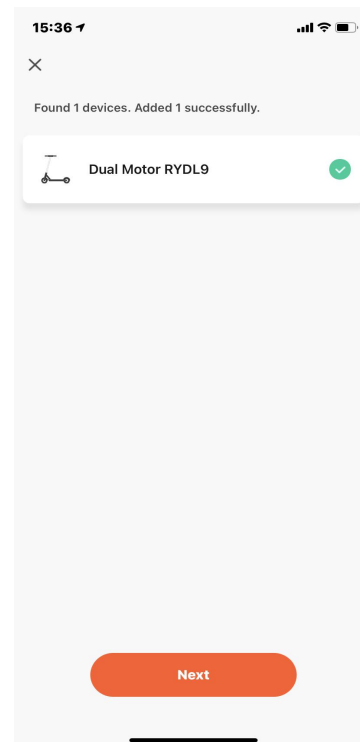

2.Unpair the Scooter

2.1

Select the icon in the upper right corner of the app panel

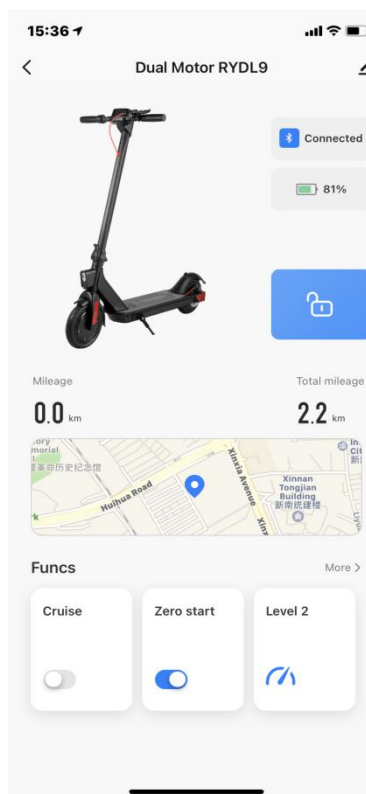

2.2

Lastly, select "Remove Device" button at the bottom, then "Disconnect and wipe data" to remove device from the app

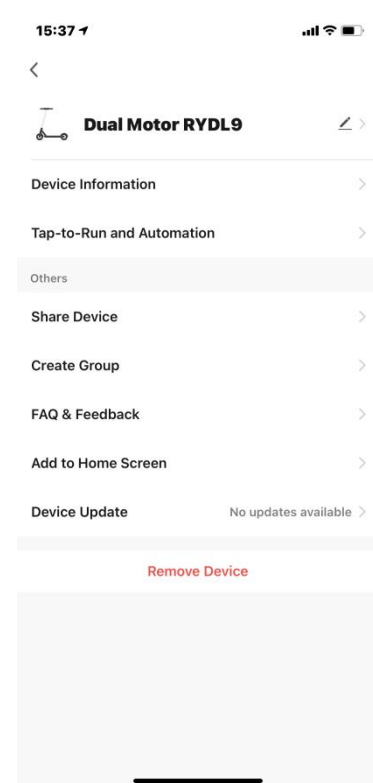

L9

E-scooter

Shenzhen Rulind Electronic Technology Co., Ltd