



## **FOSHAN METRO LINE 2 FLOWER WORLD CUSTOM DECORATIVE CEILING AND WALL SYSTEM PROJECT**



## Project Overview And Architectural Profile

Flower World Station is one of the 'New Eight Sights' in Foshan City. The station's design incorporates the petal and blooming form of the city's flower, the white orchid, providing passengers with a year-round floral viewing experience.

Foshan, located in Guangdong province, China, is renowned for its rich history, vibrant culture, and economic development. As one of the most important cities in the Pearl River Delta region, Foshan is famous for its traditional crafts, particularly ceramics and martial arts. The city has a thriving manufacturing sector, with a focus on electronics, furniture, and textiles. Foshan is also known for its diverse Cantonese cuisine scene. With its blend of tradition and modernity, Foshan is a dynamic city that attracts both business and leisure travelers.

**Project time line:**  
November 2020

**Project Location:**  
Guangzhou and Foshan, China

**Exterior/Interior/Hanging System Products We Offer:**  
Custom Metal Ceiling and Wall System total 4000m<sup>2</sup>

**Application Scope:**  
All Ceiling Suspensions and Metal Wall Panels in this Project

**Services We Offer:**  
Site Measurement and Inspection, Designing Product and Installation Configuration Drawings, Verifying the Feasibility of Drawings with the Project Team, Material Selection and Production, Quality Inspection of Products, Construction Monitoring, and Technical Support.





## Challenge

PRANCE is deeply honored to contribute to the Foshan Urban Rail Transit System. As a company rooted in this city, we take great pride in our involvement. Urban rail transit systems are a reflection of the city, attracting people from various places to experience Foshan firsthand. Being able to contribute to this iconic project in our hometown is both an honor and a source of motivation for our hard work.

The decor style combines modern industrial elements with the regional Flower World, creating a bright, stylish, and highly contemporary space. Flower World Station incorporates decorative elements inspired by the petals and blooming forms of white orchids, providing passengers with a floral appreciation experience. The design showcases custom flower-shaped decorations presented in a luxurious manner. The elegant lines of the extraordinary White Orchid's motif can be observed on the platform's ceiling and columns.



## Solution

The Flower World Station project involves the provision of various supply products. One of the most prominent features is the aluminum panels shaped like white orchid petals. These aluminum panels have a thickness of 3.0mm and are made from AL3003 aluminum material. The floral shape is achieved through carving after material cutting and then bending with a roll-bending arc equipment. The installation design also requires the expertise of PRANCE's technical team.

The ceiling incorporates a floral design achieved through custom perforations to correspond with the wall design. In public areas, the ceiling uses a main-to-secondary transition system with powder-coated aluminum panels, while the walls use adjustable suspended inclined porcelain-coated aluminum panels. The floor is covered with dry-laid, back-glued white ceramic tiles. Furthermore, the custom large square ventilation openings on the ceiling are created by combining white, red, and white sections to achieve a specific effect. The curved mirrored ceiling is produced as a finished product through roll-bending and welding. Our company's strength lies in the integration of technology and production within our factory. We ensure that the design is feasible for construction and production, and we guarantee consistency between design and product to ensure that the design intent perfectly matches the actual outcome.

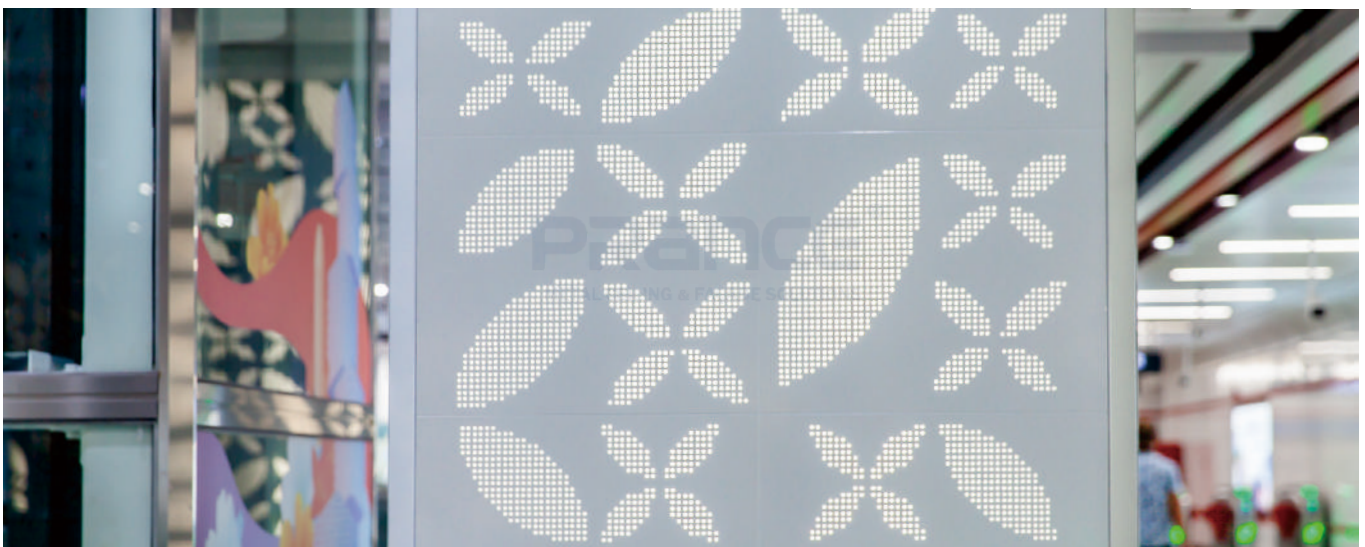



## Partial Drawings And Actual Shooting

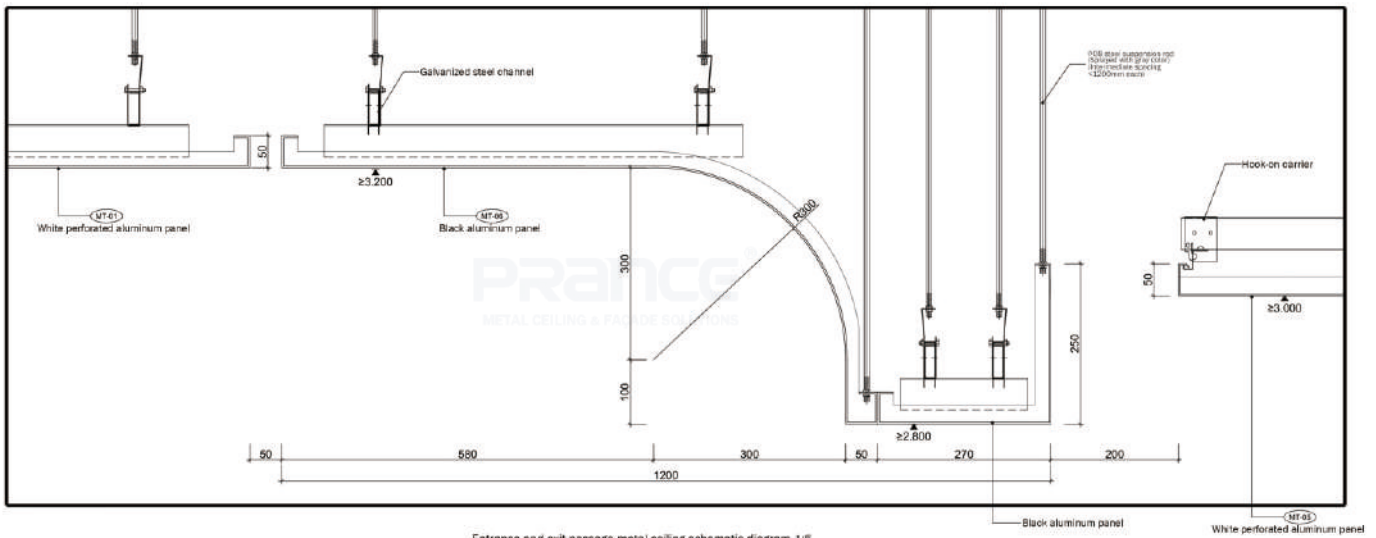

**Note:**

1. The specific dimensions and specifications of each piece of equipment should be based on the dimensions after the tender. The ceiling is not designed for access by personnel. The contractor is responsible for providing detailed drawings that include calculations for the strength, rigidity, and installation methods of ceiling keels, hangers, cross braces, and all connecting components. The large-scale drawings showing interface relationships between ceiling materials and equipment should not be considered the basis for ceiling material installation. The openings in the ceiling should be sprayed with medium gray paint up to the top of the structure.
2. For suspension rods with lengths exceeding 1500mm, reinforce them by adding L40X4 galvanized angle steel welding for fixation and counter-support.
3. All other specialized interface equipment should be positioned within gaps or above the ceiling hanging panels. Avoid making openings in the panels. If there are exceptional circumstances requiring openings, coordinate with the interior design unit to determine the hole locations.
4. Above the finished ceiling surface, comprehensive pipelines, original structural beams, and equipment surfaces should all be coated with medium gray latex paint.





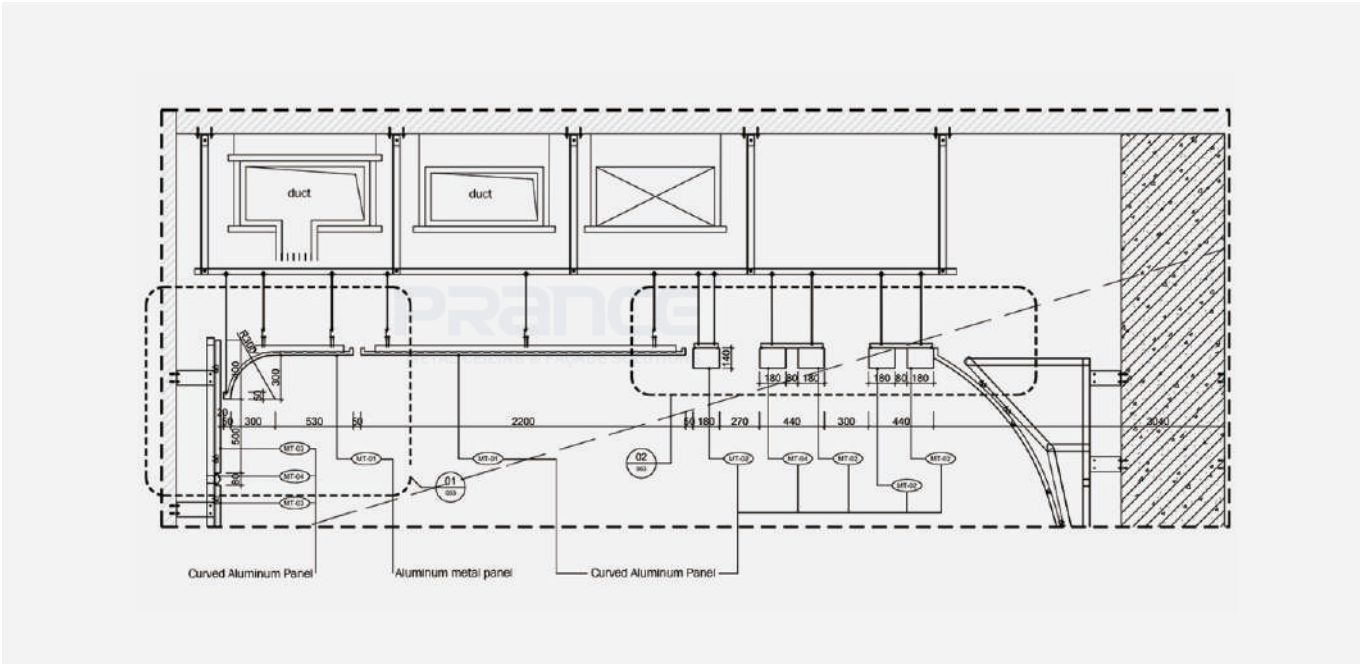



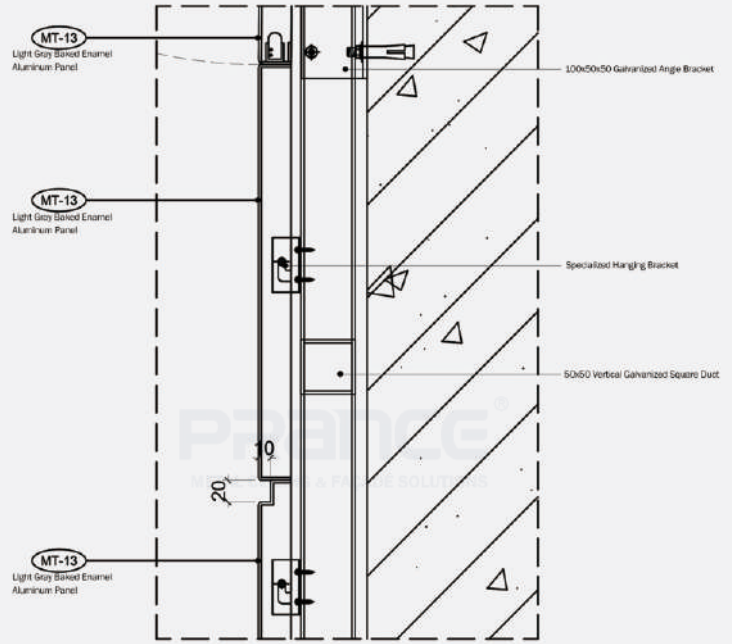
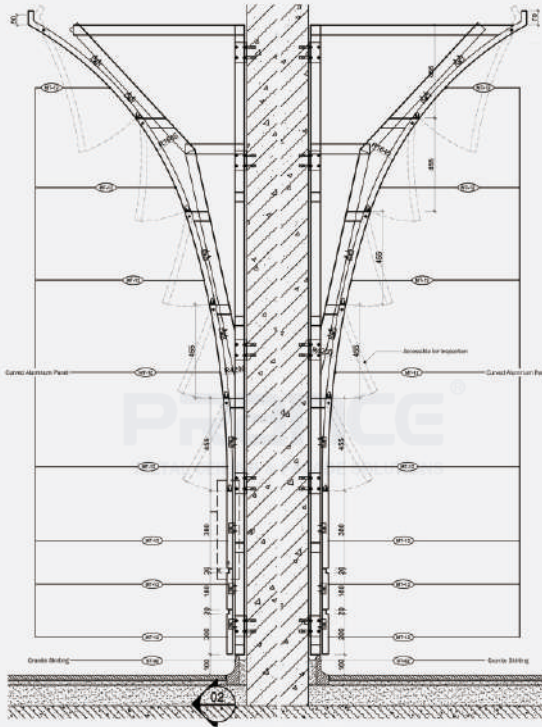

**Column Elevation Drawing 1:5**

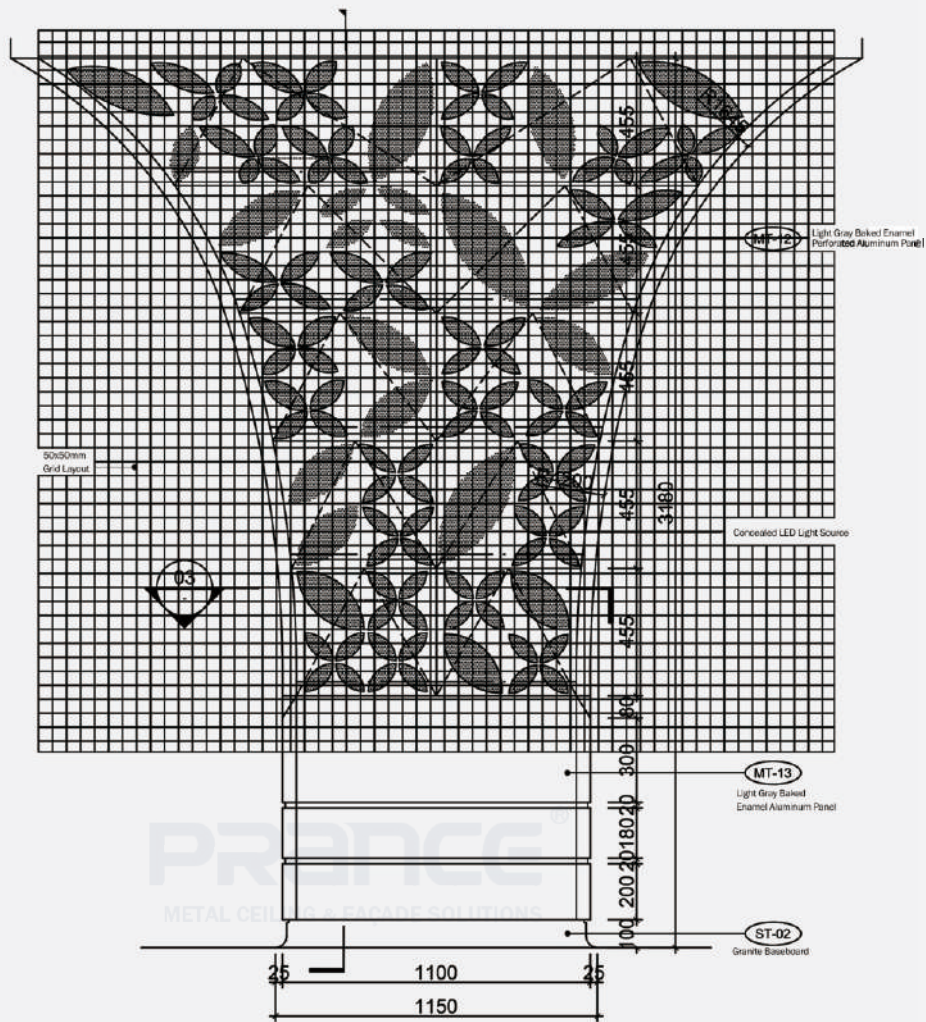

**Column Elevation Drawing 1:20**



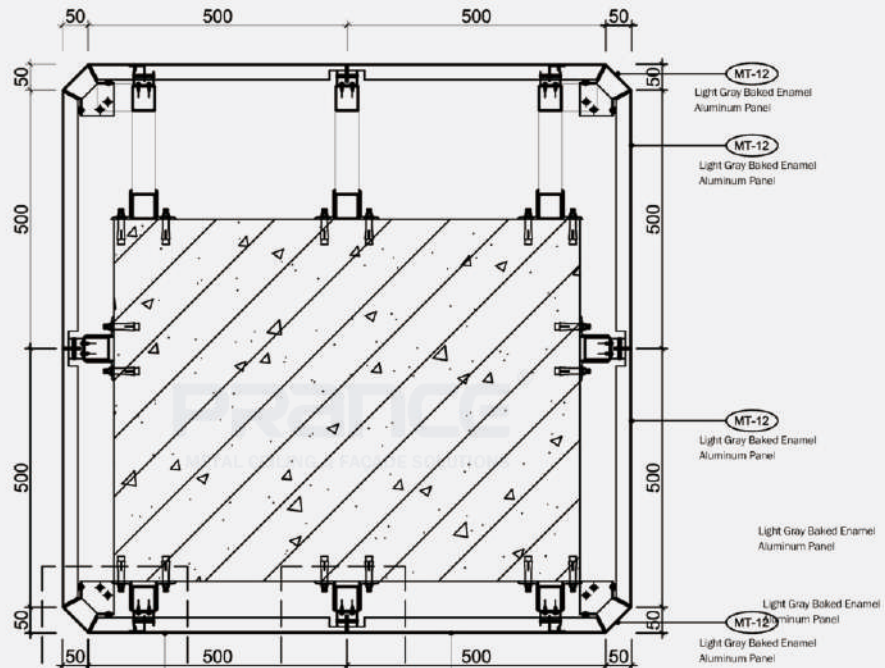

Column Elevation Drawing 1:10

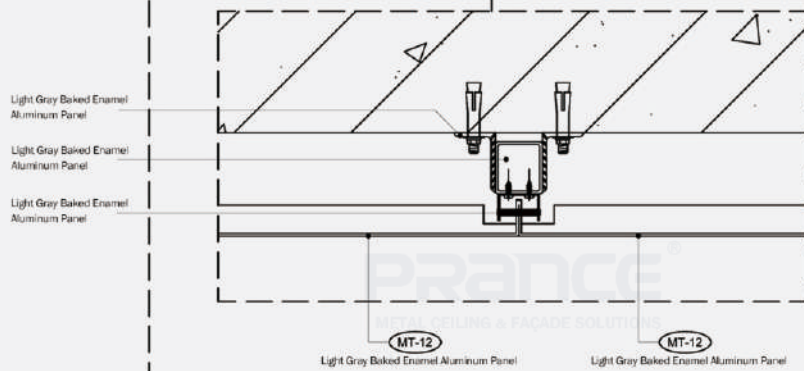

Column Elevation Drawing 1:5

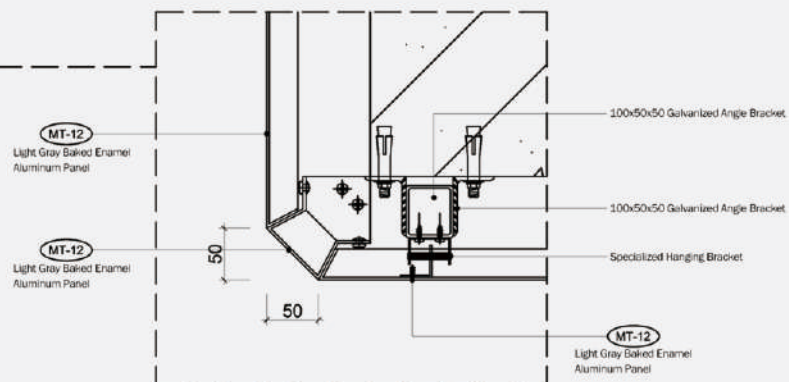

Column Elevation Drawing 1:5



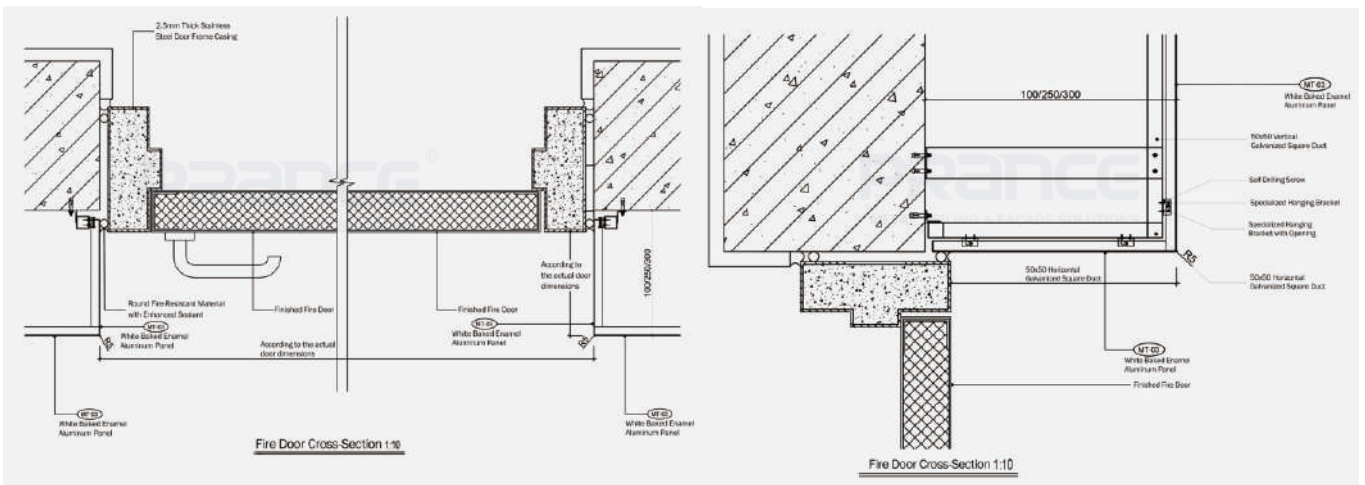
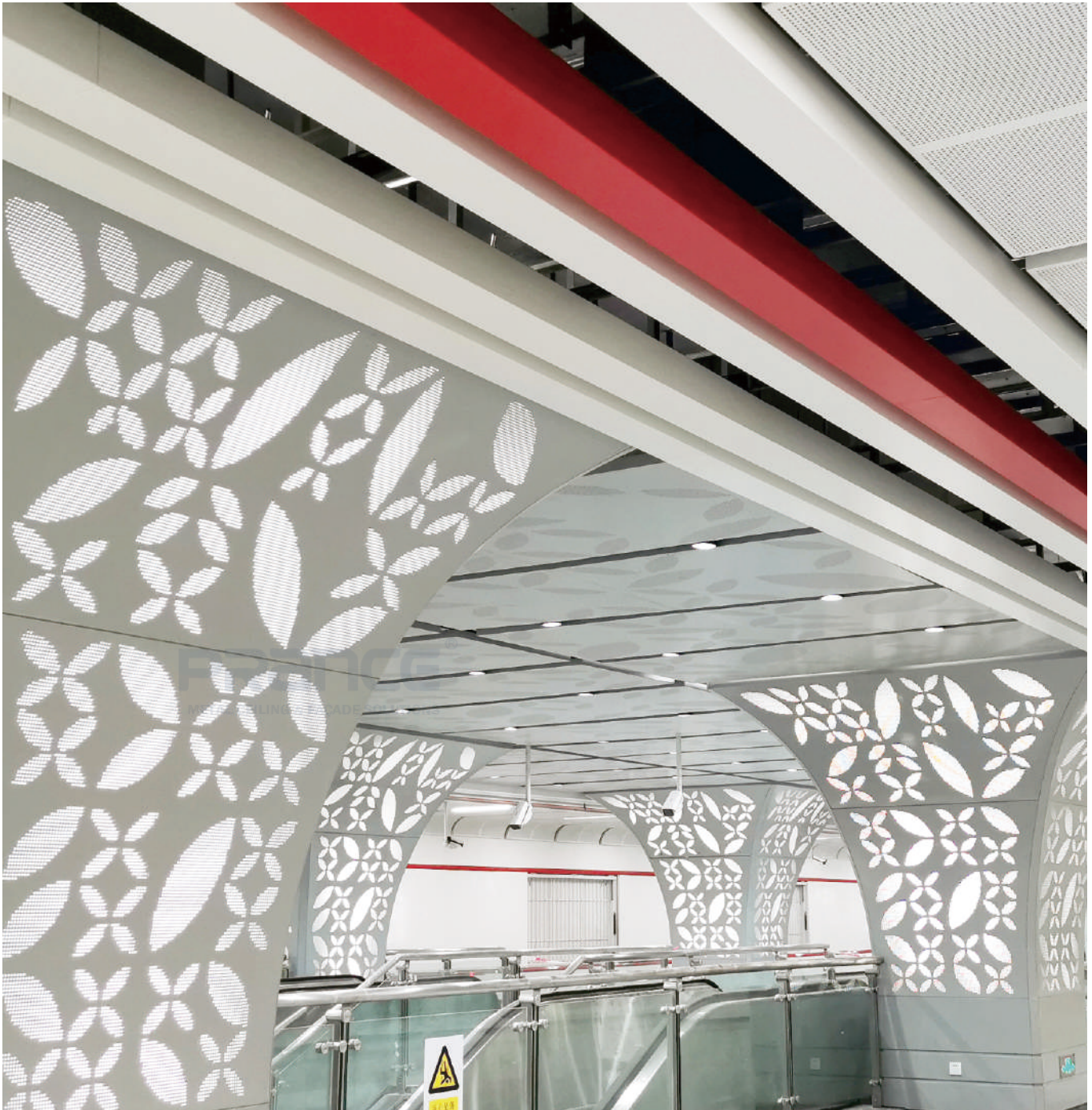



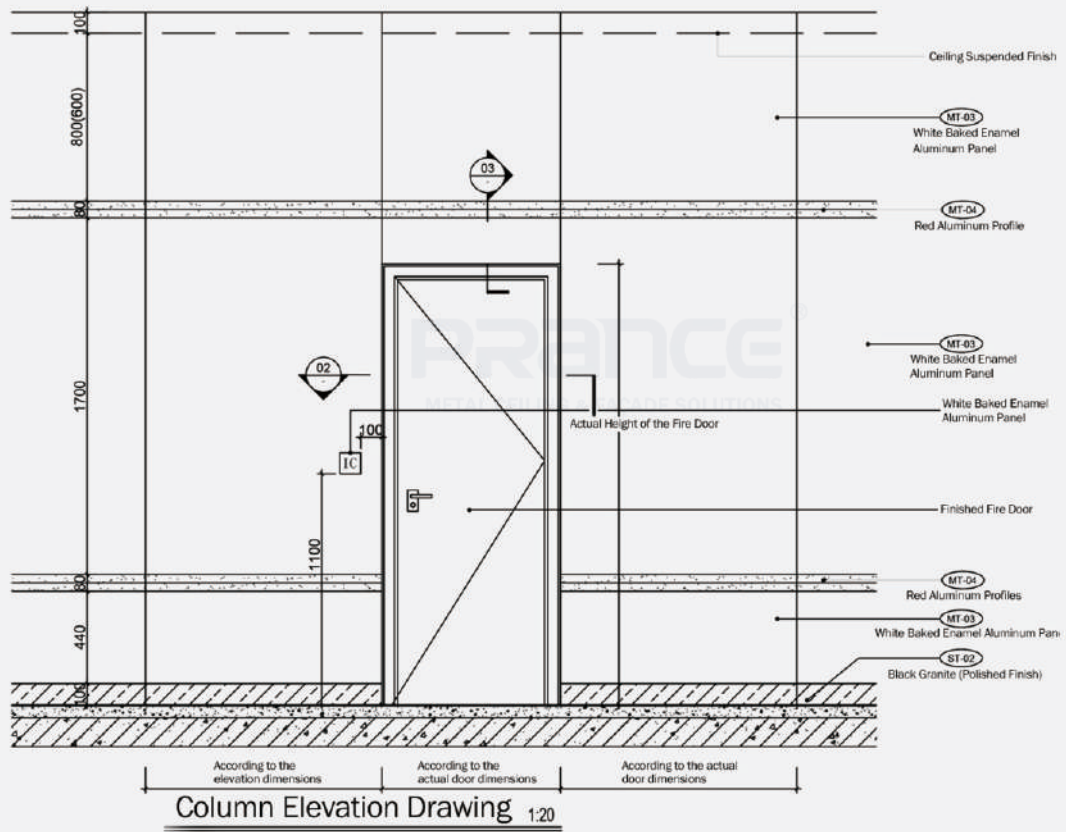



## Product Detailed Information

From PRANCE technical team conducting on-site measurements to the production team's detailed product inspections, PRANCE upholds meticulous management throughout the production process of each panel. From cutting, perforating, shaping, polishing, trial assembly, cleaning, coating, quality inspection, all the way to packaging and transportation, comprehensive and detailed control is maintained to pursue excellence in quality.

Additionally, during the project's execution, PRANCE technical personnel monitor the construction site throughout to provide technical support, ensuring that every step from the conceptual drawings of the product to its actual installation proceeds smoothly, minimizing unexpected issues or oversights.

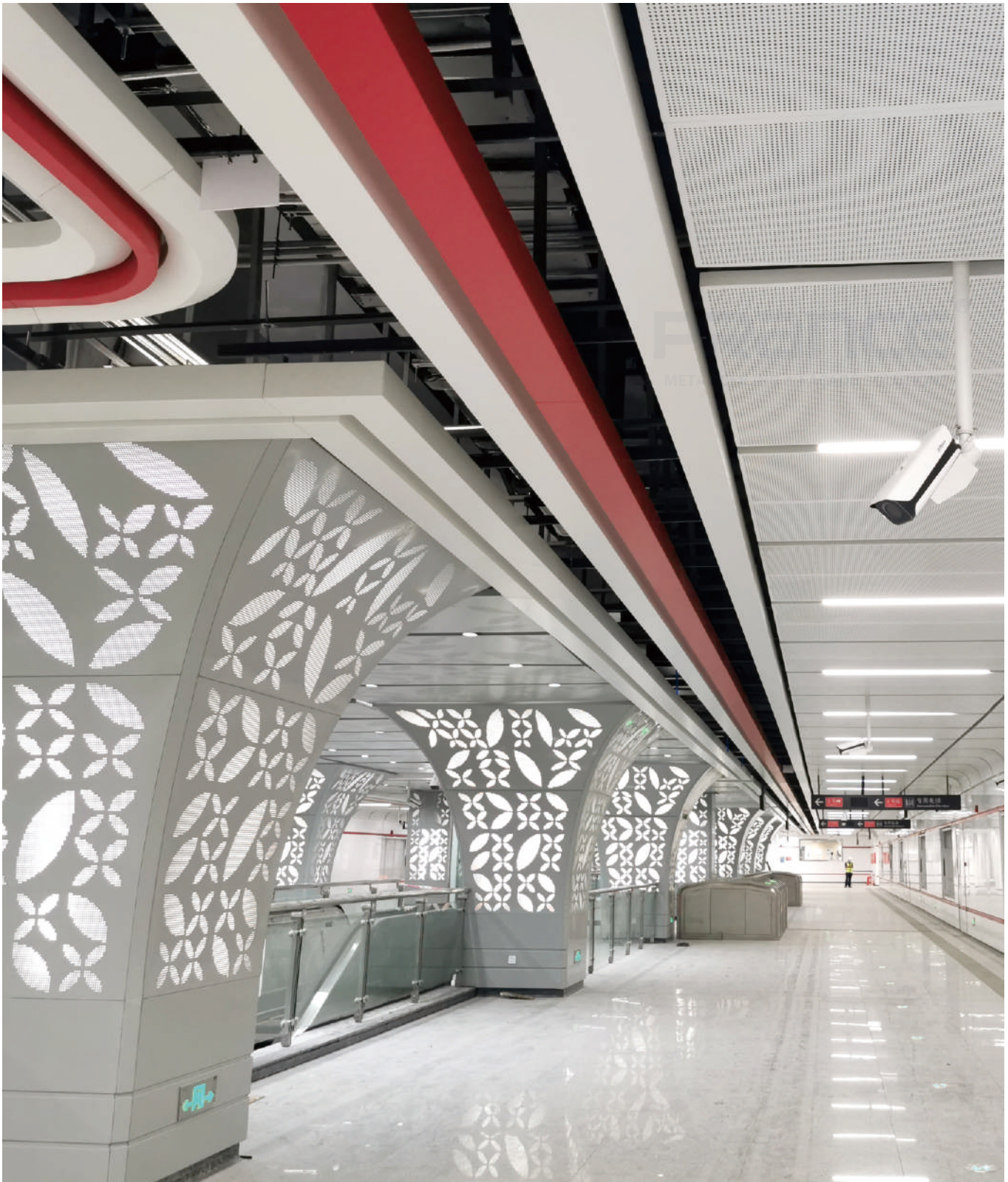





In this project, textured printing technology is utilized for certain sections of the aluminum panels



In this project, certain sections of the aluminum panels feature contour punching process technology



In this project, sculpted pattern aluminum panel assembly technology is employed for specific sections of the aluminum panels



**Project Construction Photography**





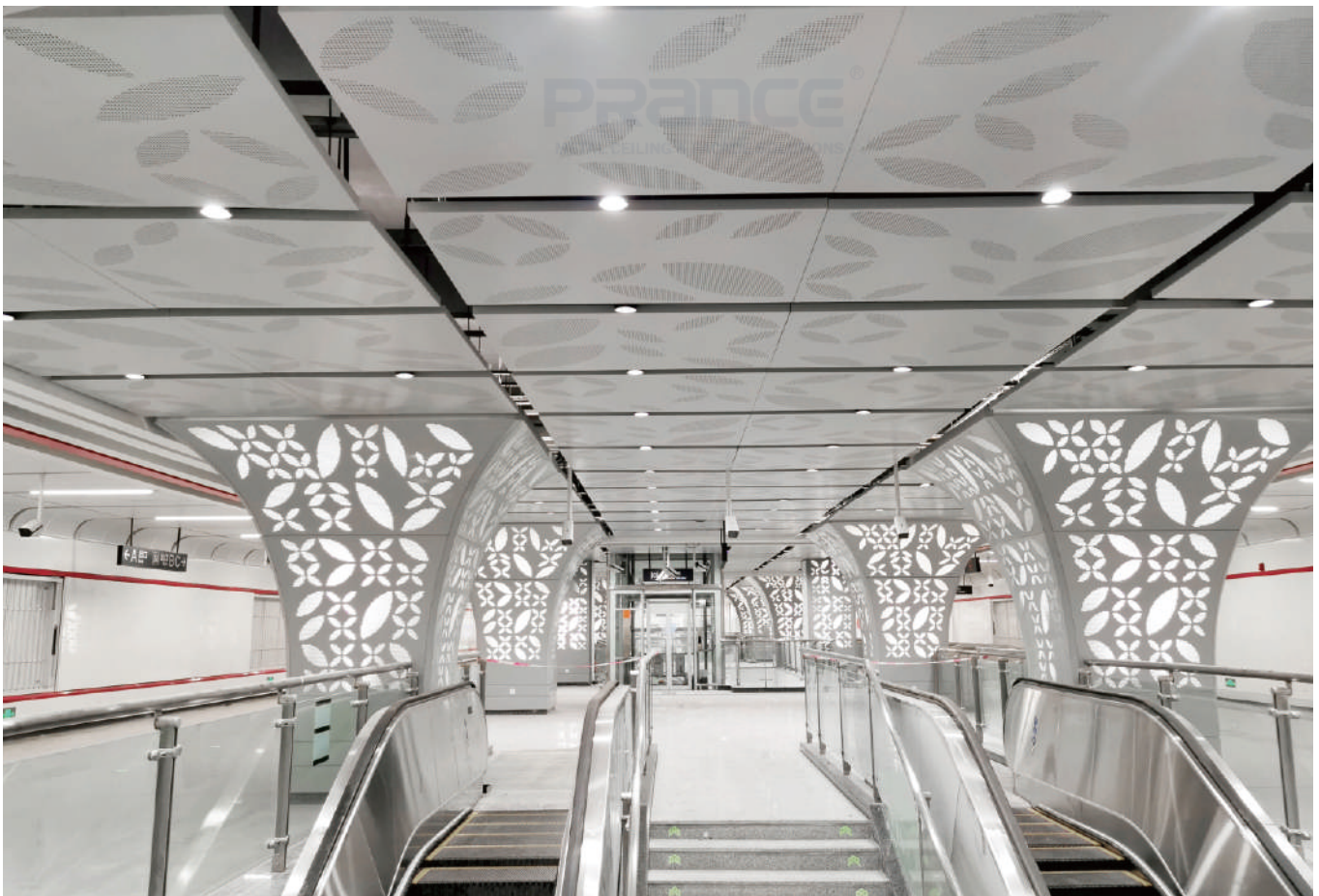



**Final Effect**





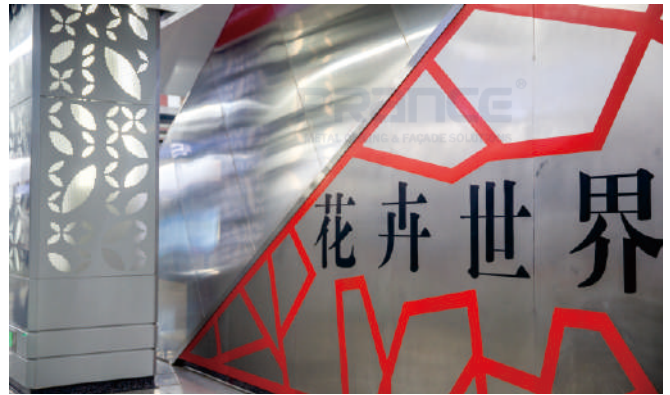











## **PRANCE METALWORK BUILDING MATERIAL CO.,LTD**

Facebook  / LinkedIn  : Prance Metalwork Building Material

Instagram  / YouTube  / Pinterest  : prance\_metalwork

Http: //www.prancebuilding.com      Tel: +86-757-83138155

E-Mail: info@prancebuilding.com      Fax: +86-757-83139722

**Office:** 3F,1st Building,No.11 Gangkou Rd,Chancheng,Foshan,Guangdong.

**Factory:** 169, South Area, Base of Electrical and Electronic Industry,Baini, Sanshui, Foshan, Guangdong.