

LED BEAN POT LIGHT

GE-06006-2*8W-240120-L27K80BL

GREEN EARTH



APPLICATION

LED bean pot light source is energy-saving and environment-friendly, no UV light, widely used in indoor lighting of shopping malls, offices, factories, hospitals, etc.

FEATURES

- * Available Sizes : 240mm*120mm*105mm
- * Different CRI : ≥Ra80, ≥Ra90, ≥Ra94.
- * Light efficacy is more than 85lm/w at ≥Ra80 .
- * Dimmable with most residential wall dimmers.
- * Integrated SMD LED chips, no need for replacement of a bulb.
- * Anodized aluminum construction with a durable copper-free and corrosion-free finish.

Certification

EMC/LVD/RoHS

Warranty

Default is 3 years . 5 Years warranty is optional.

CODE COMPLIANCE

ARRA Compliant. Manufactured and tested to UL standards No. 1598/8750.

SPECIFICATION

Model Number	Input Volt	Power	Luminous Flux	Beam Angle	CCT	Color Rendering	IP	Lifetime
GE-06006	AC220-240V	16W	≥1380LM	—	4000K	≥Ra.80	IP20	50,000 hrs

1 Nominal Source Lumens at 4000K 2 Nominal Delivered Lumens at 4000K 3 Contact Factory for Additional Options

4 See Mounting Page for Details on Components and Finishes 5 Contact Factory for Special Finishes

Actual performance may differ as a result of end-user environment and application. All values are design or typical values,measured under laboratory conditions at 25°C. Specification subject to change without notice.

ORDERING INFORMATION

GE-06006-2*8W-240120-LXXYY27K80BL

Brand	Series	NO.	Power	Size	Voltage	Dim Type	Sensor	CCT	CRI	Finish
GE	06	006	2*8W	240120	L	XX	YY	27K	80	BL
GreenEarth	06: Bean Pot Light	006	16Watt	L:240mm H:120mm	H: High Voltage Direct Drive AC230V L:AC220-240V M:DC24V A:AC100-120V B:AC100-240V C:AC100-277V D:AC85-265V E:AC100-305V F:AC347-480V AD:AC100-120V With Dimmable BD:AC100-120V With Dimmable CD:AC100-120V With Dimmable DD:AC85-265V With Dimmable ED:AC100-305V With Dimmable FD:AC347-480V With Dimmable	TR=Triac DX=DMX DA=DALI LV=0-10V PW=PWM N=None	V=Voice control M=Microwave Radar I=Infrared O=Other N=None	27K=2700K 30K=3000K 35K=3500K 40K=4000K 50K=5000K 57K=5700K 65K=6500K	70=CRI70 80=CRI80 90=CRI90 93=CRI93 95=CRI95 97=CRI97 98=CRI98	WH=White / BL=Black / GD=Gold SL=Silver / MW=Matte White PT=Platinum / BZ=Bronze MB=Matte Black / AO=Anodic Oxidation NI=Nickle / Nিকেলে Plated CR=Chrome/Polished Chrome MS=Matte Silver / OB=Oil Rubbed Bronze WP=White Powder Coated BP=Black Powder Coated SC=SATIN CHROME SP=Silver Powder Coated SN=SATIN NICKEL SS=Stainless Steel / PA=Polished Aluminum PBN=POLISHED BRUSHED NICKLE PBC=POLISHED BRUSHED CHROME BA=BRUSHED Aluminum BN=BRUSHED NICKEL BC=BRUSHED CHROME CC=Custom Color

MECHANICAL DRAWING

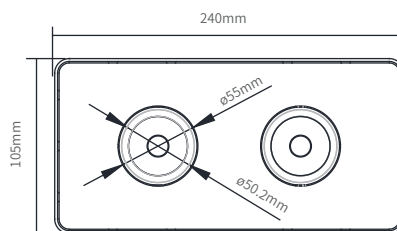
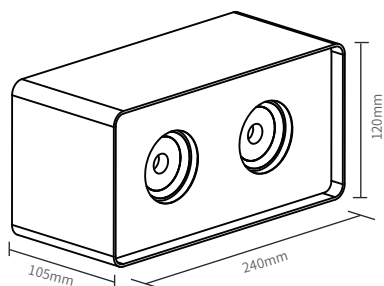

INSTALLATION



Turn off the power

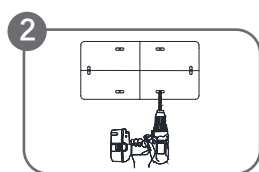

Open the hole on the wall

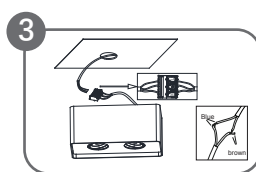

Connect the power cord

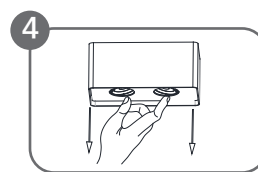

Separate the mask

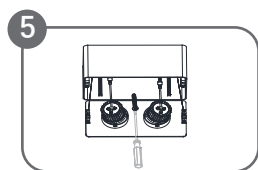

Fix screw

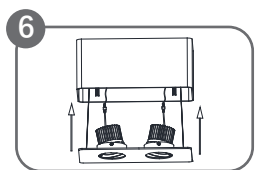

Close the mask

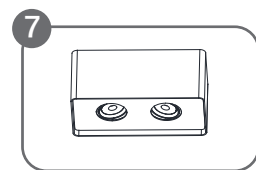

Completed

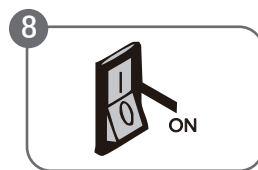

Turn on the power

* Note: when installing the luminaire, it must be determined that the circuit has been disconnected.

PACKAGE

PACKAGE DIMENSION

Item	Size of Carton (L*W*H)(mm/in)	Net Weight/Pcs(kg/lbs)	Gross Weight/Carton(kg/lbs)
GE-06006	510*300*320 / 20.08*11.81*12.60	1.83 / 4.03	12.0 / 26.46

PACKAGE INFORMATION

Item	Qty/Carton	Container(Pcs)		
		20'GP	40'GP	40'HQ
GE-06006	6	3792	7716	8856

1. Installed by professionals, please do not miss or replace the parts of the lamp during installation.
2. Do not get too close to the heating element, in case of dangerous.
3. Do not use chemicals to clean the lamp. Chemicals such as trichloroethylene, acetone etc. may damage the colloidal surface and cause fading.
4. Do not change the structure and parts of the lamp. If any broken, please let professionals to handle of it.